

**Table of Contents**

<b>Section Code</b>	<b>Section</b>	<b>Page Number</b>
1	Important Safety Instructions	2
1	Safety Warning Labels and Serial Number	3
1	Reading the Product Specification Label	3
1	Specifications	3
1	Maintenance	4
1	Battery Replacement	5
1	Seat Roller Adjustment	5
1	Leveling the Machine	5
1	Moving and Storing the Machine	6
1	Maintenance Parts Exploded View	7
1	Troubleshooting	8
1	Replacement Procedure Skill Level	10
	Part Replacement	11
2	Console	11
3	Heart Rate (HR) Receiver	13
4	Pull Handle	16
5	Seat Rail Assembly	18
6	Rear Cover	21
7	RPM Sensor (Count Sensor)	24
8	Seat	26
9	Seat Rollers	29
10	Shrouds	32
11	Stabilizer End Cap	34
12	Stabilizer Foot	36

**NOTICE:** This document provides important safety instructions, adjustments, and general troubleshooting information for the maintenance of the Schwinn™ Crewmaster™/Rower International.

**If you need assistance, please call Schwinn Customer Service (if purchased in US/Canada) or your local distributor (if purchased outside US/Canada). To find your local distributor, go to: [www.nautilusinternational.com](http://www.nautilusinternational.com)**



**This icon means a potentially hazardous situation which, if not avoided, could result in death or serious injury. Read and understand all Warnings on this machine.**

Nautilus, Inc., [www.NautilusInc.com](http://www.NautilusInc.com), 5415 Centerpoint Parkway, Groveport, OH 43125 U.S.A. - Customer Service: North America (800) 605-3369, [csnls@nautilus.com](mailto:csnls@nautilus.com) | outside U.S. [www.nautilusinternational.com](http://www.nautilusinternational.com) | © 2017 Nautilus, Inc. | Schwinn, the Schwinn Quality logo, Crewmaster, and Nautilus are trademarks owned by or licensed to Nautilus, Inc., which are registered or otherwise protected by common law in the United States and other countries. Polar® and OwnCode® are trademarks of their owner. | **ORIGINAL DOCUMENT - ENGLISH VERSION ONLY**

## Important Safety Instructions



**This icon means a potentially hazardous situation which, if not avoided, could result in death or serious injury. Read and understand all Warnings on this machine.**

**Before servicing or using this equipment, obey the following warnings:**



**Read and understand the Service Manual before working on the machine. Failure to obey the instructions and safety warnings could cause injury to the service technician or bystanders.**

- Keep bystanders and children away from the product being serviced at all times.
- Make sure that the repair is done in an appropriate work space away from foot traffic and exposure to bystanders.
- Disconnect all power to the machine before you service it.
- Some components of the equipment can be heavy or awkward. Enlist the service of a second person when you do maintenance steps involving these components. Do not try to do heavy or awkward steps on your own.
- If replacement parts are necessary, use only genuine replacement parts and hardware supplied by Nautilus. Failure to use genuine replacement parts can cause a risk to users, keep the machine from operating correctly and void the warranty.
- Be sure that all warning stickers and instructional placards applied to the product stay present and in good condition when doing maintenance or replacing components. If at any time the Warning labels become loose, unreadable or dislodged, replace the labels. If purchased in US/Canada, contact Customer Service for replacement labels. If purchased outside US/Canada, contact your local distributor for them.
- Do not try to change the design or functionality of the machine being serviced as this can adversely affect user safety.
- Do not put the machine back in service until all shrouds, instructions, warning labels and correct functionality have been verified and tested for correct performance.

## Safety Warning Labels and Serial Numbers

### ⚠ WARNING

- Injury or death is possible if caution is not used while using this machine.
- Keep children and pets away.
- Read and follow all warnings on this machine.
- Refer to the Owner's Manual for additional warnings and safety information.
- The heart rate displayed is an approximation and should be used for reference only.
- Not intended for use by anyone under 14 years of age.
- The maximum user weight for this machine is 300 lbs (136 kg.).
- This machine is for home use only.

(Label is available in English and French Canadian only.)

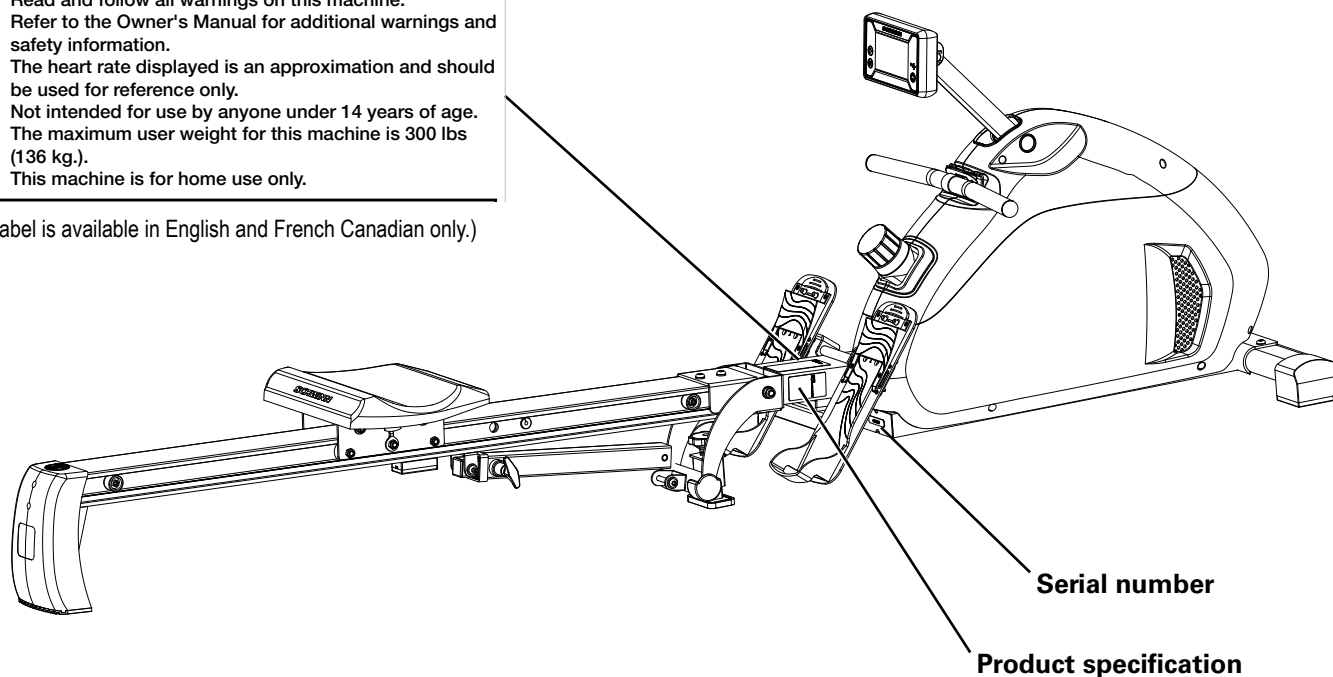

### Reading the Product Specification Decal

The Manufacture Date on the Product Specification Decal is a date code: YY/WW (year/week).

Manufacture Date Code:  
Date De Manufacture: YYWW

## Specifications

**Maximum User Weight:** 136 kg (300 lbs.)

**Machine Weight:** 40.8 kg (90 lbs.)

**Dimensions (flat):** 226.3cm x 53.5cm x 80.5cm (89.1" x 21.1" x 31.7")

**Total Surface Area (footprint) of equipment:** 12,107 cm<sup>2</sup>

**Dimensions (folded):** 129.5cm x 53.5cm x 144.8cm (51" x 21.1" x 57")

**Power Requirements:** 2 AA Alkaline Batteries (UN-3)

Operating Voltage: 3VDC



DO NOT dispose of this product as refuse. This product is to be recycled. For proper disposal of this product, please follow the prescribed methods at an approved waste center.

## FCC Compliance

-  Changes or modifications to this unit not expressly approved by the party responsible for compliance could void the user's authority to operate the equipment.

This product complies with part 15 of the FCC rules. Operation is subject to the following two conditions: (1) This device may not cause harmful interference, and (2) this device must accept any interference received, including interference that may cause undesired operation.

Note: This product has been tested and found to comply with the limits for a Class B digital device, pursuant to CFR47 Part 15 Subpart B of the FCC Rules. These limits are designed to provide reasonable protection against harmful interference in a residential installation. This equipment generates radio frequency energy and, if not installed and used in accordance with the instructions, may cause harmful interference to radio communications.

However, there is no guarantee that interference will not occur in a particular installation. In the unlikely event that this equipment does cause harmful interference to radio or television reception, which can be determined by turning the equipment off and on, the user is encouraged to try to correct the interference by one or more of the following measures:

- Reorient or relocate the receiving antenna.
- Increase the separation between the equipment and receiver.
- Consult the dealer or an experienced radio/TV technician for help.

## Maintenance

Read all maintenance instructions fully before you start any repair work. In some conditions, an assistant is required to do the necessary tasks.

-  **Equipment must be regularly examined for damage and repairs. The owner is responsible to make sure that regular maintenance is done. Worn or damaged components must be repaired or replaced immediately. Only manufacturer supplied components can be used to maintain and repair the equipment.**

**If at any time the Warning labels become loose, unreadable or dislodged, replace the labels. If purchased in US/Canada, contact Customer Service for replacement labels. If purchased outside US/Canada, contact your local distributor for them.**

**Disconnect all power to the machine before you service it.**

**Daily:** Before each use, examine the exercise machine for loose, broken, damaged, or worn parts. Do not use if found in this condition. Repair or replace all parts at the first sign of wear or damage. After each workout, use a damp cloth to wipe your machine and Console free of moisture.

**Note:** Avoid excessive moisture on the Console.

**Weekly:** Clean the machine to remove any dust, dirt, or grime from the surfaces. Check for smooth seat operation. If needed, sparingly apply a thin coating of silicone lube to the Seat Rail to ease operation.

-  **Silicone lubricant is not intended for human consumption. Keep out of reach of children. Store in a safe place.**

**Note:** Do not use petroleum based products.

**NOTICE:** If necessary, only use a mild dish soap with a soft cloth to clean the Console. Do not clean with a petroleum based solvent, automotive cleaner, or any product that contains ammonia. Do not clean the Console in direct sunlight or at high temperatures. Be sure to keep the Console free of moisture.

**Monthly or after 20 hours:** Check foot plate, seat and pull strap. Make sure all bolts and screws are tight. Tighten as necessary. Check pull strap and seat rollers for signs of wear.

## Replacing the Console Batteries

When the batteries are low on power, the console display contrast will dim.

When replacing the batteries, make sure the batteries point in the +/- direction shown in the battery bay.

**Note:** The console uses AA size alkaline batteries (UN-3)



**Do not mix old and new batteries.**

**Do not mix alkaline, standard (carbon-zinc), or rechargeable (Ni-Cd, Ni-MH, etc) batteries.**

Be sure to remove the batteries to prevent corrosion damage if you are not going to use the machine for an extended period of time.

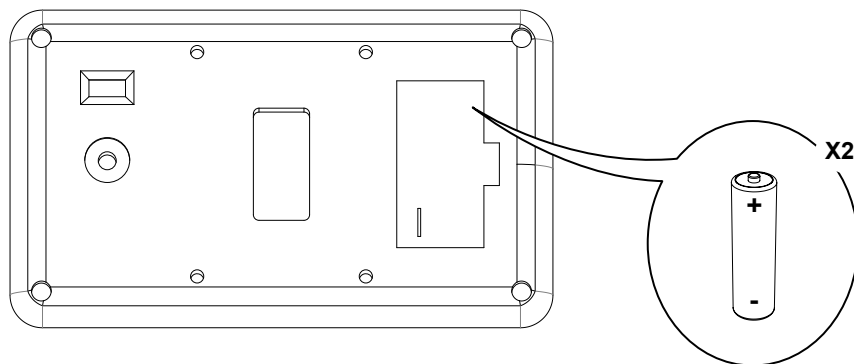

## Adjusting the Seat Rollers

If the machine is level but the seat rolls unevenly, check the seat roller assembly under the seat. To adjust the seat rollers, turn the adjustment nuts (O2).



**Do not adjust the nuts to such a height that they detach or the seat roller assembly becomes unstable.**

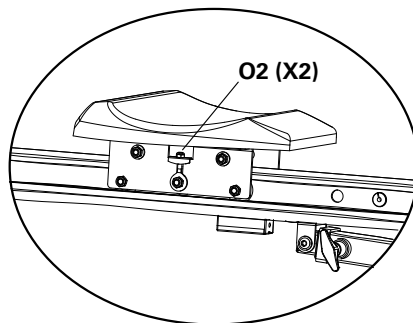

## Leveling the Machine

The machine needs to be leveled if your workout area is uneven. The Level Adjustment Knob is below the junction of the Seat Rail Assembly and the Main Unit. To adjust:

1. Place the machine in your workout area.
2. Turn the Level Adjustment Knob (J) to adjust until the Seat Rail Locking Pin (M) engages securely.



**Do not adjust the knob to such a height that it becomes unstable. Injury to you or damage to the machine can occur.**

Make sure the machine is level and stable before you exercise.

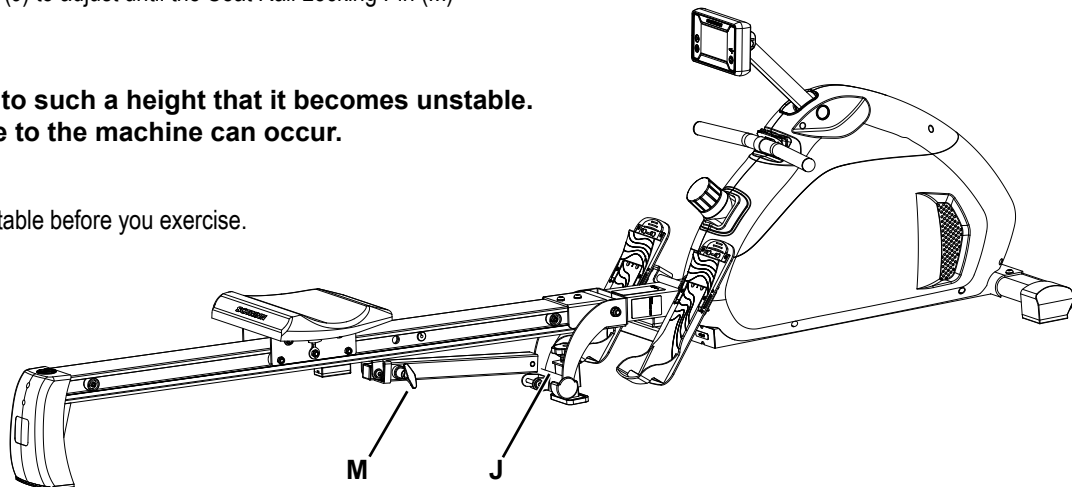

## Moving and Storing the Machine

When the machine is not in use, it should be stored in an appropriate space away from foot traffic. To conserve space, you may fold the Seat Rail Assembly and secure it with the Seat Rail Locking Pin.

**⚠ For safe storage of the machine, remove the batteries. Place the machine in a secure location away from children and pets.**

1. Move the Seat to the front of the Seat Rail.
2. Pull the Seat Rail Locking Pin (M) to release and raise the Seat Rail Assembly to the folded position. Make sure that you have a secure grip when raising the Seat Rail Assembly.

**⚠ Stay clear of the movement path of the Seat Rail Assembly.**

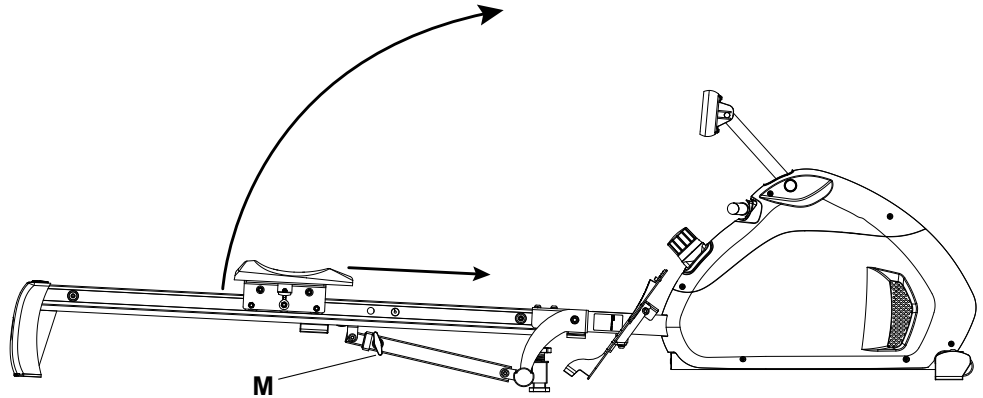

3. Release the Seat Rail Locking Pin to engage the support tube. You will hear an audible clicking noise. Be sure that the Seat Rail Locking Pin is fully engaged. If it is not fully engaged, injury to the user can occur.

**⚠ The machine may be moved by one or more persons depending on their physical abilities and capacities. Make sure that you and others are all physically fit and able to move the machine safely. Use proper safety precautions and lifting techniques.**

4. Grasp one of the curved Support Plates (V) and the Lift Handle (L). Carefully tilt the machine onto the Transport Rollers (F).
5. Holding the Lift Handle (L), push the machine into position.

**NOTICE:** Be careful when you move the machine. Abrupt motions can affect the computer operation.

6. Carefully lower the machine to the floor and do not let it drop from any height.

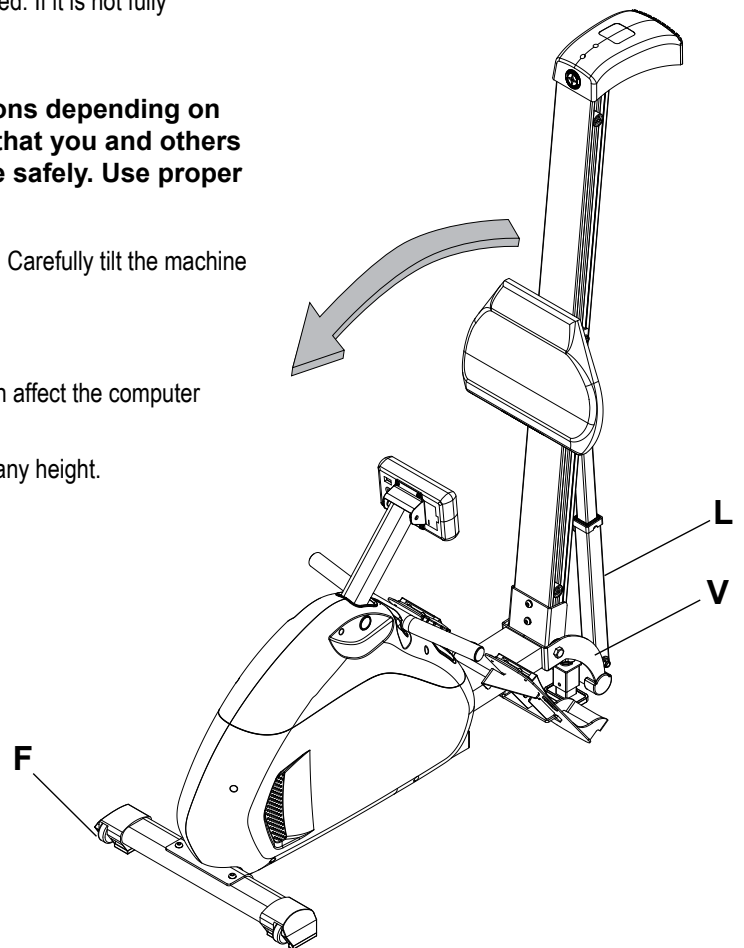

## Maintenance Parts

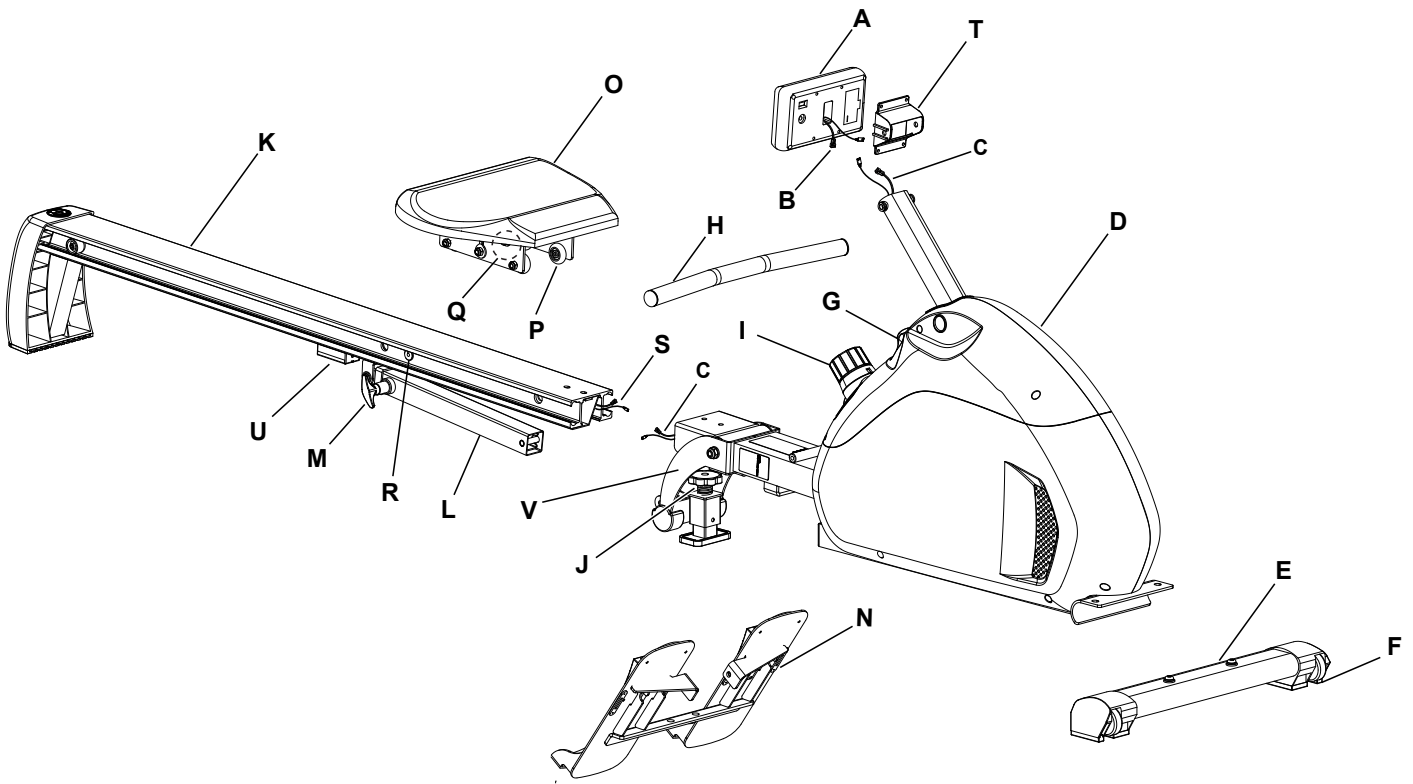

A	Console	L	Storage Support Tube (Lift Handle)
B	Console cables	M	Seat Rail Locking Pin
C	Data Cables, Main Unit	N	Foot Plate
D	Rower engine	O	Seat Assembly
E	Stabilizer, Front	P	Seat Rollers
F	Transport Wheel	Q	RPM Sensor Magnet
G	Pull Strap	R	RPM Sensor Assembly
H	Handle	S	Data Cables, Seat Rail
I	Resistance Adjustment Knob	T	Console Bracket
J	Level Adjustment Knob	U	Telemetric Heart Rate (HR) Receiver
K	Seat Rail Assembly	V	Support Plates

## Troubleshooting

Condition/Problem	Things to Check	Solution
Console will not power up/turn on/start	Check batteries.	Make sure batteries are installed correctly. If batteries are correctly installed, replace with a set of new batteries.
	Check data cable integrity	All wires in cable should be intact. If any are visibly crimped or cut, replace cable.
	Check data cable connections/ orientation	Make sure cable is connected securely and oriented properly. Small latch on connector should line up and snap into place.
	Check console display for damage	Check for visual sign that console display is cracked or otherwise damaged. Replace Console if damaged.
		If the above steps do not resolve the problem, contact Customer Service (if inside US/Canada) or your local distributor (if outside US/Canada).
Speed displayed is not accurate	Check RPM Sensor Magnet position (requires seat removal)	RPM Sensor Magnet should be in place on Seat slider frame.
Speed displayed is always "0"/ stuck in Pause mode	Data cable	Make sure the data cable is connected to the back of the Console and the main frame assembly.
	RPM Sensor	Make sure the RPM Sensor Magnet and the RPM Sensor are in place.
No Count/RPM reading	Check data cable integrity	All wires in cable should be intact. If any are cut or crimped, replace cable.
	Check data cable connections/ orientation	Be sure cable is connected securely and oriented properly. Small latch on connector should line up and snap into place.
	Check RPM Sensor Magnet position (requires seat removal)	RPM Sensor Magnet should be in place on Seat slider frame.
	Check seat position	Be sure the seat is installed with the Schwinn™ name pointing away from the rower engine, so that the RPM Sensor Magnet is on the correct side.
	Check RPM Sensor Assembly	RPM Sensor Assembly should be aligned with magnets and connected to data cable. Realign sensor if necessary. Replace if there is any damage to the sensor or the connecting wire.
Console display is dim	Batteries	Replace batteries
Unit operates but Telemetric Heart Rate not displayed	Chest Strap (optional)	Strap should be "POLAR®" compatible and uncoded. Make sure strap is directly against skin and contact area is wet.
	Chest Strap Batteries	If strap has replaceable batteries, install new batteries.
	Interference	Try moving unit away from sources of interference (TV, Microwave, etc).
	Replace Chest Strap	If interference is eliminated and HR does not function, replace strap.
	Replace Console	If HR still does not function, replace Console.
Console shuts off (enters sleep mode) while in use	Check data cable integrity	All wires in the cable should be intact. If any are cut or crimped, replace cable.
	Check data cable connections/ orientation	Be sure cable is connected securely and oriented properly. Small latch on connector should line up and snap into place.
	Check batteries.	Make sure batteries are installed correctly. If batteries are correctly installed, replace with a set of new batteries.
	Check RPM Sensor Magnet position (requires seat removal)	RPM Sensor Magnet should be in place on Seat slider frame.
	Check RPM Sensor Assembly	RPM Sensor Assembly should be aligned with magnet and connected to data cable. Realign sensor if necessary. Replace if there is any damage to the sensor or the connecting wire.
		Contact Customer Service (if inside US/Canada) or your local distributor (if outside US/Canada).
Unit rocks/does not sit level	Check level adjustment	Level adjustment knob may be turned to level machine.
	Check surface under unit	Adjustment may not be able to compensate for extremely uneven surfaces. Move machine to level area.



Condition/Problem	Things to Check	Solution
Seat Rail locking pin does not engage (rail in horizontal position)	Level adjustment knob	Turn the level adjustment knob until the Seat Rail locking pin engages the support tube.
Seat rolls unevenly	Seat roller adjustment hardware	Turn the adjustment nuts under the seat to adjust the seat rollers.

## REPLACEMENT PROCEDURE SKILL LEVEL

Level I :	Low - very little mechanical knowledge or exposure.
Level II :	Intermediate - some experience with mechanical procedures
Level III :	Advanced - knowledgeable about mechanical procedures



**Disconnect all power to the machine before you service it.**

**The Rower Engine components are not serviceable by consumers.**

**When disposing of old parts, obey the applicable local and provincial requirements.**

For instructions to replace the following parts, please refer to the Assembly Manual for your machine:

- Front Stabilizer
- Foot Plate

**NOTICE:** This document provides instructions for the replacement of the Console on the Schwinn™ Crewmaster™/Rower International.

**If you need assistance, please call Schwinn Customer Service (if purchased in US/Canada) or your local distributor (if purchased outside US/Canada). To find your local distributor, go to: [www.nautilusinternational.com](http://www.nautilusinternational.com)**

**⚠ This icon means a potentially hazardous situation which, if not avoided, could result in death or serious injury. Read and understand all Warnings on this machine.**

Nautilus, Inc., [www.NautilusInc.com](http://www.NautilusInc.com), 5415 Centerpoint Parkway, Groveport, OH 43125 U.S.A. - Customer Service: North America (800) 605-3369, [csnls@nautilus.com](mailto:csnls@nautilus.com) | outside U.S. [www.nautilusinternational.com](http://www.nautilusinternational.com) | © 2017 Nautilus, Inc. | Schwinn, the Schwinn Quality logo, Crewmaster, and Nautilus are trademarks owned by or licensed to Nautilus, Inc., which are registered or otherwise protected by common law in the United States and other countries. | **ORIGINAL DOCUMENT - ENGLISH VERSION ONLY**

## **Important Safety Instructions - Before servicing or using this equipment, obey the following warnings:**

**⚠ Disconnect all power to the machine before you service it.**

- Read and understand the Part Replacement Procedure before working on the machine. Failure to obey the instructions and safety warnings could cause injury to the service technician or bystanders.
- Keep bystanders and children away from the product being serviced at all times.
- Make sure that the repair is done in an appropriate work space away from foot traffic and exposure to bystanders.
- Some components of the equipment can be heavy or awkward. Enlist the service of a second person when you do maintenance steps involving these components. Do not try to do heavy or awkward steps on your own.
- If replacement parts are necessary, use only genuine Nautilus replacement parts and hardware. Failure to use genuine replacement parts can cause a risk to users, keep the machine from operating correctly and void the warranty.
- Be sure that all warning stickers and instructional placards applied to the product stay present and in good condition when doing maintenance or replacing components. If at any time the Warning labels become loose, unreadable or dislodged, replace the labels. If purchased in US/Canada, contact Customer Service for replacement labels. If purchased outside US/Canada, contact your local distributor for them.
- Do not try to change the design or functionality of the machine being serviced as this can adversely affect user safety.
- Do not use the machine until all shrouds, instructions, warning labels and correct functionality have been verified and tested for correct performance.

### **Tools Required (not included)**

#2 Phillips screwdriver



13mm open end wrench



**Note:** Your machine may not match the image. For reference only.

1. Remove hardware (indicated) that attaches Console to the Mast. Carefully lift the Console off the Mast. Set the hardware safely aside for reassembly.

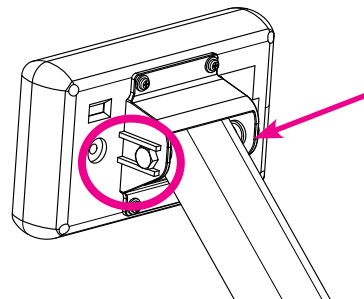

2. Disconnect the Data Cable and Heart Rate Cable from the back of the Console.

**Note:** Do not let the cables fall down inside the Mast. This step may require two people.

3. Remove screws that attach Console to the Console Bracket. Carefully remove the Console Bracket and set it safely aside. Discard the Console and screws.

**NOTICE:** Do not crimp the cables.

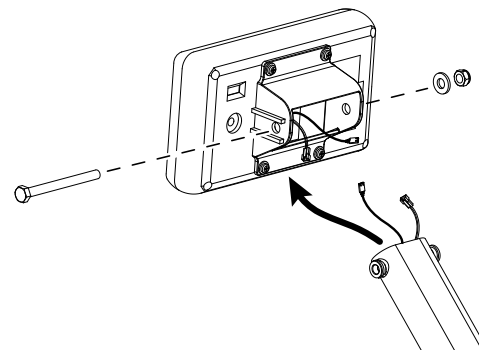

4. Installation is the reverse procedure.

**Note:** Be sure the 2 ribs on the Console Bracket are on the right side so that the opening points downward. Insert the bolt through the hole between the ribs so that the flat sides of the bolt head are aligned with the ribst.

**NOTICE:** Do not crimp the cables.

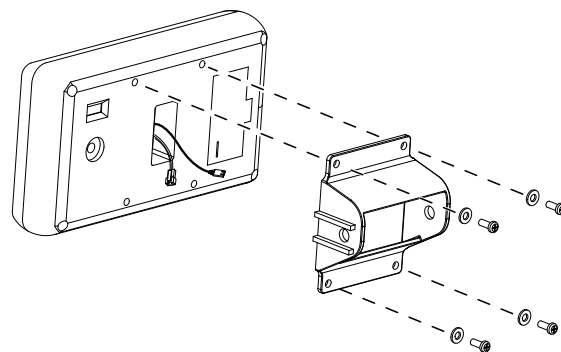

5. Inspect your machine to ensure that all hardware is tight and components are properly assembled.

**!** Do not use until the machine has been fully assembled and inspected for correct performance in accordance with the Owner's Manual.

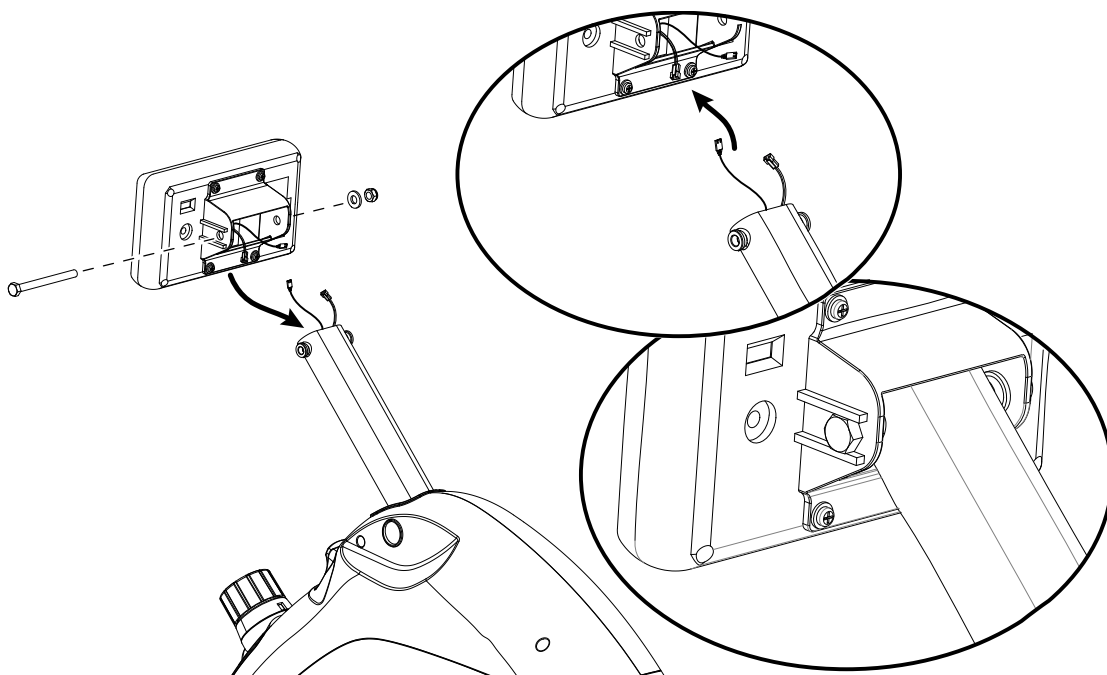

**NOTICE:** This document provides instructions for the replacement of the telemetric Heart Rate (HR) Receiver on the Schwinn™ Crewmaster™/Rower International.

**If you need assistance, please call Schwinn Customer Service (if purchased in US/Canada) or your local distributor (if purchased outside US/Canada). To find your local distributor, go to: [www.nautilusinternational.com](http://www.nautilusinternational.com)**

**⚠ This icon means a potentially hazardous situation which, if not avoided, could result in death or serious injury. Read and understand all Warnings on this machine.**

Nautilus, Inc., [www.NautilusInc.com](http://www.NautilusInc.com), 5415 Centerpoint Parkway, Groveport, OH 43125 U.S.A. - Customer Service: North America (800) 605-3369, [csnls@nautilus.com](mailto:csnls@nautilus.com) | outside U.S. [www.nautilusinternational.com](http://www.nautilusinternational.com) | © 2017 Nautilus, Inc. | Schwinn, the Schwinn Quality logo, Crewmaster, and Nautilus are trademarks owned by or licensed to Nautilus, Inc., which are registered or otherwise protected by common law in the United States and other countries. | **ORIGINAL DOCUMENT - ENGLISH VERSION ONLY**

## **Important Safety Instructions - Before servicing or using this equipment, obey the following warnings:**

**⚠ Disconnect all power to the machine before you service it.**

- Read and understand the Part Replacement Procedure before working on the machine. Failure to obey the instructions and safety warnings could cause injury to the service technician or bystanders.
- Keep bystanders and children away from the product being serviced at all times.
- Make sure that the repair is done in an appropriate work space away from foot traffic and exposure to bystanders.
- Some components of the equipment can be heavy or awkward. Enlist the service of a second person when you do maintenance steps involving these components. Do not try to do heavy or awkward steps on your own.
- If replacement parts are necessary, use only genuine Nautilus replacement parts and hardware. Failure to use genuine replacement parts can cause a risk to users, keep the machine from operating correctly and void the warranty.
- Be sure that all warning stickers and instructional placards applied to the product stay present and in good condition when doing maintenance or replacing components. If at any time the Warning labels become loose, unreadable or dislodged, replace the labels. If purchased in US/Canada, contact Customer Service for replacement labels. If purchased outside US/Canada, contact your local distributor for them.
- Do not try to change the design or functionality of the machine being serviced as this can adversely affect user safety.
- Do not use the machine until all shrouds, instructions, warning labels and correct functionality have been verified and tested for correct performance.

### **Tools Required (not included)**

#0 Phillips screwdriver



String/cable, 5' (152cm) or longer



**Note:** Your machine may not match the image. For reference only.

1. Move the Seat to the front of the Seat Rail.
2. Pull the Seat Rail Locking Pin (M) to release and raise the Seat Rail Assembly to the folded position. Make sure that you have a secure grip when raising the Seat Rail Assembly.

**!** **Stay clear of the movement path of the Seat Rail Assembly.**

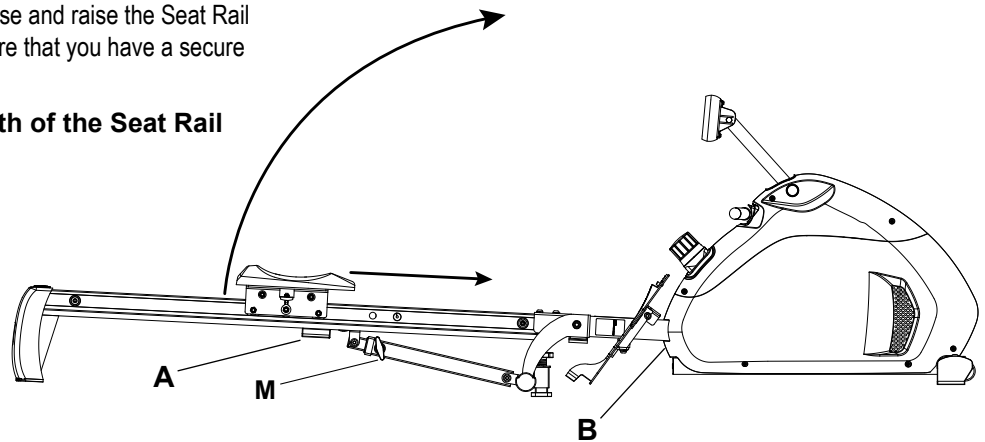

3. Release the Seat Rail Locking Pin (M) to engage the support tube. You will hear an audible clicking noise. Be sure that the Seat Rail Locking Pin is fully engaged. If it is not fully engaged, injury to the user can occur.

4. Observe the cable routing from the Heart Rate (HR) Receiver (A) to the cables from the Rower Engine (B) on your machine. Carefully disconnect the HR Receiver cables (C).

*NOTICE:* Do not crimp any cables.

Tie a string to the end of the cable from the HR Receiver.



5. Remove the screw (A1) that attaches the HR Receiver cover (A2) to the HR Receiver case (A3). Slide the cover toward the back of the Seat Rail Assembly, remove the cover, and discard it.

6. Remove the screws (A4) that attach the HR Receiver case (A3) to the Seat Rail Assembly. Carefully remove the old HR Receiver and pull the cable and string through the Seat Rail Assembly so that the string extends through the Seat Rail Assembly and the Grommet (D). Untie the string from the old cable and discard the old HR Receiver.

**Note:** It may be necessary to remove the Grommet from the opening in the Seat Rail Assembly.

7. Remove the screw (A1) that attaches the HR Receiver cover (A2) to the replacement HR Receiver case (A3). Slide the cover off. Attach the HR Receiver case to the Seat Rail Assembly with screws (A4). Be sure the cable (C) is pointed toward the front of the Seat Rail Assembly. Slide the cover into position and attach.

8. Tie the end of the string at the Seat Rail Assembly opening to the end of the new HR Receiver cable (C). Hold the other end of the string and carefully pull the HR Receiver cable through the Seat Rail Assembly.

**NOTICE:** Do not crimp the cables.

9. Untie the string from the HR Receiver cable and connect the cable to the HR Receiver cable from the Rower Engine.

**NOTICE:** Do not crimp any cables. Be sure the routing for the new HR Receiver cable (C) and other wiring is correct to prevent interference from moving parts.

10. Carefully lower the machine to the floor and do not let it drop from any height.

#### 11. Final Inspection

Inspect your machine to ensure that all hardware is tight and components are properly assembled.



**Do not use until the machine has been fully assembled and inspected for correct performance in accordance with the Owner's Manual.**

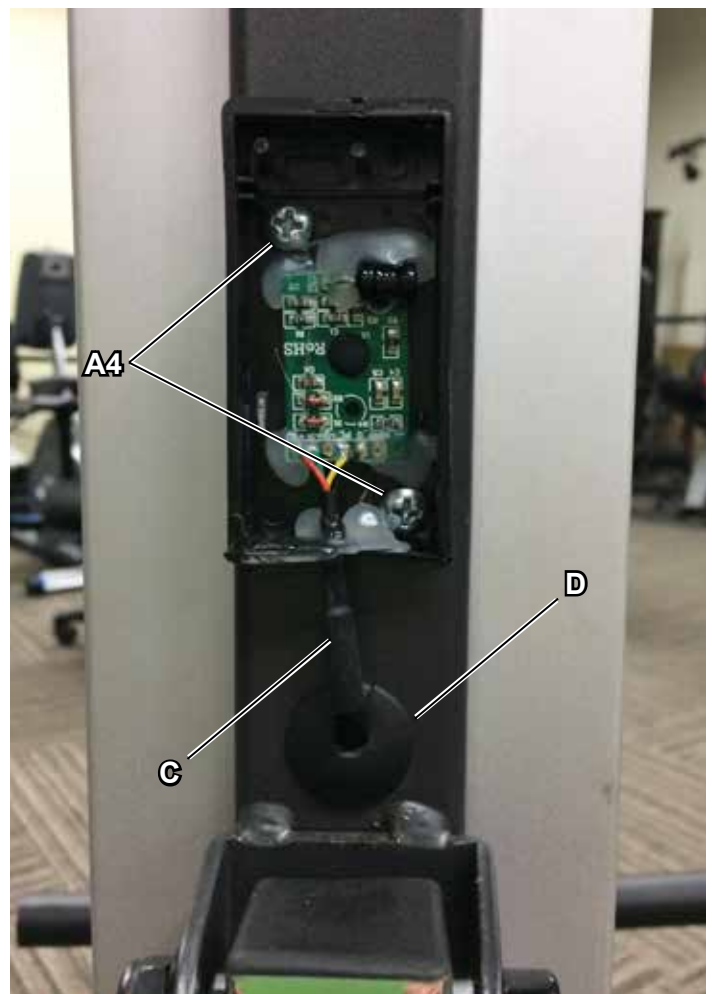
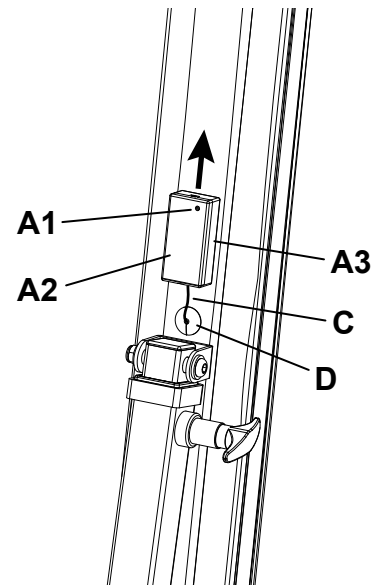

**NOTICE:** This document provides instructions for the replacement of the Pull Handle on the Schwinn™ Crewmaster™/Rower International.

**If you need assistance, please call Schwinn Customer Service (if purchased in US/Canada) or your local distributor (if purchased outside US/Canada). To find your local distributor, go to: [www.nautilusinternational.com](http://www.nautilusinternational.com)**



**This icon means a potentially hazardous situation which, if not avoided, could result in death or serious injury. Read and understand all Warnings on this machine.**

Nautilus, Inc., [www.NautilusInc.com](http://www.NautilusInc.com), 5415 Centerpoint Parkway, Groveport, OH 43125 U.S.A. - Customer Service: North America (800) 605-3369, [csnls@nautilus.com](mailto:csnls@nautilus.com) | outside U.S. [www.nautilusinternational.com](http://www.nautilusinternational.com) | © 2017 Nautilus, Inc. | Schwinn, the Schwinn Quality logo, Crewmaster, and Nautilus are trademarks owned by or licensed to Nautilus, Inc., which are registered or otherwise protected by common law in the United States and other countries. | **ORIGINAL DOCUMENT - ENGLISH VERSION ONLY**

---

## **Important Safety Instructions - Before servicing or using this equipment, obey the following warnings:**



**Disconnect all power to the machine before you service it.**

- Read and understand the Part Replacement Procedure before working on the machine. Failure to obey the instructions and safety warnings could cause injury to the service technician or bystanders.
- Keep bystanders and children away from the product being serviced at all times.
- Make sure that the repair is done in an appropriate work space away from foot traffic and exposure to bystanders.
- Some components of the equipment can be heavy or awkward. Enlist the service of a second person when you do maintenance steps involving these components. Do not try to do heavy or awkward steps on your own.
- If replacement parts are necessary, use only genuine Nautilus replacement parts and hardware. Failure to use genuine replacement parts can cause a risk to users, keep the machine from operating correctly and void the warranty.
- Be sure that all warning stickers and instructional placards applied to the product stay present and in good condition when doing maintenance or replacing components. If at any time the Warning labels become loose, unreadable or dislodged, replace the labels. If purchased in US/Canada, contact Customer Service for replacement labels. If purchased outside US/Canada, contact your local distributor for them.
- Do not try to change the design or functionality of the machine being serviced as this can adversely affect user safety.
- Do not use the machine until all shrouds, instructions, warning labels and correct functionality have been verified and tested for correct performance.

### **Tools Required (not included)**

Rod, approximately 6" (15cm) long





**Note:** Your machine may not match the image. For reference only.

1. Pull the Handle to extend the Pull Strap for access to the space (security loop) between the stitching on the strap.

2. Slide a small rod into the security loop to prevent the Pull Strap from retracting into the Rower Engine.

**⚠ Do not allow the pull strap to retract by itself. Allowing the pull strap to snap back in an uncontrolled manner could cause damage to the rower engine or injury to the user or bystanders.**

3. Remove the Handle from the Pull Strap. Set it safely aside.

4. Push the replacement Handle through the end loop in the Pull Strap, and remove the rod from the security loop.

5. Inspect your machine to ensure that all hardware is tight and components are properly assembled.

**⚠ Do not use until the machine has been fully assembled and inspected for correct performance in accordance with the Owner's Manual.**



**NOTICE:** This document provides instructions for the replacement of the Seat Rail Assembly on the Schwinn™ Crewmaster™/Rower International.

**If you need assistance, please call Schwinn Customer Service (if purchased in US/Canada) or your local distributor (if purchased outside US/Canada). To find your local distributor, go to: [www.nautilusinternational.com](http://www.nautilusinternational.com)**



**This icon means a potentially hazardous situation which, if not avoided, could result in death or serious injury. Read and understand all Warnings on this machine.**

Nautilus, Inc., [www.NautilusInc.com](http://www.NautilusInc.com), 5415 Centerpoint Parkway, Groveport, OH 43125 U.S.A. - Customer Service: North America (800) 605-3369, [csnls@nautilus.com](mailto:csnls@nautilus.com) | outside U.S. [www.nautilusinternational.com](http://www.nautilusinternational.com) | © 2017 Nautilus, Inc. | Schwinn, the Schwinn Quality logo, Crewmaster, and Nautilus are trademarks owned by or licensed to Nautilus, Inc., which are registered or otherwise protected by common law in the United States and other countries. | **ORIGINAL DOCUMENT - ENGLISH VERSION ONLY**

### **Important Safety Instructions - Before servicing or using this equipment, obey the following warnings:**



**Disconnect all power to the machine before you service it.**

- Read and understand the Part Replacement Procedure before working on the machine. Failure to obey the instructions and safety warnings could cause injury to the service technician or bystanders.
- Keep bystanders and children away from the product being serviced at all times.
- Make sure that the repair is done in an appropriate work space away from foot traffic and exposure to bystanders.
- Some components of the equipment can be heavy or awkward. Enlist the service of a second person when you do maintenance steps involving these components. Do not try to do heavy or awkward steps on your own.
- If replacement parts are necessary, use only genuine Nautilus replacement parts and hardware. Failure to use genuine replacement parts can cause a risk to users, keep the machine from operating correctly and void the warranty.
- Be sure that all warning stickers and instructional placards applied to the product stay present and in good condition when doing maintenance or replacing components. If at any time the Warning labels become loose, unreadable or dislodged, replace the labels. If purchased in US/Canada, contact Customer Service for replacement labels. If purchased outside US/Canada, contact your local distributor for them.
- Do not try to change the design or functionality of the machine being serviced as this can adversely affect user safety.
- Do not use the machine until all shrouds, instructions, warning labels and correct functionality have been verified and tested for correct performance.

### **Tools Required (not included)**

#2 Phillips screwdriver



6mm hex key  
5mm hex key



**Note:** Your machine may not match the image. For reference only.

1. Remove hardware (indicated) that attaches the Seat Rail Assembly to the Rower Engine. Set the hardware safely aside for reassembly.



2. Carefully separate the Seat Rail Assembly and the Rower Engine. Disconnect the Data Cables and Heart Rate Cables

**NOTICE:** Do not crimp the cables. This step may require two people.

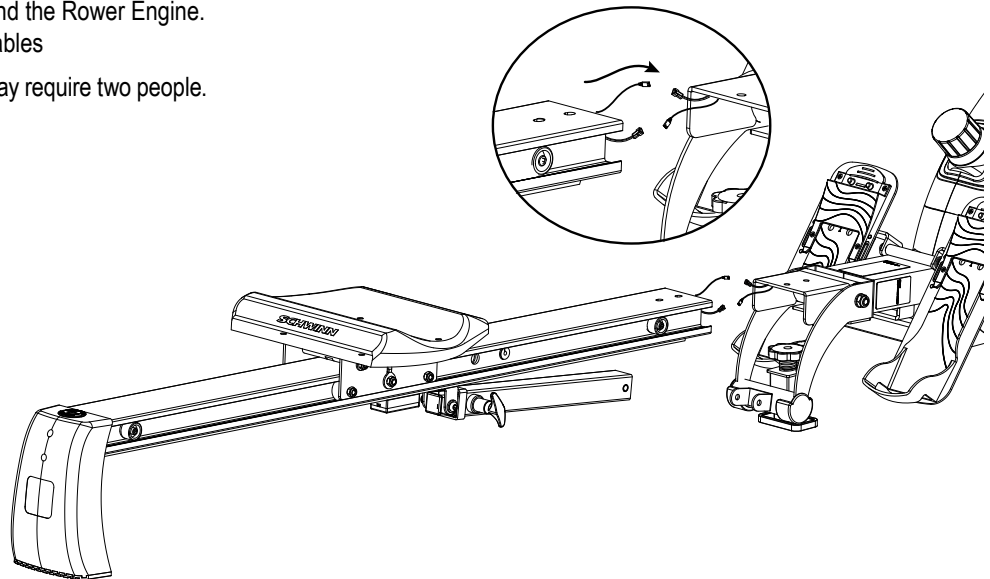

3. Remove the bushings and hardware from the Seat Rail Assembly. Set them safely aside. Slide the Seat off the Seat Rail Assembly.

**NOTICE:** Do not crimp the cables.

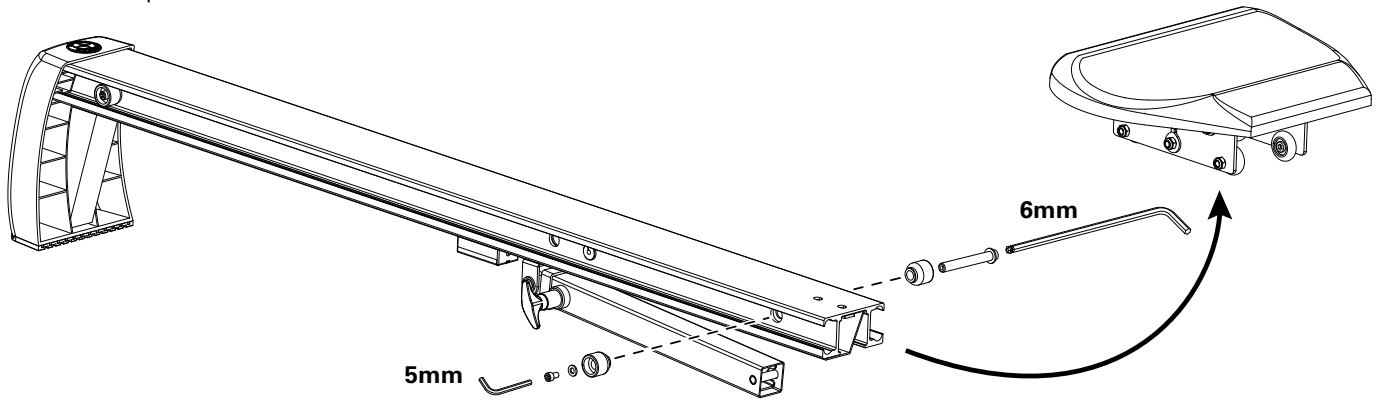

4. Installation is the reverse procedure.

**NOTICE:** Do not crimp the cables. When you reinstall the seat, make sure that the Schwinn™ name on the seat points away from the Rower Engine, so that the RPM Sensor Magnet is on the correct side of the Seat Rail.

5. Inspect your machine to ensure that all hardware is tight and components are properly assembled.

**⚠ Do not use until the machine has been fully assembled and inspected for correct performance in accordance with the Owner's Manual.**

**NOTICE:** This document provides instructions for the replacement of the Rear Cover on the Schwinn™ Crewmaster™/Rower International.

**If you need assistance, please call Schwinn Customer Service (if purchased in US/Canada) or your local distributor (if purchased outside US/Canada). To find your local distributor, go to: [www.nautilusinternational.com](http://www.nautilusinternational.com)**

**This icon means a potentially hazardous situation which, if not avoided, could result in death or serious injury. Read and understand all Warnings on this machine.**

Nautilus, Inc., [www.NautilusInc.com](http://www.NautilusInc.com), 5415 Centerpoint Parkway, Groveport, OH 43125 U.S.A. - Customer Service: North America (800) 605-3369, [csnls@nautilus.com](mailto:csnls@nautilus.com) | outside U.S. [www.nautilusinternational.com](http://www.nautilusinternational.com) | © 2017 Nautilus, Inc. | Schwinn, the Schwinn Quality logo, Crewmaster, and Nautilus are trademarks owned by or licensed to Nautilus, Inc., which are registered or otherwise protected by common law in the United States and other countries. | **ORIGINAL DOCUMENT - ENGLISH VERSION ONLY**

## Important Safety Instructions - Before servicing or using this equipment, obey the following warnings:

**Disconnect all power to the machine before you service it.**

- Read and understand the Part Replacement Procedure before working on the machine. Failure to obey the instructions and safety warnings could cause injury to the service technician or bystanders.
- Keep bystanders and children away from the product being serviced at all times.
- Make sure that the repair is done in an appropriate work space away from foot traffic and exposure to bystanders.
- Some components of the equipment can be heavy or awkward. Enlist the service of a second person when you do maintenance steps involving these components. Do not try to do heavy or awkward steps on your own.
- If replacement parts are necessary, use only genuine Nautilus replacement parts and hardware. Failure to use genuine replacement parts can cause a risk to users, keep the machine from operating correctly and void the warranty.
- Be sure that all warning stickers and instructional placards applied to the product stay present and in good condition when doing maintenance or replacing components. If at any time the Warning labels become loose, unreadable or dislodged, replace the labels. If purchased in US/Canada, contact Customer Service for replacement labels. If purchased outside US/Canada, contact your local distributor for them.
- Do not try to change the design or functionality of the machine being serviced as this can adversely affect user safety.
- Do not use the machine until all shrouds, instructions, warning labels and correct functionality have been verified and tested for correct performance.

## Tools Required (not included)

#2 Phillips screwdriver



**Note:** Your machine may not match the image. For reference only.

1. Remove the Schwinn™ Quality Seal sticker on the Rear Cover to expose the top screw. Remove the screw and set it safely aside.



2. Remove the 2 end screws from the Rear Cover. Set them safely aside.



3. Move the Seat to the front of the Seat Rail.
4. Pull the Seat Rail Locking Pin (M) to release and raise the Seat Rail Assembly to the folded position. Make sure that you have a secure grip when raising the Seat Rail Assembly.

**⚠ Stay clear of the movement path of the Seat Rail Assembly.**

5. Release the Seat Rail Locking Pin (M) to engage the support tube. You will hear an audible clicking noise. Be sure that the Seat Rail Locking Pin is fully engaged. If it is not fully engaged, injury to the user can occur.

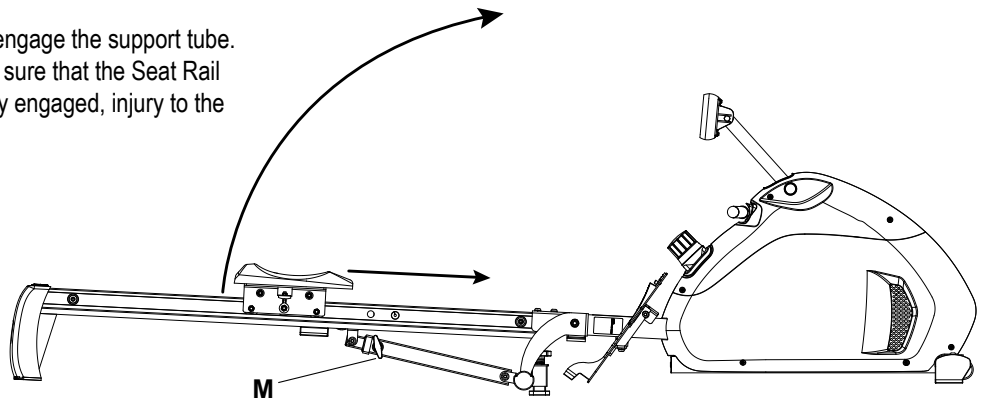

6. Remove the bottom screw that attaches the Rear Cover to the Seat Rail Assembly. Carefully remove the Rear Cover and set it safely aside.

7. Installation is the reverse procedure.

**NOTICE:** Carefully lower the machine to the floor and do not let it drop from any height.



8. Inspect your machine to ensure that all hardware is tight and components are properly assembled.

**⚠ Do not use until the machine has been fully assembled and inspected for correct performance in accordance with the Owner's Manual.**

**NOTICE:** This document provides instructions for the replacement of the rPM Sensor (Count Sensor) on the Schwinn™ Crewmaster™/Rower International.

**If you need assistance, please call Schwinn Customer Service (if purchased in US/Canada) or your local distributor (if purchased outside US/Canada). To find your local distributor, go to: [www.nautilusinternational.com](http://www.nautilusinternational.com)**

**This icon means a potentially hazardous situation which, if not avoided, could result in death or serious injury. Read and understand all Warnings on this machine.**

Nautilus, Inc., [www.NautilusInc.com](http://www.NautilusInc.com), 5415 Centerpoint Parkway, Groveport, OH 43125 U.S.A. - Customer Service: North America (800) 605-3369, [csnls@nautilus.com](mailto:csnls@nautilus.com) | outside U.S. [www.nautilusinternational.com](http://www.nautilusinternational.com) | © 2017 Nautilus, Inc. | Schwinn, the Schwinn Quality logo, Crewmaster, and Nautilus are trademarks owned by or licensed to Nautilus, Inc., which are registered or otherwise protected by common law in the United States and other countries. | **ORIGINAL DOCUMENT - ENGLISH VERSION ONLY**

### Important Safety Instructions - Before servicing or using this equipment, obey the following warnings:

**Disconnect all power to the machine before you service it.**

- Read and understand the Part Replacement Procedure before working on the machine. Failure to obey the instructions and safety warnings could cause injury to the service technician or bystanders.
- Keep bystanders and children away from the product being serviced at all times.
- Make sure that the repair is done in an appropriate work space away from foot traffic and exposure to bystanders.
- Some components of the equipment can be heavy or awkward. Enlist the service of a second person when you do maintenance steps involving these components. Do not try to do heavy or awkward steps on your own.
- If replacement parts are necessary, use only genuine Nautilus replacement parts and hardware. Failure to use genuine replacement parts can cause a risk to users, keep the machine from operating correctly and void the warranty.
- Be sure that all warning stickers and instructional placards applied to the product stay present and in good condition when doing maintenance or replacing components. If at any time the Warning labels become loose, unreadable or dislodged, replace the labels. If purchased in US/Canada, contact Customer Service for replacement labels. If purchased outside US/Canada, contact your local distributor for them.
- Do not try to change the design or functionality of the machine being serviced as this can adversely affect user safety.
- Do not use the machine until all shrouds, instructions, warning labels and correct functionality have been verified and tested for correct performance.

### Tools Required (not included)

#2 Phillips screwdriver



String/cable, 5' (152cm) or longer





**Note:** Your machine may not match the image. For reference only.

1. Move the Seat to the front of the Seat Rail.
2. Pull the Seat Rail Locking Pin (M) to release and raise the Seat Rail Assembly to the folded position. Make sure that you have a secure grip when raising the Seat Rail Assembly.

**!** **Stay clear of the movement path of the Seat Rail Assembly.**

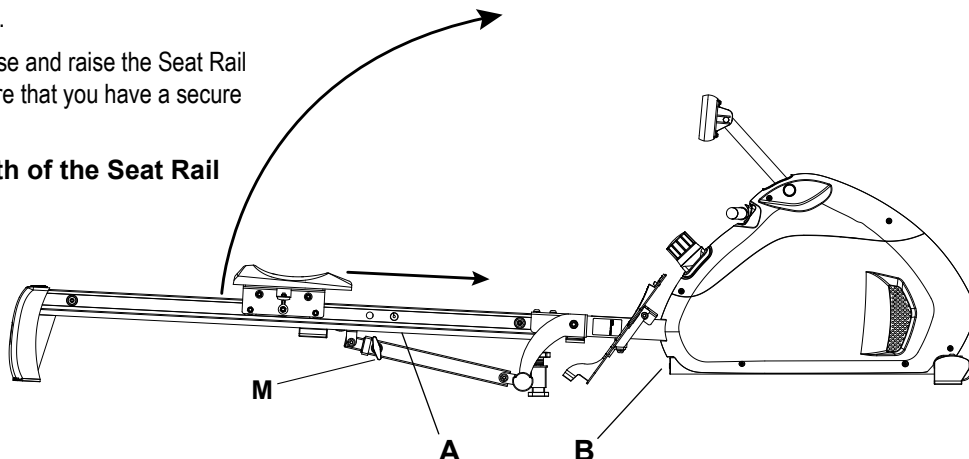

3. Release the Seat Rail Locking Pin (M) to engage the support tube. You will hear an audible clicking noise. Be sure that the Seat Rail Locking Pin is fully engaged. If it is not fully engaged, injury to the user can occur.

4. Observe the cable routing from the RPM Sensor (A) to the cables from the Rower Engine (B) on your machine. Carefully disconnect the RPM Sensor cables (C).

**NOTICE:** Do not crimp any cables.

Tie a string to the end of the cable from the RPM Sensor.

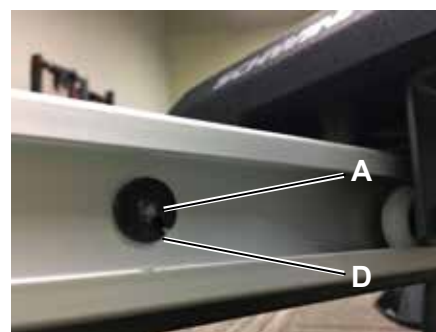

5. Carefully remove the old RPM Sensor and pull the cable and string through the Seat Rail Assembly so that the string extends through the Seat Rail Assembly and the Grommet (D). Untie the string from the old cable and discard the old RPM Sensor.

**Note:** It may be necessary to remove the Grommet from the opening in the Seat Rail Assembly.

6. Tie the end of the string at the Seat Rail Assembly opening to the end of the new RPM Sensor cable (C). Hold the other end of the string and carefully pull the RPM Sensor cable through the Seat Rail Assembly.

**NOTICE:** Do not crimp the cables.

7. Untie the string from the RPM Sensor cable and connect the cable to the RPM Sensor cable from the Rower Engine.

**NOTICE:** Do not crimp any cables. Be sure the routing for the new HR Receiver cable (C) and other wiring is correct to prevent interference from moving parts.

8. Carefully lower the machine to the floor and do not let it drop from any height.

9. Inspect your machine to ensure that all hardware is tight and components are properly assembled.

**!** **Do not use until the machine has been fully assembled and inspected for correct performance in accordance with the Owner's Manual.**



**NOTICE:** This document provides instructions for the replacement of the Seat on the Schwinn™ Crewmaster™/Rower International.

**If you need assistance, please call Schwinn Customer Service (if purchased in US/Canada) or your local distributor (if purchased outside US/Canada). To find your local distributor, go to: [www.nautilusinternational.com](http://www.nautilusinternational.com)**

**⚠ This icon means a potentially hazardous situation which, if not avoided, could result in death or serious injury. Read and understand all Warnings on this machine.**

Nautilus, Inc., [www.NautilusInc.com](http://www.NautilusInc.com), 5415 Centerpoint Parkway, Groveport, OH 43125 U.S.A. - Customer Service: North America (800) 605-3369, [csnls@nautilus.com](mailto:csnls@nautilus.com) | outside U.S. [www.nautilusinternational.com](http://www.nautilusinternational.com) | © 2017 Nautilus, Inc. | Schwinn, the Schwinn Quality logo, Crewmaster, and Nautilus are trademarks owned by or licensed to Nautilus, Inc., which are registered or otherwise protected by common law in the United States and other countries. | **ORIGINAL DOCUMENT - ENGLISH VERSION ONLY**

## **Important Safety Instructions - Before servicing or using this equipment, obey the following warnings:**

**⚠ Disconnect all power to the machine before you service it.**

- Read and understand the Part Replacement Procedure before working on the machine. Failure to obey the instructions and safety warnings could cause injury to the service technician or bystanders.
- Keep bystanders and children away from the product being serviced at all times.
- Make sure that the repair is done in an appropriate work space away from foot traffic and exposure to bystanders.
- Some components of the equipment can be heavy or awkward. Enlist the service of a second person when you do maintenance steps involving these components. Do not try to do heavy or awkward steps on your own.
- If replacement parts are necessary, use only genuine Nautilus replacement parts and hardware. Failure to use genuine replacement parts can cause a risk to users, keep the machine from operating correctly and void the warranty.
- Be sure that all warning stickers and instructional placards applied to the product stay present and in good condition when doing maintenance or replacing components. If at any time the Warning labels become loose, unreadable or dislodged, replace the labels. If purchased in US/Canada, contact Customer Service for replacement labels. If purchased outside US/Canada, contact your local distributor for them.
- Do not try to change the design or functionality of the machine being serviced as this can adversely affect user safety.
- Do not use the machine until all shrouds, instructions, warning labels and correct functionality have been verified and tested for correct performance.

### **Tools Required (not included)**

#2 Phillips screwdriver



6mm hex key  
5mm hex key



**Note:** Your machine may not match the image. For reference only.

1. Remove hardware (indicated) that attaches the Seat Rail Assembly to the Rower Engine. Set the hardware safely aside for reassembly.



2. Carefully separate the Seat Rail Assembly and the Rower Engine.  
Disconnect the Data Cables and Heart Rate Cables

**NOTICE:** Do not crimp the cables. This step may require two people.

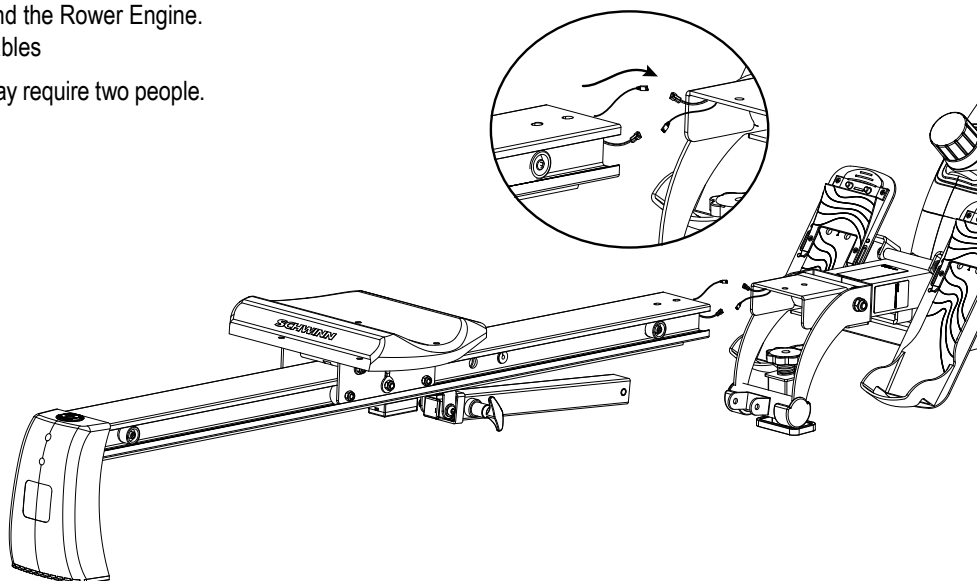

3. Remove the bushings and hardware from the Seat Rail Assembly. Set them safely aside. Slide the Seat off the Seat Rail Assembly.

**NOTICE:** Do not crimp the cables.

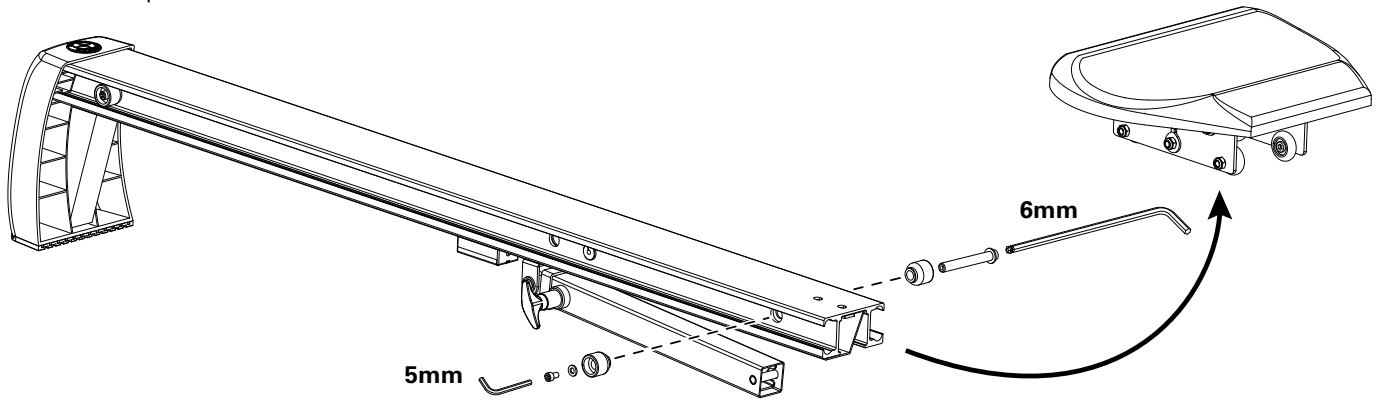

4. Installation is the reverse procedure.

**NOTICE:** Do not crimp the cables. When you install the replacement Seat, make sure that the Schwinn™ name on the seat points away from the Rower Engine, so that the RPM Sensor Magnet is on the correct side of the Seat Rail.

5. Inspect your machine to ensure that all hardware is tight and components are properly assembled.

**⚠ Do not use until the machine has been fully assembled and inspected for correct performance in accordance with the Owner's Manual.**

**NOTICE:** This document provides instructions for the replacement of the Seat Rollers on the Schwinn™ Crewmaster™/Rower International.

**If you need assistance, please call Schwinn Customer Service (if purchased in US/Canada) or your local distributor (if purchased outside US/Canada). To find your local distributor, go to: [www.nautilusinternational.com](http://www.nautilusinternational.com)**

**⚠ This icon means a potentially hazardous situation which, if not avoided, could result in death or serious injury. Read and understand all Warnings on this machine.**

Nautilus, Inc., [www.NautilusInc.com](http://www.NautilusInc.com), 5415 Centerpoint Parkway, Groveport, OH 43125 U.S.A. - Customer Service: North America (800) 605-3369, [csnls@nautilus.com](mailto:csnls@nautilus.com) | outside U.S. [www.nautilusinternational.com](http://www.nautilusinternational.com) | © 2017 Nautilus, Inc. | Schwinn, the Schwinn Quality logo, Crewmaster, and Nautilus are trademarks owned by or licensed to Nautilus, Inc., which are registered or otherwise protected by common law in the United States and other countries. | **ORIGINAL DOCUMENT - ENGLISH VERSION ONLY**

## **Important Safety Instructions - Before servicing or using this equipment, obey the following warnings:**

**⚠ Disconnect all power to the machine before you service it.**

- Read and understand the Part Replacement Procedure before working on the machine. Failure to obey the instructions and safety warnings could cause injury to the service technician or bystanders.
- Keep bystanders and children away from the product being serviced at all times.
- Make sure that the repair is done in an appropriate work space away from foot traffic and exposure to bystanders.
- Some components of the equipment can be heavy or awkward. Enlist the service of a second person when you do maintenance steps involving these components. Do not try to do heavy or awkward steps on your own.
- If replacement parts are necessary, use only genuine Nautilus replacement parts and hardware. Failure to use genuine replacement parts can cause a risk to users, keep the machine from operating correctly and void the warranty.
- Be sure that all warning stickers and instructional placards applied to the product stay present and in good condition when doing maintenance or replacing components. If at any time the Warning labels become loose, unreadable or dislodged, replace the labels. If purchased in US/Canada, contact Customer Service for replacement labels. If purchased outside US/Canada, contact your local distributor for them.
- Do not try to change the design or functionality of the machine being serviced as this can adversely affect user safety.
- Do not use the machine until all shrouds, instructions, warning labels and correct functionality have been verified and tested for correct performance.

### **Tools Required (not included)**

#2 Phillips screwdriver

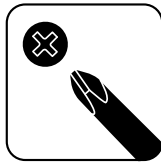

6mm hex key  
5mm hex key



13mm open end wrench



**Note:** Your machine may not match the image. For reference only.

1. Remove hardware (indicated) that attaches the Seat Rail Assembly to the Rower Engine. Set the hardware safely aside for reassembly.



2. Carefully separate the Seat Rail Assembly and the Rower Engine.  
Disconnect the Data Cables and Heart Rate Cables

**NOTICE:** Do not crimp the cables. This step may require two people.

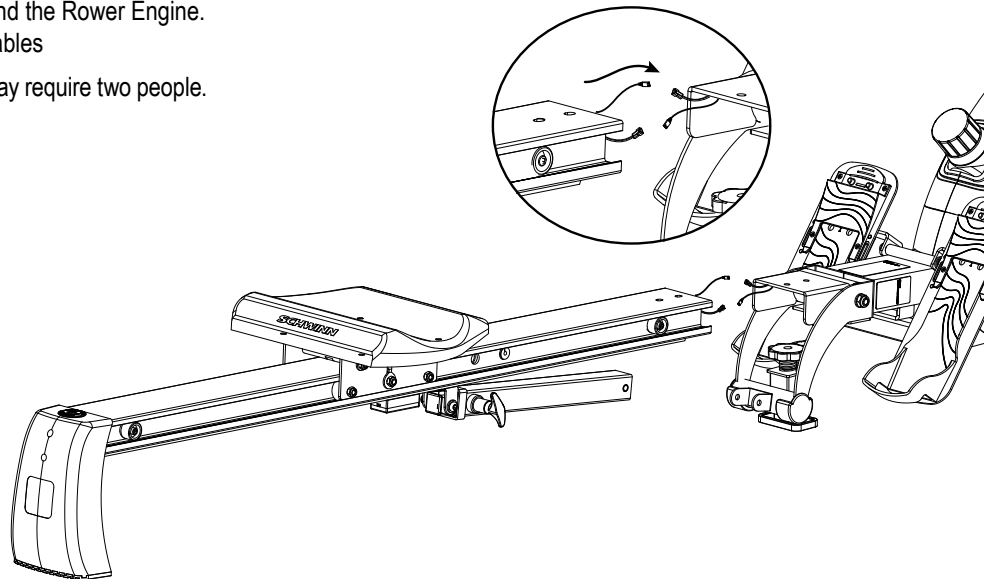

3. Remove the bushings and hardware from the Seat Rail Assembly. Set them safely aside. Slide the Seat off the Seat Rail Assembly.

**NOTICE:** Do not crimp the cables.

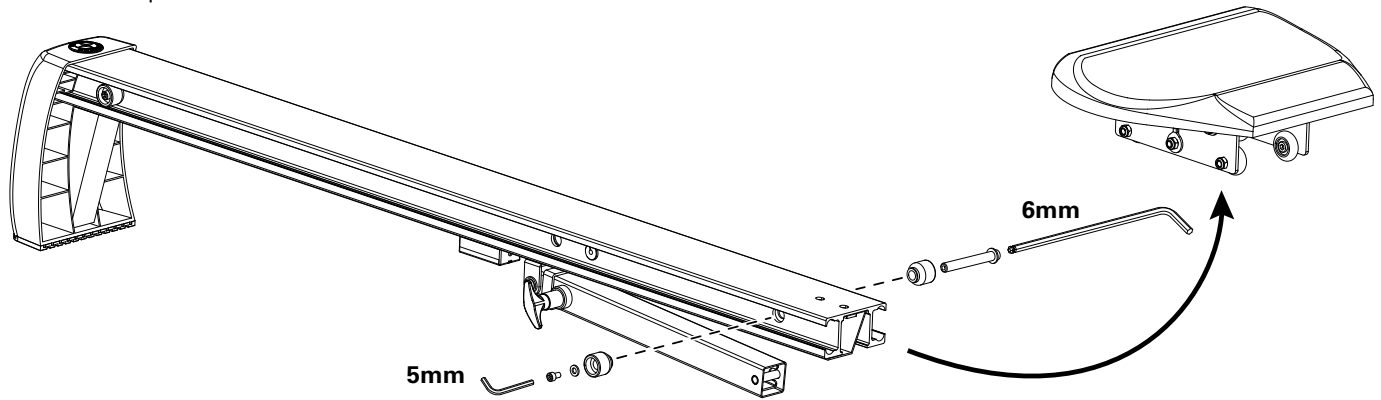

4. Remove the hardware that attaches the old Roller Wheel, and the Roller Wheel. Set them safely aside.

5. Installation is the reverse procedure.

**NOTICE:** Do not crimp the cables. When you reinstall the seat, make sure that the Schwinn™ name on the seat points away from the Rower Engine, so that the RPM Sensor Magnet is on the correct side of the Seat Rail.

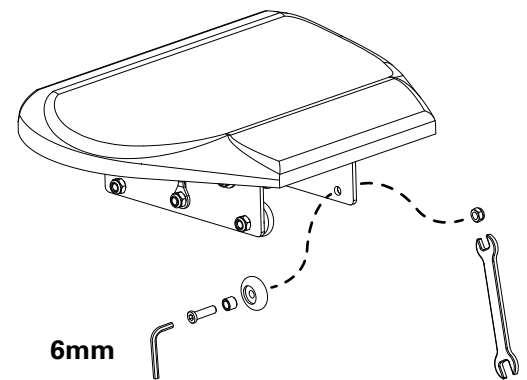

6. Inspect your machine to ensure that all hardware is tight and components are properly assembled.

**!** Do not use until the machine has been fully assembled and inspected for correct performance in accordance with the Owner's Manual.



**NOTICE:** This document provides instructions for the replacement of the Shrouds on the Schwinn™ Crewmaster™/Rower International.

**If you need assistance, please call Schwinn Customer Service (if purchased in US/Canada) or your local distributor (if purchased outside US/Canada). To find your local distributor, go to: [www.nautilusinternational.com](http://www.nautilusinternational.com)**



**This icon means a potentially hazardous situation which, if not avoided, could result in death or serious injury. Read and understand all Warnings on this machine.**

Nautilus, Inc., [www.NautilusInc.com](http://www.NautilusInc.com), 5415 Centerpoint Parkway, Groveport, OH 43125 U.S.A. - Customer Service: North America (800) 605-3369, [csnls@nautilus.com](mailto:csnls@nautilus.com) | outside U.S. [www.nautilusinternational.com](http://www.nautilusinternational.com) | © 2017 Nautilus, Inc. | Schwinn, the Schwinn Quality logo, Crewmaster, and Nautilus are trademarks owned by or licensed to Nautilus, Inc., which are registered or otherwise protected by common law in the United States and other countries. | **ORIGINAL DOCUMENT - ENGLISH VERSION ONLY**

### Important Safety Instructions - Before servicing or using this equipment, obey the following warnings:



**Disconnect all power to the machine before you service it.**

- Read and understand the Part Replacement Procedure before working on the machine. Failure to obey the instructions and safety warnings could cause injury to the service technician or bystanders.
- Keep bystanders and children away from the product being serviced at all times.
- Make sure that the repair is done in an appropriate work space away from foot traffic and exposure to bystanders.
- Some components of the equipment can be heavy or awkward. Enlist the service of a second person when you do maintenance steps involving these components. Do not try to do heavy or awkward steps on your own.
- If replacement parts are necessary, use only genuine Nautilus replacement parts and hardware. Failure to use genuine replacement parts can cause a risk to users, keep the machine from operating correctly and void the warranty.
- Be sure that all warning stickers and instructional placards applied to the product stay present and in good condition when doing maintenance or replacing components. If at any time the Warning labels become loose, unreadable or dislodged, replace the labels. If purchased in US/Canada, contact Customer Service for replacement labels. If purchased outside US/Canada, contact your local distributor for them.
- Do not try to change the design or functionality of the machine being serviced as this can adversely affect user safety.
- Do not use the machine until all shrouds, instructions, warning labels and correct functionality have been verified and tested for correct performance.

### Tools Required (not included)

#2 Phillips screwdriver

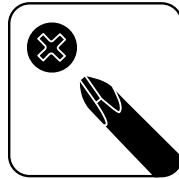



**Note:** Your machine may not match the image. For reference only.

1. Carefully remove the screws (indicated) that attach the Shrouds to the frame. Remove the bottom screws first. Set the hardware safely aside.

2. Remove the Shrouds and set them safely aside.

**NOTICE:** Do not crimp the cables.

3. Installation is the reverse procedure. Install the top screws first.

**NOTICE:** Do not crimp the cables.

4. Inspect your machine to ensure that all hardware is tight and components are properly assembled.



**Do not use until the machine has been fully assembled and inspected for correct performance in accordance with the Owner's Manual.**

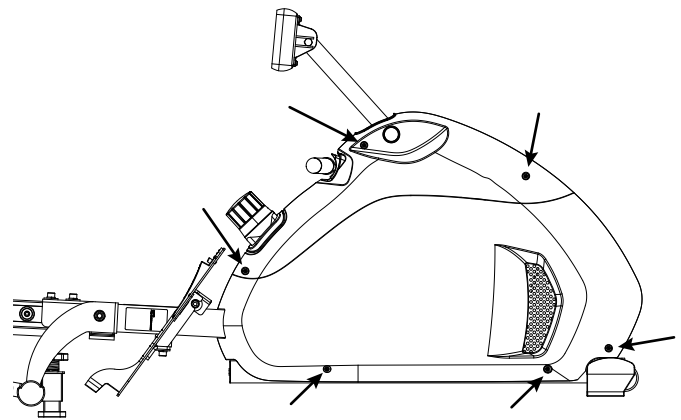
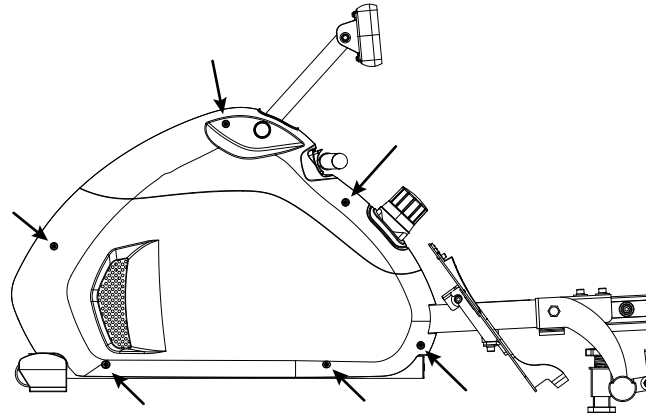

**NOTICE:** This document provides instructions for the replacement of the Stabilizer End Cap on the Schwinn™ Crewmaster™/Rower International.

**If you need assistance, please call Schwinn Customer Service (if purchased in US/Canada) or your local distributor (if purchased outside US/Canada). To find your local distributor, go to: [www.nautilusinternational.com](http://www.nautilusinternational.com)**

**⚠ This icon means a potentially hazardous situation which, if not avoided, could result in death or serious injury. Read and understand all Warnings on this machine.**

Nautilus, Inc., [www.NautilusInc.com](http://www.NautilusInc.com), 5415 Centerpoint Parkway, Groveport, OH 43125 U.S.A. - Customer Service: North America (800) 605-3369, [csnls@nautilus.com](mailto:csnls@nautilus.com) | outside U.S. [www.nautilusinternational.com](http://www.nautilusinternational.com) | © 2017 Nautilus, Inc. | Schwinn, the Schwinn Quality logo, Crewmaster, and Nautilus are trademarks owned by or licensed to Nautilus, Inc., which are registered or otherwise protected by common law in the United States and other countries. | **ORIGINAL DOCUMENT - ENGLISH VERSION ONLY**

## **Important Safety Instructions - Before servicing or using this equipment, obey the following warnings:**

**⚠ Disconnect all power to the machine before you service it.**

- Read and understand the Part Replacement Procedure before working on the machine. Failure to obey the instructions and safety warnings could cause injury to the service technician or bystanders.
- Keep bystanders and children away from the product being serviced at all times.
- Make sure that the repair is done in an appropriate work space away from foot traffic and exposure to bystanders.
- Some components of the equipment can be heavy or awkward. Enlist the service of a second person when you do maintenance steps involving these components. Do not try to do heavy or awkward steps on your own.
- If replacement parts are necessary, use only genuine Nautilus replacement parts and hardware. Failure to use genuine replacement parts can cause a risk to users, keep the machine from operating correctly and void the warranty.
- Be sure that all warning stickers and instructional placards applied to the product stay present and in good condition when doing maintenance or replacing components. If at any time the Warning labels become loose, unreadable or dislodged, replace the labels. If purchased in US/Canada, contact Customer Service for replacement labels. If purchased outside US/Canada, contact your local distributor for them.
- Do not try to change the design or functionality of the machine being serviced as this can adversely affect user safety.
- Do not use the machine until all shrouds, instructions, warning labels and correct functionality have been verified and tested for correct performance.

### **Tools Required (not included)**

#2 Phillips screwdriver



Static object (like a book or box) - not compressible



**Note:** Your machine may not match the image. For reference only.

1. Place a static object (like a book or box) under the front Stabilizer. The static object should not be compressible.

2. Remove the 2 screws and footpad from the bottom of the Endcap. Set them safely aside.

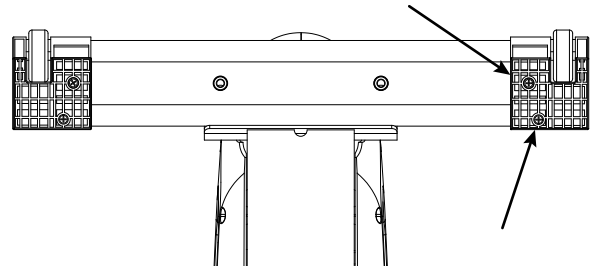

3. Slide the Endcap off the end of the Stabilizer.

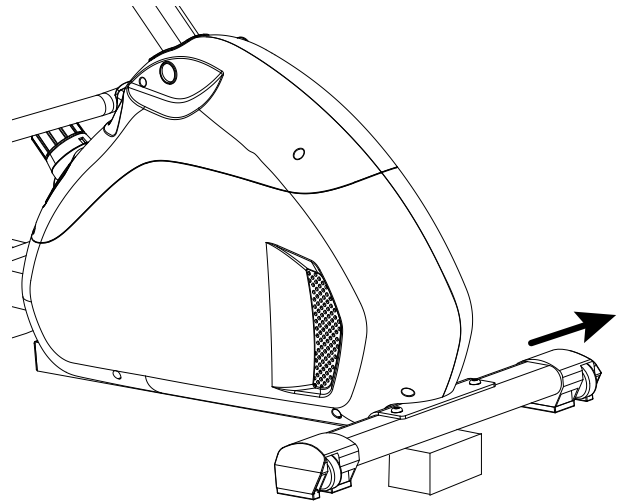

4. Attach the footpad to the Endcap. Do not fully tighten the screws.

5. Slide the Endcap onto the Stabilizer. Fully tighten the screws.

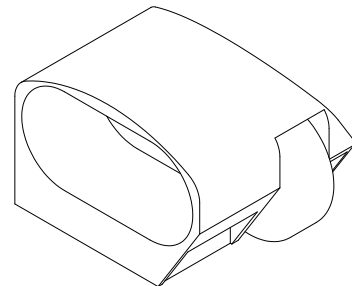

6. Inspect your machine to ensure that all hardware is tight and components are properly assembled.

**!** Do not use until the machine has been fully assembled and inspected for correct performance in accordance with the Owner's Manual.

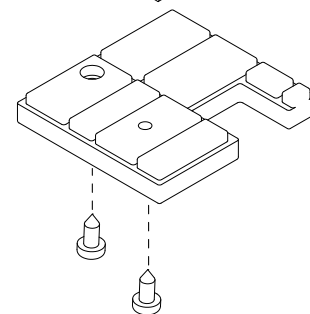

**NOTICE:** This document provides instructions for the replacement of the Stabilizer Foot on the Schwinn™ Crewmaster™/Rower International.

**If you need assistance, please call Schwinn Customer Service (if purchased in US/Canada) or your local distributor (if purchased outside US/Canada). To find your local distributor, go to: [www.nautilusinternational.com](http://www.nautilusinternational.com)**

**⚠ This icon means a potentially hazardous situation which, if not avoided, could result in death or serious injury. Read and understand all Warnings on this machine.**

Nautilus, Inc., [www.NautilusInc.com](http://www.NautilusInc.com), 5415 Centerpoint Parkway, Groveport, OH 43125 U.S.A. - Customer Service: North America (800) 605-3369, [csnls@nautilus.com](mailto:csnls@nautilus.com) | outside U.S. [www.nautilusinternational.com](http://www.nautilusinternational.com) | © 2017 Nautilus, Inc. | Schwinn, the Schwinn Quality logo, Crewmaster, and Nautilus are trademarks owned by or licensed to Nautilus, Inc., which are registered or otherwise protected by common law in the United States and other countries. | **ORIGINAL DOCUMENT - ENGLISH VERSION ONLY**

## **Important Safety Instructions - Before servicing or using this equipment, obey the following warnings:**

**⚠ Disconnect all power to the machine before you service it.**

- Read and understand the Part Replacement Procedure before working on the machine. Failure to obey the instructions and safety warnings could cause injury to the service technician or bystanders.
- Keep bystanders and children away from the product being serviced at all times.
- Make sure that the repair is done in an appropriate work space away from foot traffic and exposure to bystanders.
- Some components of the equipment can be heavy or awkward. Enlist the service of a second person when you do maintenance steps involving these components. Do not try to do heavy or awkward steps on your own.
- If replacement parts are necessary, use only genuine Nautilus replacement parts and hardware. Failure to use genuine replacement parts can cause a risk to users, keep the machine from operating correctly and void the warranty.
- Be sure that all warning stickers and instructional placards applied to the product stay present and in good condition when doing maintenance or replacing components. If at any time the Warning labels become loose, unreadable or dislodged, replace the labels. If purchased in US/Canada, contact Customer Service for replacement labels. If purchased outside US/Canada, contact your local distributor for them.
- Do not try to change the design or functionality of the machine being serviced as this can adversely affect user safety.
- Do not use the machine until all shrouds, instructions, warning labels and correct functionality have been verified and tested for correct performance.

### **Tools Required (not included)**

#2 Phillips screwdriver



Static object (like a book or box) - not compressible



**Note:** Your machine may not match the image. For reference only.

1. Move the Seat to the front of the Seat Rail.
2. Pull the Seat Rail Locking Pin (M) to release and raise the Seat Rail Assembly to the folded position. Make sure that you have a secure grip when raising the Seat Rail Assembly.

**! Stay clear of the movement path of the Seat Rail Assembly.**

3. Release the Seat Rail Locking Pin (M) to engage the support tube. You will hear an audible clicking noise. Be sure that the Seat Rail Locking Pin is fully engaged. If it is not fully engaged, injury to the user can occur.

**NOTICE:** The Stabilizer Foot assembly contains grease which can stain. It is advisable to protect the floor or carpet.

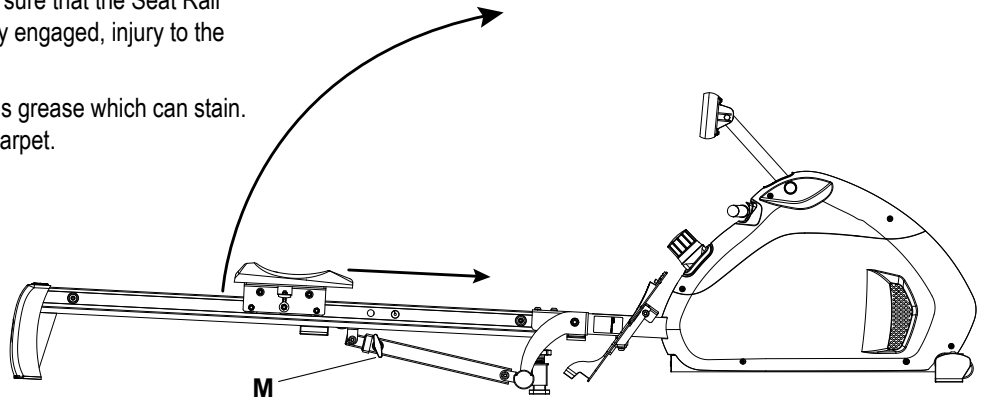

4. Fully loosen the Adjustment Handle (A) and remove. Be aware that the internal spring will recoil suddenly when the Adjustment Handle is fully loosened.

5. Grasp one of the curved Support Plates (S) and the Lift Handle (L). Carefully tilt the machine in order to remove the base (B) of the Stabilizer Foot.

**NOTICE:** Do not crimp the cables. This step may require two people.



6. Installation is the reverse procedure.

**NOTICE:** Do not crimp the cables.

7. Inspect your machine to ensure that all hardware is tight and components are properly assembled.

**!** Do not use until the machine has been fully assembled and inspected for correct performance in accordance with the Owner's Manual.

