

**Table of Contents**

<b>Section Code</b>	<b>Section</b>	<b>Page Number</b>
1	Important Safety Instructions	2
1	Safety Warning Labels and Serial Number	3
1	Reading the Serial Number	3
1	Specifications	4
1	Maintenance	4
1	Moving the Machine	6
1	Leveling the Machine	6
1	Troubleshooting	7
1	Console Service Mode	8
1	Maintenance Parts Exploded View	9
1	Replacement Procedure Skill Level	10
	Mechanical Procedures	11
2	Brake Lubrication	11
3	Brake Adjustment	14
4	Chain Tension Adjustment	16
	Part Replacement	20
5	Pedals	20
6	Console	22
7	Handlebars and Handlebar Post	24
8	Brake Cover	27
9	Brake Assembly and Resistance Knob Assembly	29
10	Left Crank Arm	32
11	Speed Sensor	35
12	Chain Guard Covers	39
13	Retainer Clips	41
14	Drive Chain	45
15	Flywheel Assembly	52
16	Right Crank Arm and Sprocket Drive	60

**NOTICE:** This document provides important safety instructions, adjustments, and general troubleshooting information for the maintenance of the Schwinn® IC2 Bike.

**If you need assistance, please call Schwinn Customer Service at 1-800-605-3369.**



**This icon means a potentially hazardous situation which, if not avoided, could result in death or serious injury. Read and understand all Warnings on this machine.**

Nautilus, Inc., www.NautilusInc.com, 5415 Centerpoint Parkway, Groveport, OH 43125 U.S.A. - Customer Service: North America (800) 605-3369, csnlis@nautilus.com | outside U.S. www.nautilusinternational.com | © 2013 Nautilus, Inc. | ® indicates trademarks registered in the United States. These marks may be registered in other nations or otherwise protected by common law. Schwinn and the Schwinn logo are trademarks owned by or licensed to Nautilus, Inc. | ORIGINAL DOCUMENT - ENGLISH VERSION ONLY

## Important Safety Instructions



**This icon means a potentially hazardous situation which, if not avoided, could result in death or serious injury. Read and understand all Warnings on this machine.**

**Before servicing or using this equipment, obey the following warnings:**



**Read and understand the Service Manual before working on the machine. Failure to obey the instructions and safety warnings could cause injury to the service technician or bystanders.**

- Keep bystanders and children away from the product being serviced at all times.
- Make sure that the repair is done in an appropriate work space away from foot traffic and exposure to bystanders.
- Some components of the equipment can be heavy or awkward. Enlist the service of a second person when you do maintenance steps involving these components. Do not try to do heavy or awkward steps on your own.
- If replacement parts are necessary, use only genuine Nautilus replacement parts and hardware. Failure to use genuine replacement parts can cause a risk to users, keep the machine from operating correctly and void the warranty.
- Be sure that all warning stickers and instructional placards applied to the product stay present and in good condition when doing maintenance or replacing components. If necessary, request replacement warning stickers or placards from Nautilus customer service.
- Do not try to change the design or functionality of the machine being serviced as this can adversely affect user safety.
- Do not put the machine back in service until all shrouds, instructions, warning labels and correct functionality have been verified and tested for correct performance.

## Safety Warning Labels and Serial Numbers

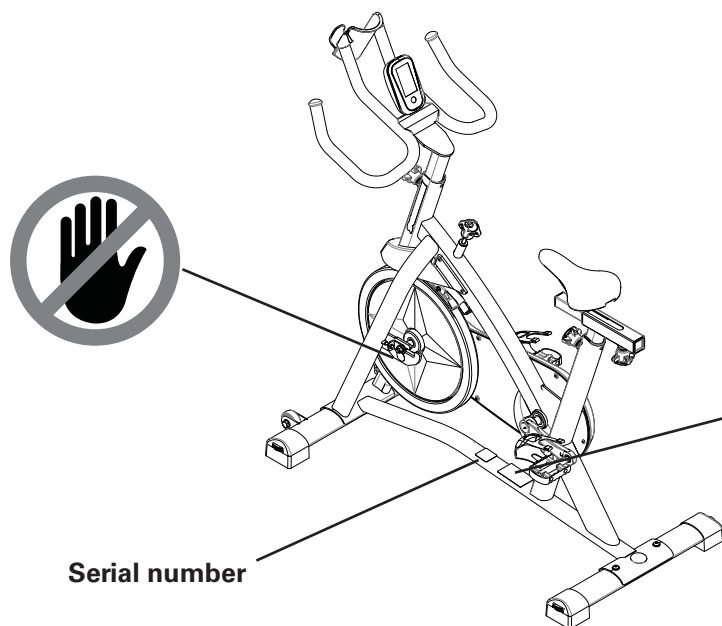

Serial number

<b>⚠ WARNING</b>
<ul style="list-style-type: none"> <li>• Keep children away.</li> <li>• Prior to use, read and understand the Owners Manual.</li> <li>• Injury or death is possible if Caution is not used while using this machine.</li> <li>• The maximum user weight for this machine is 250lbs. (113kg).</li> <li>• Replace any "Caution" "Warning" or "Danger" label that is illegible, damaged, or removed.</li> <li>• This machine is for home use only.</li> </ul>
<b>⚠ AVERTISSEMENT</b>
<ul style="list-style-type: none"> <li>• Gardez les enfants et les animaux de compagnie éloignés de cette machine en tout temps.</li> <li>• Lisez et familiarisez-vous avec le Manuel du propriétaire et avec tous les avertissements avant d'utiliser cette machine.</li> <li>• Soyez prudent lorsque vous utilisez cet équipement pour ne pas vous infliger de graves blessures.</li> <li>• Cette machine supporte un poids maximal de 250lbs. (113kg).</li> <li>• Remplacez toute étiquette d'avertissement endommagée, illisible ou manquante.</li> <li>• Cette machine est à usage domestique uniquement.</li> </ul>

### Reading the Serial Number

The instructions below show how to decode the information contained on the serial number.

#### SERIAL NO. FORMAT

AAAAAA - Product SKU  
 VVV - Supplier code  
 YY - Manufactured year  
 WW - Manufactured week  
 9999 - Sequential number



#### SERIAL NO. FORMAT (old)

AAAAAA - Product SKU  
 BBB - Supplier code  
 PPPPPP - Purchase order number  
 LL - Purchase order line number  
 CCCCCC - Unique identifier

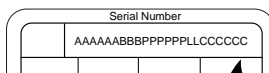

## Specifications

Maximum User Weight 250 lbs. (113 kg)  
Power Requirements 2 AA batteries (LR6)  
Operational Voltage 1.0 - 3.3VDC

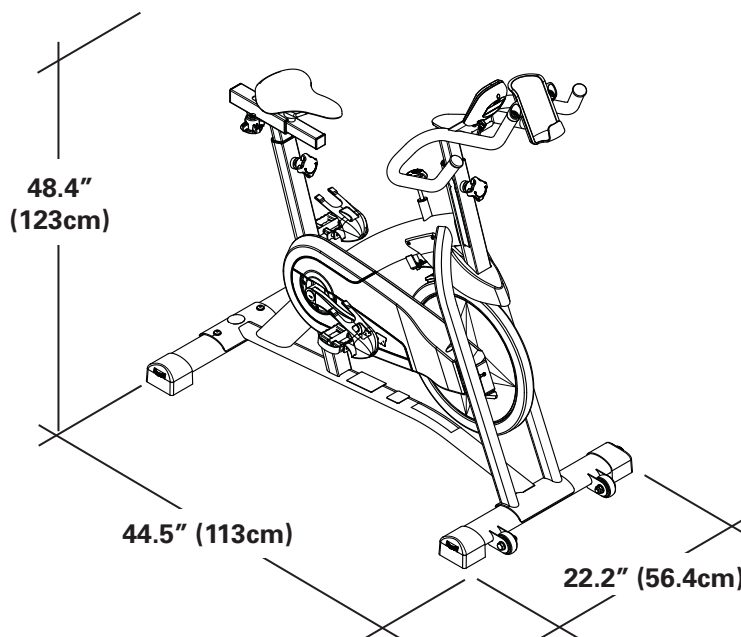

## Maintenance

Read all maintenance instructions fully before you start any repair work. In some conditions, an assistant is necessary to do the necessary tasks.



Equipment must be regularly examined for damage and repairs. The owner is responsible to make sure that regular maintenance is done. Worn or damaged components must be replaced immediately or the equipment removed from service until the repair is made. Only manufacturer supplied components can be used to maintain and repair the equipment.

<b>Daily</b>	Before each use, examine the exercise machine for loose, broken, damaged, or worn parts. Do not use if found in this condition. Repair or replace all parts at the first sign of wear or damage. After each workout, use a damp cloth to wipe your machine and Console free of sweat. <b>Note:</b> Avoid excessive moisture on the Console.
<b>Weekly</b>	Clean the machine to remove any dust, dirt, or grime from the surfaces. If needed, sparingly apply a thin coating of silicone lube to ease operation. <b>Note:</b> Do not use petroleum based products.
<b>Monthly</b>	Check pedals and crank arms, and tighten as necessary. Make sure all bolts and screws are tight. Tighten as necessary. Lubricate chain with lithium grease.

**NOTICE:** Do not clean with a petroleum based solvent or an automotive cleaner. Be sure to keep the Console free of moisture.



## Chain Lubrication

- ⚠ Do not apply lubricant when the chain is moving.
- Be sure to keep fingers clear of all pinch hazards.

Remove the chain guard door and apply a small amount of lithium grease to the chain (C).

**Note:** Use caution to avoid staining clothes or carpet.

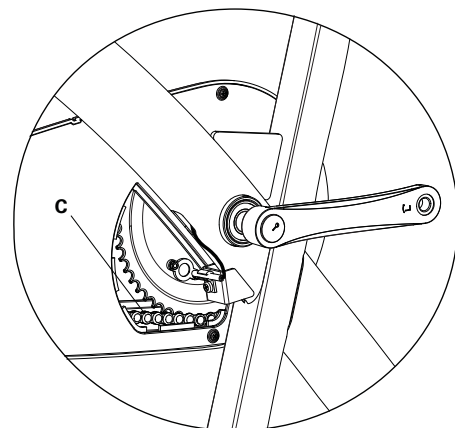

## Replacing the Console Batteries

The Console display will show “Batt” during power up if the battery level is low. When replacing the batteries, make sure the batteries point in the +/– direction shown in the battery bay.

**Note:** The console uses AA size batteries (LR6).

- ⚠ Do not mix old and new batteries.
- Do not mix alkaline, standard (carbon-zinc), or rechargeable (Ni-Cd, Ni-MH, etc) batteries.

Be sure to remove the batteries to prevent corrosion damage if you are not going to use the machine for an extended period of time.

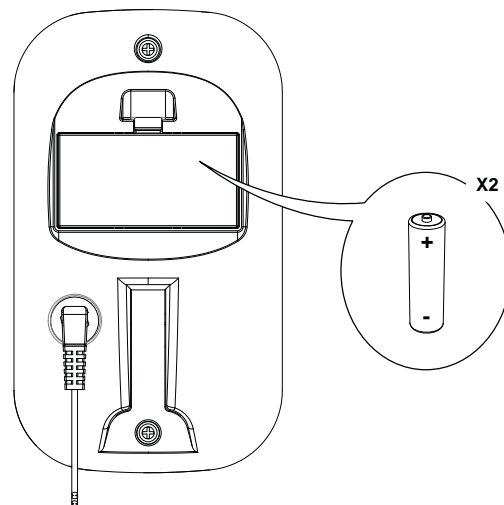

## Moving the Bike

To move the bike, carefully pull the Handlebars toward you while pushing the front of the bike downward. Push the bike to the desired location.

**NOTICE:** Be careful when you move the machine. Abrupt motions can affect the computer operation.

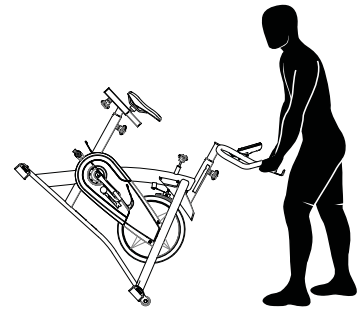

## Leveling the Bike

Levelers are found on each side of the stabilizers. Turn the knob to adjust the stabilizer foot. Make sure the bike is level and stable before you exercise.

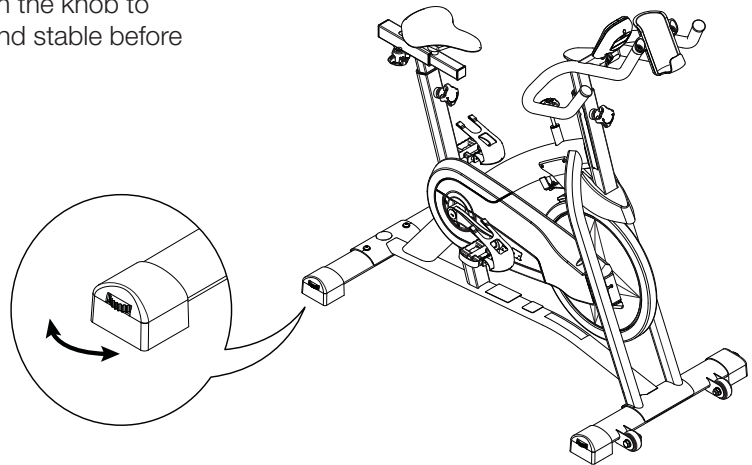

## Troubleshooting

Condition/Problem	Things to Check	Solution
Console will not power up/turn on/start	Batteries	Make sure batteries are installed correctly. If batteries are correctly installed, replace with a set of new batteries.
	Check data cable integrity	All wires in cable should be intact. If any are visibly crimped or cut, replace cable.
	Check data cable connections/orientation	Make sure cable is connected securely and oriented properly. Small latch on connector should line up and snap into place.
	Check console display for damage	Check for visual sign that console display is cracked or otherwise damaged. Replace Console if damaged.
		If the above steps do not resolve the problem, contact Customer Care for further assistance.
Speed displayed is not accurate	Display set to wrong unit of measure. (English/Metric)	Change display units.
Speed displayed is always "0"/stuck in Pause mode	Data cable	Make sure the data cable is connected to the back of the Console and the main frame assembly.
No speed/RPM reading	Check data cable integrity	All wires in cable should be intact. If any are cut or crimped, replace cable.
	Check data cable connections/orientation	Be sure cable is connected securely and oriented properly. Small latch on connector should line up and snap into place.
	Check magnet position (requires shroud removal)	Magnet should be in place on pulley.
	Check RPM Sensor (requires shroud removal)	RPM sensor should be aligned with magnet and connected to data cable. Realign sensor if necessary. Replace if there is any damage to the sensor or the connecting wire.
Console shuts off (enters sleep mode) while in use	Check data cable integrity	All wires in the cable should be intact. If any are cut or crimped, replace cable.
	Check data cable connections/orientation	Be sure cable is connected securely and oriented properly. Small latch on connector should line up and snap into place.
	Check magnet position (requires shroud removal)	Magnet should be in place on pulley.
	Check RPM Sensor	Contact Customer Care for further assistance.
Unit rocks/does not sit level	Check leveler adjustment	Leveling feet may be turned in or out to level bike.
	Check surface under unit	Adjustment may not be able to compensate for extremely uneven surfaces. Move bike to level area.
Pedals loose/unit difficult to pedal	Check pedal to crank connection	Pedal should be tightened securely to crank. Be sure connection is not cross-threaded.
	Check crank to axle connection	Crank should be tightened securely to axle.
Clicking sound when pedaling	Check pedal to crank connection	Remove pedals and reattach fully.
Rattling or grinding sound when pedaling/unit difficult to pedal	Check chain tension (requires chain guard door removal)	Open chain guard door to see the chain. Tension should not be too loose (nor too tight). Contact Customer Care for assistance.
Seat post movement	Check locking pin	Be sure adjustment pin is locked into one of the seat post adjustment holes.
	Check adjustment knob	Be sure knob is securely tightened.

## Console Service Mode

Service Mode lets you set the units of measure to either English or Metric, see machine statistics and firmware version (for technician use only).

1. When the Console is in Workout Mode or Pause Mode, push and hold down the button for 5 seconds to go into Service Mode.

**Note:** Tap the button to move through the Service Mode Menu options. When the Console display shows “dOnE”, push and hold the button for 3 seconds to reset the workout data and go back to Workout Mode.

2. The Console display shows the Units prompt. Push and hold the button to start Units option. Push the button to change between “LbS” (English units) and “SI” (metric units).
3. Push and hold the button for 3 seconds to set the units. The Console display shows the Units prompt.
4. Push the button to go to the Stats prompt. Push and hold the button to start the machine Stats option. The Console display shows Total Distance. Push the button to change between Total Distance and Total Time.  
**Note:** The Total Distance value is a whole number of miles/km (no decimal point).
5. Push and hold the button for 3 seconds to go back to the Stats prompt.
6. Push the button to go to the Firmware Version prompt. Push and hold the button to see the firmware version of the Console.
7. Push and hold the button for 3 seconds to go back to the Firmware Version prompt.
8. Push the button to go to the exit option. The Console display shows “dOnE”.

To go back to Workout Mode, push and hold the button for 3 seconds. The workout data is reset.

To go through the Service Mode Menu again, tap the button. The Console display will show the Units prompt.

In Service Mode if the Console does not receive any input in approximately 5 minutes, it goes into Sleep Mode.

## Maintenance Parts Exploded View

Your machine may differ. Use only as a guide.

A	Console	I	Crank Arms	Q	Chain
B	Water Bottle Holder	J	Pedals	R	Speed Sensor Magnet
C	Handlebars	K	Seat	S	RPM Sensor
D	Brake/Resistance Knob	L	Seat Post	T	Sprocket Drive
E	Brake Assembly	M	Adjustment Knobs	U	Data Cable
F	Chain Guard	N	Chain Guard Door	V	Flywheel
G	Chain Guard Center Plate	O	Levelers	W	Flywheel Retainer Clip
H	Chain Guard Inside	P	Transport Wheels	X	Brake Cover

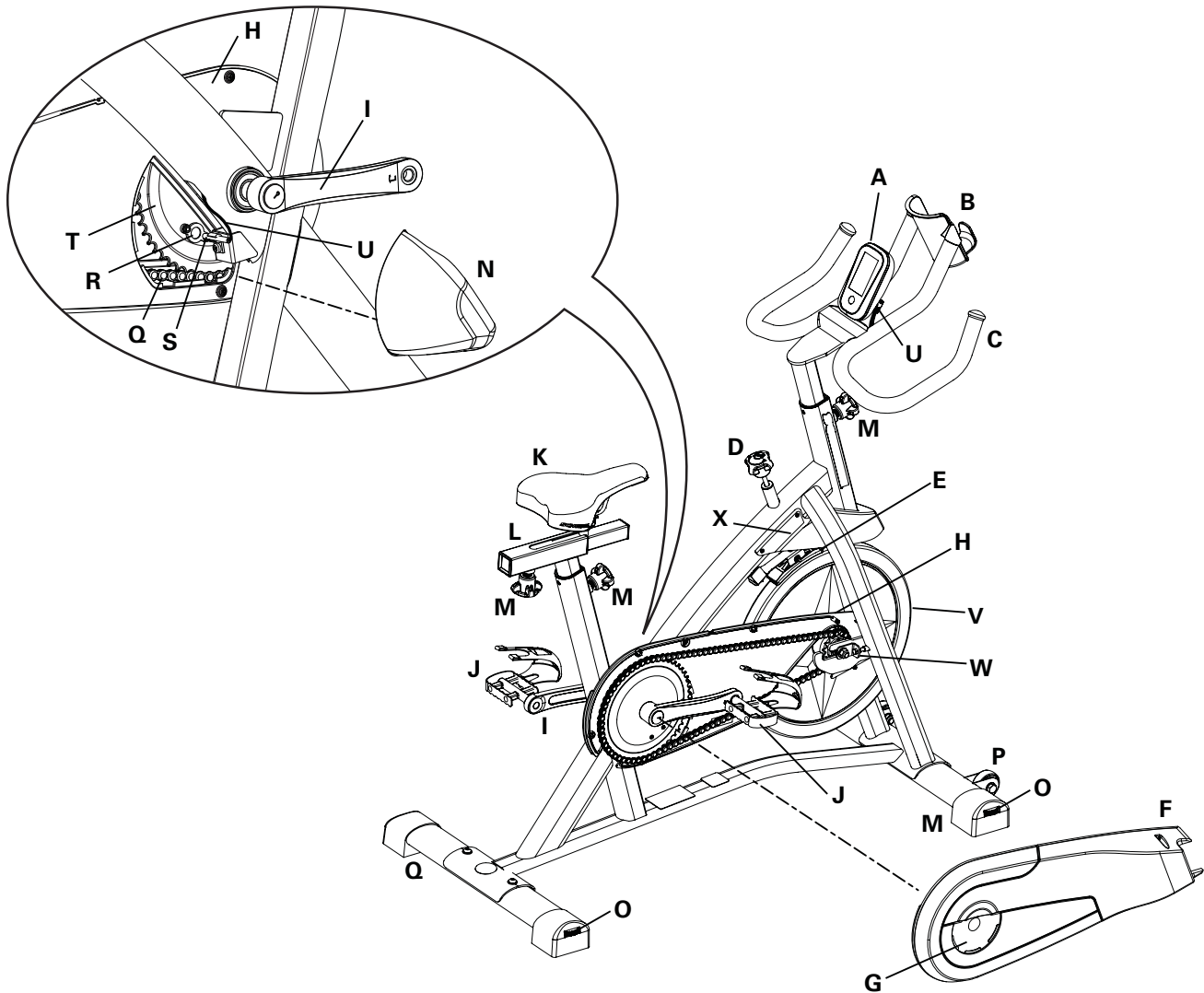

## REPLACEMENT PROCEDURE SKILL LEVEL

Level I :	Low - very little mechanical knowledge or exposure.
Level II :	Intermediate - some experience with mechanical procedures
Level III :	Advanced - knowledgeable about mechanical procedures

For instructions to replace the following parts, please refer to the Assembly Manual for your bike:

- Seat
- Seat Post
- Front Stabilizer
- Rear Stabilizer
- Water Bottle Holder

**NOTICE:** This document provides instructions for the lubrication of the Brake Pad on the Schwinn® IC2 Bike.

If you need assistance, please call Schwinn Customer Service at 1-800-605-3369.



This icon means a potentially hazardous situation which, if not avoided, could result in death or serious injury. Read and understand all Warnings on this machine.

Nautilus, Inc., (800) NAUTILUS / (800) 628-8458, [www.NautilusInc.com](http://www.NautilusInc.com) - Customer Service: North America (800) 605-3369, [csnls@nautilus.com](mailto:csnls@nautilus.com) | outside U.S. [technics@nautilus.com](mailto:technics@nautilus.com) | © 2013 Nautilus, Inc.

### Important Safety Instructions - Before servicing or using this equipment, obey the following warnings:



This icon means a potentially hazardous situation which, if not avoided, could result in death or serious injury. Read and understand all Warnings on this machine.

- Read and understand the Part Replacement Procedure before working on the machine. Failure to obey the instructions and safety warnings could cause injury to the service technician or bystanders.
- Keep bystanders and children away from the product being serviced at all times.
- Make sure that the repair is done in an appropriate work space away from foot traffic and exposure to bystanders.
- Some components of the equipment can be heavy or awkward. Enlist the service of a second person when you do maintenance steps involving these components. Do not try to do heavy or awkward steps on your own.
- If replacement parts are necessary, use only genuine Nautilus replacement parts and hardware. Failure to use genuine replacement parts can cause a risk to users, keep the machine from operating correctly and void the warranty.
- Be sure that all warning stickers and instructional placards applied to the product stay present and in good condition when doing maintenance or replacing components. If necessary request replacement warning stickers or placards from Nautilus customer service.
- Do not try to change the design or functionality of the machine being serviced as this can adversely affect user safety.
- Do not use the machine until all shrouds, instructions, warning labels and correct functionality have been verified and tested for correct performance.

### Tools Required (not included)

#2 Phillips screwdriver



Silicone lubricant

4mm Hex key



8 mm Wrench

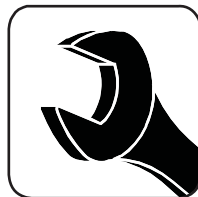



Disconnect the data cable from the console before you service this machine.

**Note:** Your machine may not match the image. For reference only.

1. Using a #2 Phillips screwdriver, loosen and remove the hardware that attaches the Brake Cover to the Main Frame. Set the Brake cover and hardware safely aside for reassembly.

**NOTICE:** Hold the Brake Cover so that it does not fall.

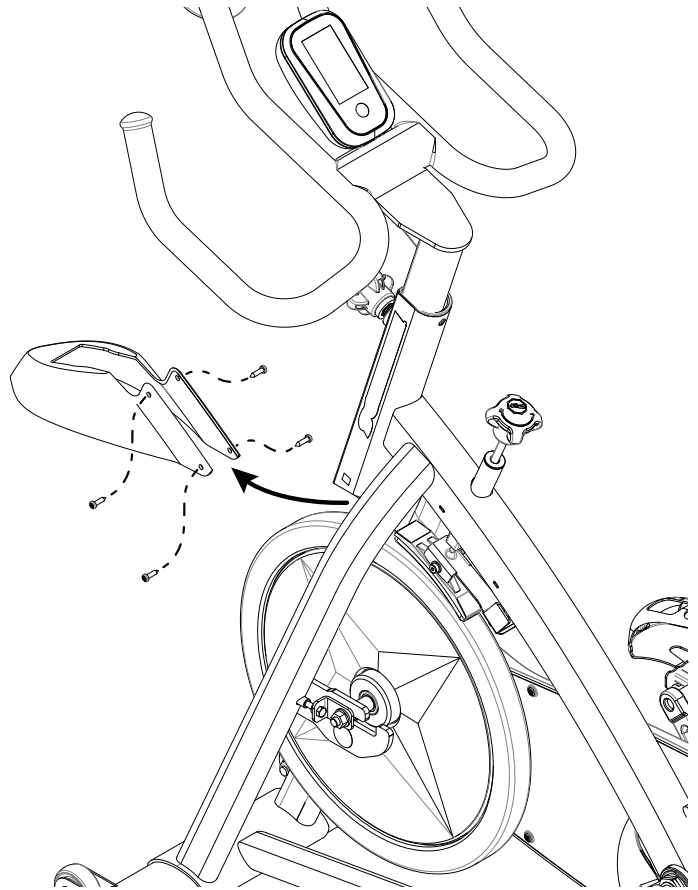

2. Loosen the Resistance Knob (A) to the minimum resistance setting.
3. Loosen and remove the hardware that attaches the Brake Pad (B) to the Brake Assembly (C).
4. Slide the Brake Pad (B) out of the Brake Assembly (C).

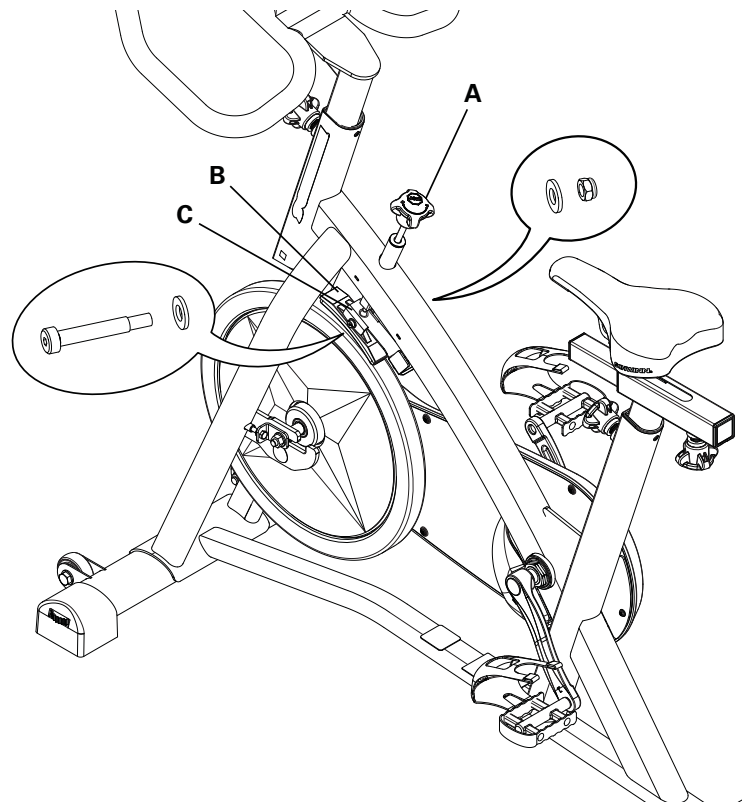



5. Saturate the Brake Pad felt (D) with silicone lubricant. Wipe off the excess lubricant to prevent drips and stains.

6. Reinstall the Brake Pad (B).

*NOTICE:* Do not crimp the cable.

7. Reinstall the Brake Cover.

*NOTICE:* Do not crimp the cable.

8. Adjust the Resistance Knob (A) as necessary.

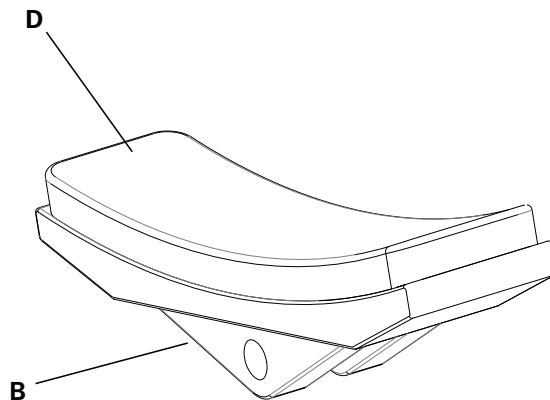

## 9. Final Inspection

Inspect your machine to ensure that all hardware is tight and components are properly assembled.



Do not use until the machine has been fully assembled and inspected for correct performance in accordance with the Owner's Manual.

**NOTICE:** This document provides instructions for the adjustment of the Brake Assembly on the Schwinn® IC2 Bike.

If you need assistance, please call Schwinn Customer Service at 1-800-605-3369.



This icon means a potentially hazardous situation which, if not avoided, could result in death or serious injury. Read and understand all Warnings on this machine.

Nautilus, Inc., (800) NAUTILUS / (800) 628-8458, [www.NautilusInc.com](http://www.NautilusInc.com) - Customer Service: North America (800) 605-3369, [csnls@nautilus.com](mailto:csnls@nautilus.com) | outside U.S. [technics@nautilus.com](mailto:technics@nautilus.com) | © 2013 Nautilus, Inc.

### Important Safety Instructions - Before servicing or using this equipment, obey the following warnings:



This icon means a potentially hazardous situation which, if not avoided, could result in death or serious injury. Read and understand all Warnings on this machine.

- Read and understand the Part Replacement Procedure before working on the machine. Failure to obey the instructions and safety warnings could cause injury to the service technician or bystanders.
- Keep bystanders and children away from the product being serviced at all times.
- Make sure that the repair is done in an appropriate work space away from foot traffic and exposure to bystanders.
- Some components of the equipment can be heavy or awkward. Enlist the service of a second person when you do maintenance steps involving these components. Do not try to do heavy or awkward steps on your own.
- If replacement parts are necessary, use only genuine Nautilus replacement parts and hardware. Failure to use genuine replacement parts can cause a risk to users, keep the machine from operating correctly and void the warranty.
- Be sure that all warning stickers and instructional placards applied to the product stay present and in good condition when doing maintenance or replacing components. If necessary request replacement warning stickers or placards from Nautilus customer service.
- Do not try to change the design or functionality of the machine being serviced as this can adversely affect user safety.
- Do not use the machine until all shrouds, instructions, warning labels and correct functionality have been verified and tested for correct performance.

### Tools Required (not included)

#2 Phillips screwdriver

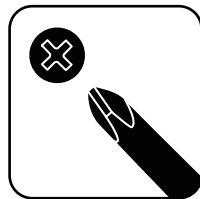

3 mm Hex key



Small flathead screwdriver





Disconnect the data cable from the console before you service this machine.

**Note:** Your machine may not match the image. For reference only.

1. Using a #2 Phillips screwdriver, loosen and remove the hardware that attaches the Brake Cover to the Main Frame. Set the Brake cover and hardware safely aside for reassembly.

**NOTICE:** Hold the Brake Cover so that it does not fall.

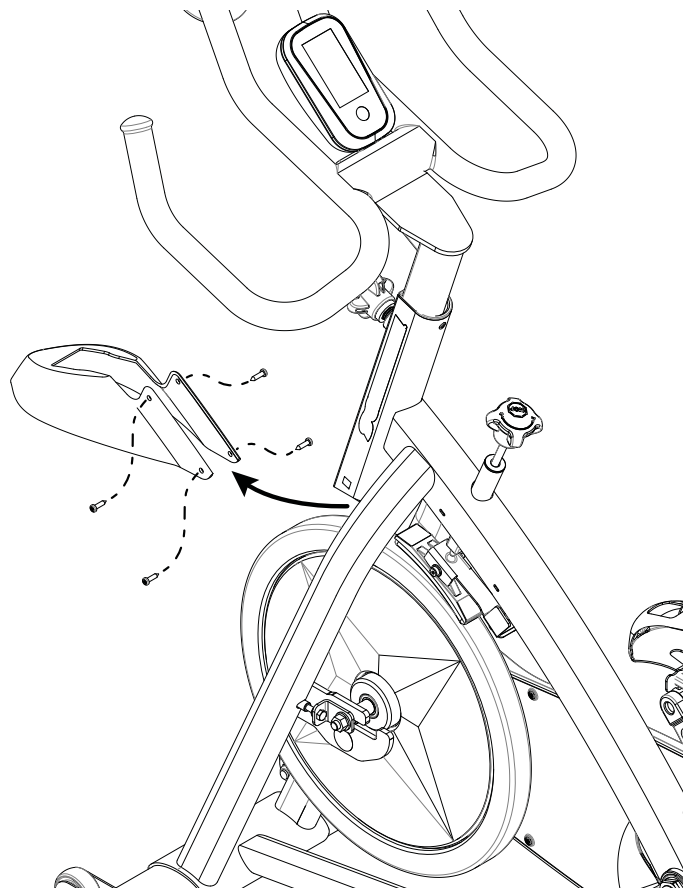

2. Loosen the Resistance Knob (A) to the minimum resistance setting.

3. Using a 3mm hex key, loosen the hardware (B1) that attaches the Brake Assembly (B) to the Frame Mount (C). The screw holes in the Brake Assembly arm are slots to let you adjust the position of the arm on the Frame Mount.

**Note:** The nuts may turn along with the screws when you try to loosen the hardware (B1). To hold the nut stable, wedge a small flathead screwdriver diagonally between the nut and the inside of the Frame Mount bracket (C).

4. Move the Brake Assembly (B) on the Frame Mount (C) as necessary. Hold it in position and tighten the hardware.

5. Tighten the Resistance Knob (A) and inspect the Brake Assembly movement. Adjust the Brake as necessary.

6. Reinstall the Brake Cover.

**NOTICE:** Do not crimp the cable.

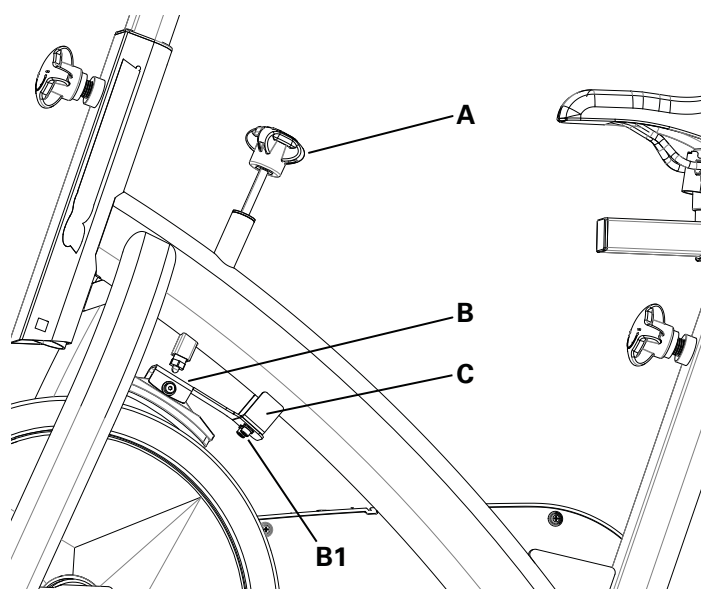

## 7. Final Inspection

Inspect your machine to ensure that all hardware is tight and components are properly assembled.



Do not use until the machine has been fully assembled and inspected for correct performance in accordance with the Owner's Manual.

**NOTICE:** This document provides instructions for the adjustment of the Drive Chain Tension on the Schwinn® IC2 Bike.

If you need assistance, please call Schwinn Customer Service at 1-800-605-3369.



This icon means a potentially hazardous situation which, if not avoided, could result in death or serious injury. Read and understand all Warnings on this machine.

Nautilus, Inc., (800) NAUTILUS / (800) 628-8458, www.NautilusInc.com - Customer Service: North America (800) 605-3369, csnl@s@nautilus.com | outside U.S. technics@nautilus.com | © 2013 Nautilus, Inc.

### Important Safety Instructions - Before servicing or using this equipment, obey the following warnings:



This icon means a potentially hazardous situation which, if not avoided, could result in death or serious injury. Read and understand all Warnings on this machine.

- Read and understand the Part Replacement Procedure before working on the machine. Failure to obey the instructions and safety warnings could cause injury to the service technician or bystanders.
- Keep bystanders and children away from the product being serviced at all times.
- Make sure that the repair is done in an appropriate work space away from foot traffic and exposure to bystanders.
- Some components of the equipment can be heavy or awkward. Enlist the service of a second person when you do maintenance steps involving these components. Do not try to do heavy or awkward steps on your own.
- If replacement parts are necessary, use only genuine Nautilus replacement parts and hardware. Failure to use genuine replacement parts can cause a risk to users, keep the machine from operating correctly and void the warranty.
- Be sure that all warning stickers and instructional placards applied to the product stay present and in good condition when doing maintenance or replacing components. If necessary request replacement warning stickers or placards from Nautilus customer service.
- Do not try to change the design or functionality of the machine being serviced as this can adversely affect user safety.
- Do not use the machine until all shrouds, instructions, warning labels and correct functionality have been verified and tested for correct performance.

### Tools Required (not included)

Pedal wrench



15 mm Wrench  
10 mm Wrench



#2 Phillips screwdriver



15 mm Socket and  
Wrench



Flathead screwdriver





Disconnect the data cable from the console before you service this machine.

**Note:** Your machine may not match the image. For reference only.

1. Loosen and remove the right Pedal. Set it safely aside for reassembly.

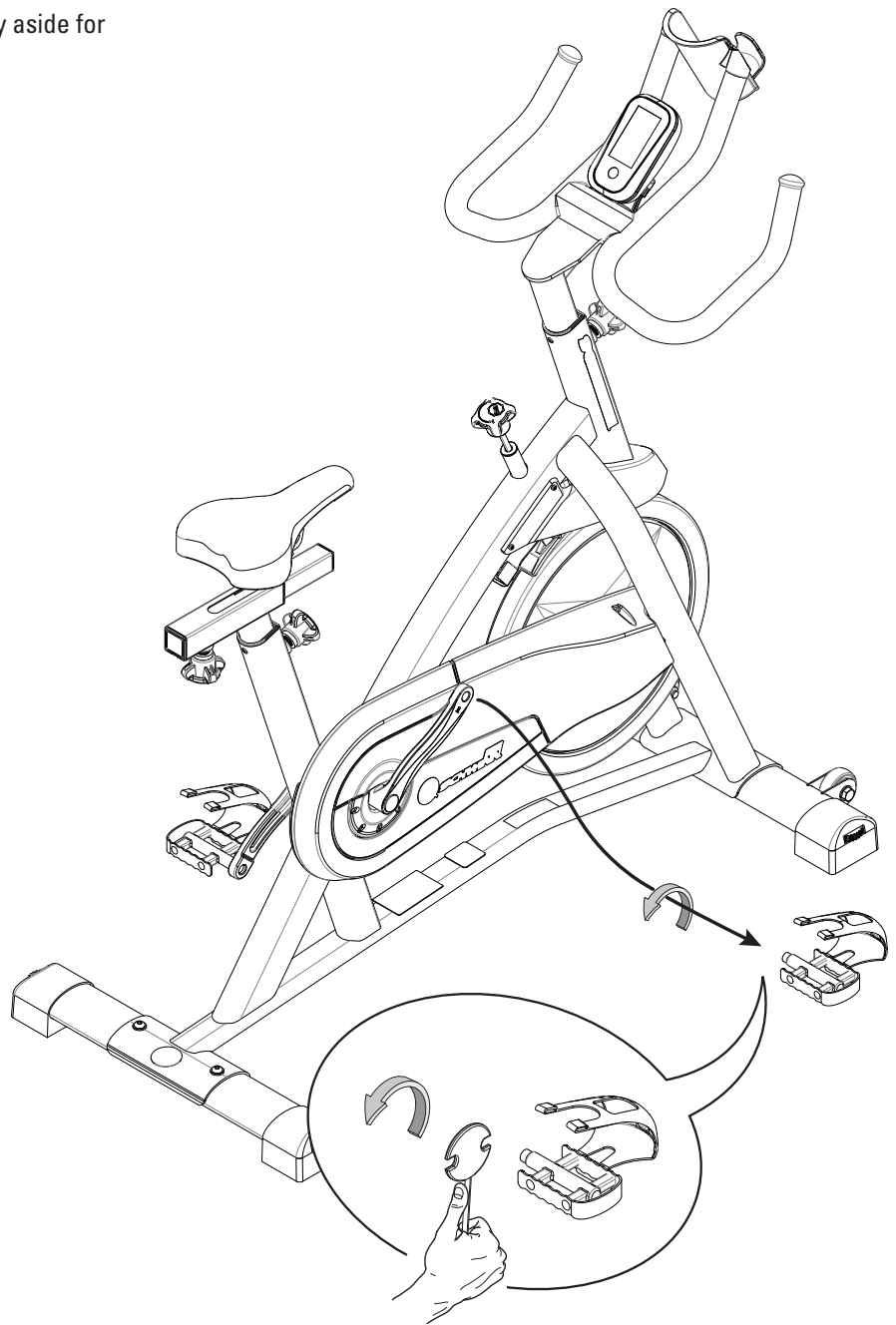

- 2.** Carefully remove the Chain Guard Center from the Chain Guard Cover, and set it safely aside for reassembly.

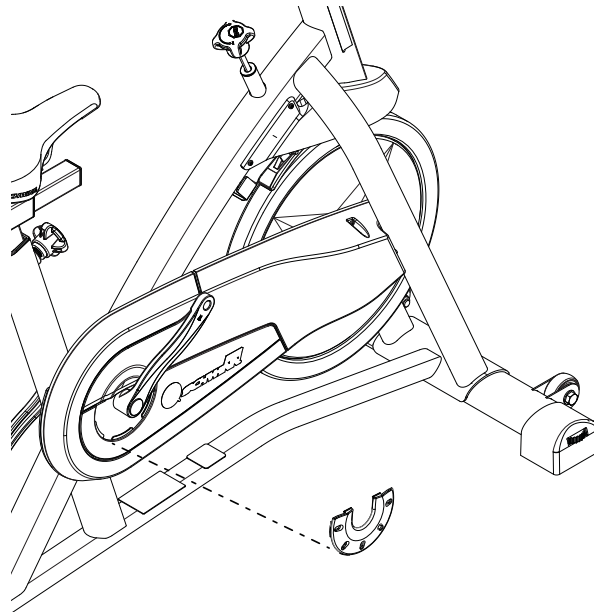

- 3.** Remove the hardware that attaches the Chain Guard Cover to the Chain Guard Inside, and set it safely aside for reassembly. Carefully remove the Chain Guard Cover and set it safely aside for reassembly.

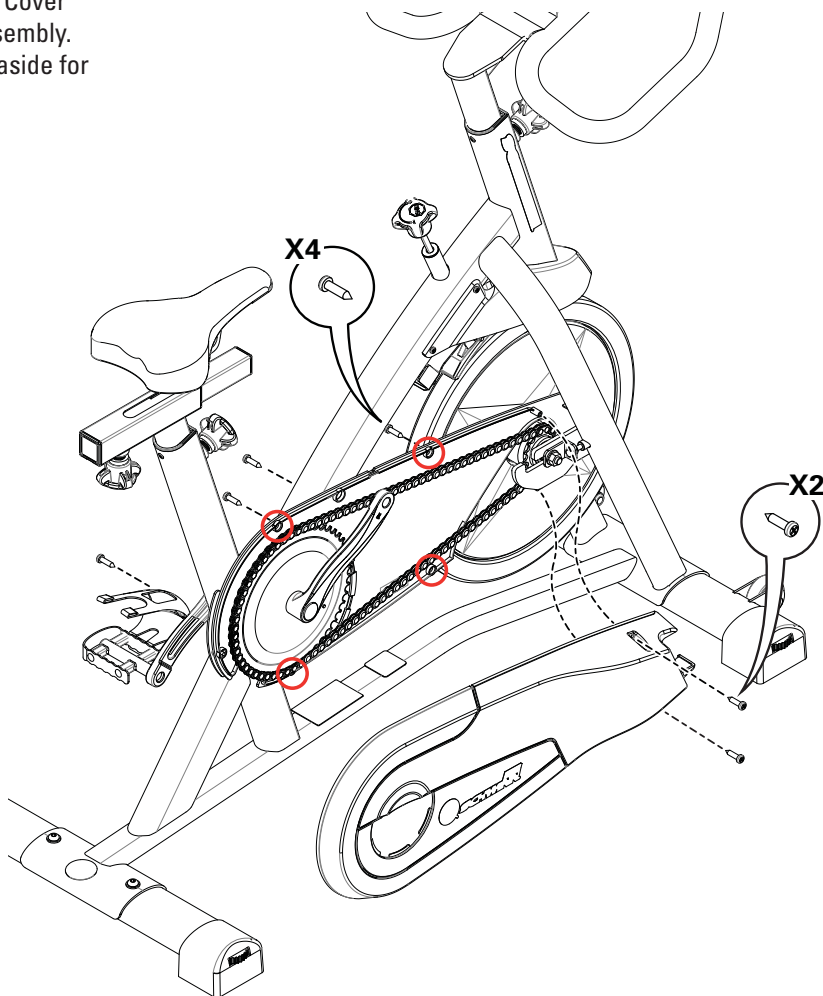

4. Use a 15 mm crescent wrench to hold the Axle Nut (B) on one side steady and loosen the Axle Nut on the opposite side with a 15 mm socket and wrench.



Be sure to keep fingers clear of all pinch hazards.

5. Check the tension:

Find the point where the Drive Chain (A) is tightest during one revolution of the Crank (C). You should be able to move the chain up and down about 3/8" (in either direction).

If the Drive Chain is too loose—use a 10mm wrench to turn each Flywheel Retainer bolt (D) 1/4 turn to the right.

If the Drive Chain is too tight—use a 10mm wrench to adjust the Flywheel Retainer bolts (D).

6. Reinstall the right Pedal. Carefully align the threads and hand tighten to prevent crossthreading. Then tighten fully with pedal wrench.

7. Get on the bike and check the movement of the Drive Chain (A) by rocking back and forth on the pedals. The Pedals and Flywheel (E) should move as one.

Adjust the Drive Chain tension again if necessary.

8. Tighten the Axle Nuts (B) when the Drive Chain tension is correct.

**NOTICE:** Make sure the Flywheel (E) is aligned with the Frame. Be sure the Flywheel axle does not touch the Chain Guard Inside.

9. Remove the right Pedal. Reinstall the Chain Guard Cover, Chain Guard Center and Pedal.

## 10. Final Inspection

Inspect your machine to ensure that all hardware is tight and components are properly assembled.



Do not use until the machine has been fully assembled and inspected for correct performance in accordance with the Owner's Manual.

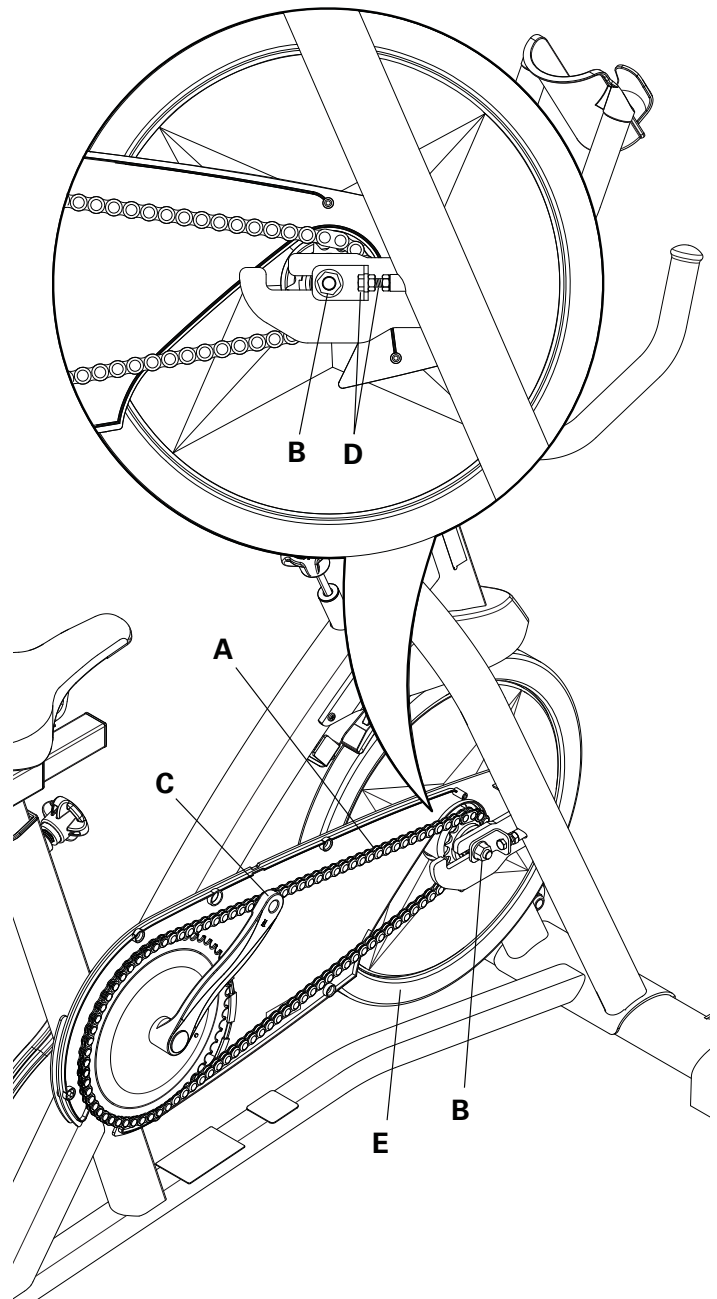

**NOTICE:** This document provides instructions for the replacement of the Pedals on the Schwinn® IC2 Bike.

If you need assistance, please call Schwinn Customer Service at 1-800-605-3369.



This icon means a potentially hazardous situation which, if not avoided, could result in death or serious injury. Read and understand all Warnings on this machine.

Nautilus, Inc., (800) NAUTILUS / (800) 628-8458, [www.NautilusInc.com](http://www.NautilusInc.com) - Customer Service: North America (800) 605-3369, [csnls@nautilus.com](mailto:csnls@nautilus.com) | outside U.S. [technics@nautilus.com](mailto:technics@nautilus.com) | © 2013 Nautilus, Inc.

### Important Safety Instructions - Before servicing or using this equipment, obey the following warnings:



This icon means a potentially hazardous situation which, if not avoided, could result in death or serious injury. Read and understand all Warnings on this machine.

- Read and understand the Part Replacement Procedure before working on the machine. Failure to obey the instructions and safety warnings could cause injury to the service technician or bystanders.
- Keep bystanders and children away from the product being serviced at all times.
- Make sure that the repair is done in an appropriate work space away from foot traffic and exposure to bystanders.
- Some components of the equipment can be heavy or awkward. Enlist the service of a second person when you do maintenance steps involving these components. Do not try to do heavy or awkward steps on your own.
- If replacement parts are necessary, use only genuine Nautilus replacement parts and hardware. Failure to use genuine replacement parts can cause a risk to users, keep the machine from operating correctly and void the warranty.
- Be sure that all warning stickers and instructional placards applied to the product stay present and in good condition when doing maintenance or replacing components. If necessary request replacement warning stickers or placards from Nautilus customer service.
- Do not try to change the design or functionality of the machine being serviced as this can adversely affect user safety.
- Do not use the machine until all shrouds, instructions, warning labels and correct functionality have been verified and tested for correct performance.

### Tools Required (not included)

Pedal wrench







Disconnect the data cable from the console before you service this machine.

**Note:** Your machine may not match the image. For reference only.

1. Loosen and remove the old Pedals.  
Discard the old Pedals.

**Note: The Left Pedal is reverse-threaded.**

Orientation is based from a seated position on the bike. The Left Pedal has an "L", the Right Pedal an "R".

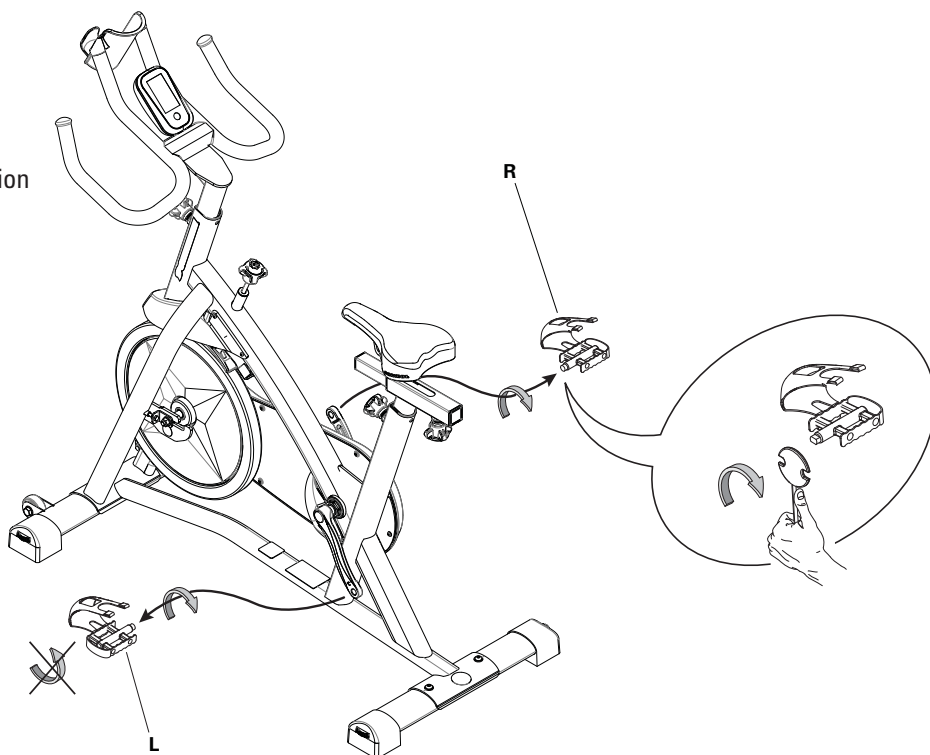

2. Install the new Pedals. Carefully align the threads and hand tighten to prevent crossthreading. Then tighten fully with pedal wrench.

**Note: The Left Pedal is reverse-threaded.** Be sure to attach Pedals on the correct side of the Bike. Orientation is based from a seated position on the bike. The Left Pedal has an "L", the Right Pedal an "R".

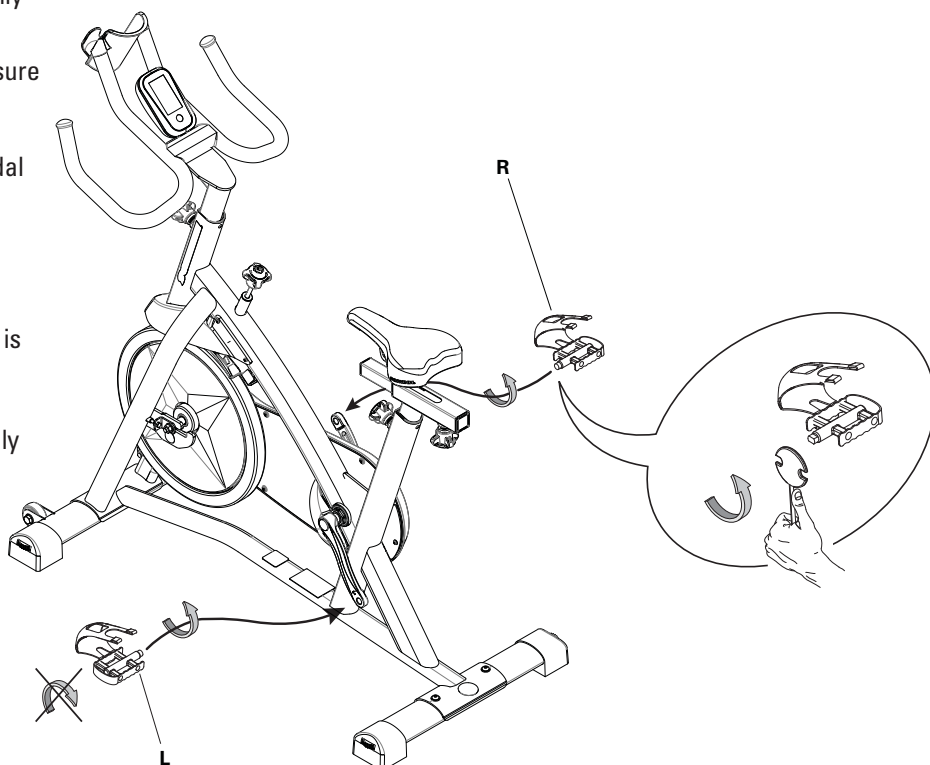

### 3. Final Inspection

Inspect your machine to ensure that all hardware is tight and components are properly assembled.



Do not use until the machine has been fully assembled and inspected for correct performance in accordance with the Owner's Manual.

**NOTICE:** This document provides instructions for the replacement of the Console on the Schwinn® IC2 Bike.

**If you need assistance, please call Schwinn® Customer Service at 1-800-605-3369.**



This icon means a potentially hazardous situation which, if not avoided, could result in death or serious injury. Read and understand all Warnings on this machine.

Nautilus, Inc., (800) NAUTILUS / (800) 628-8458, [www.NautilusInc.com](http://www.NautilusInc.com) - Customer Service: North America (800) 605-3369, [csnls@nautilus.com](mailto:csnls@nautilus.com) | outside U.S. [technics@nautilus.com](mailto:technics@nautilus.com) | © 2013 Nautilus, Inc.

### **Important Safety Instructions - Before servicing or using this equipment, obey the following warnings:**



This icon means a potentially hazardous situation which, if not avoided, could result in death or serious injury. Read and understand all Warnings on this machine.

- Read and understand the Part Replacement Procedure before working on the machine. Failure to obey the instructions and safety warnings could cause injury to the service technician or bystanders.
- Keep bystanders and children away from the product being serviced at all times.
- Make sure that the repair is done in an appropriate work space away from foot traffic and exposure to bystanders.
- Some components of the equipment can be heavy or awkward. Enlist the service of a second person when you do maintenance steps involving these components. Do not try to do heavy or awkward steps on your own.
- If replacement parts are necessary, use only genuine Nautilus replacement parts and hardware. Failure to use genuine replacement parts can cause a risk to users, keep the machine from operating correctly and void the warranty.
- Be sure that all warning stickers and instructional placards applied to the product stay present and in good condition when doing maintenance or replacing components. If necessary request replacement warning stickers or placards from Nautilus customer service.
- Do not try to change the design or functionality of the machine being serviced as this can adversely affect user safety.
- Do not use the machine until all shrouds, instructions, warning labels and correct functionality have been verified and tested for correct performance.

### **Tools Required (not included)**

2 AA batteries (LR6)





Disconnect the data cable from the console before you service this machine.

**Note:** Your machine may not match the image. For reference only.

1. Be sure the Data Cable is disconnected from the back of the Console. Remove the Console from the Console Bracket. Discard the old Console.

**NOTICE:** Do not crimp the cable.

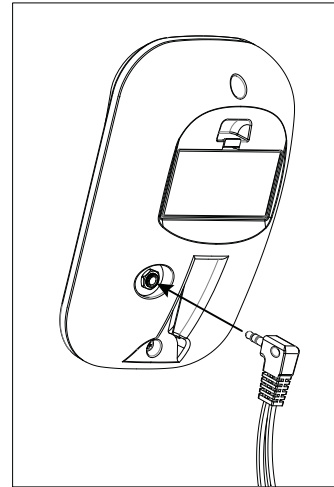

2. Install batteries in the replacement Console.

**Note:** The console uses AA size batteries (LR6), which are not included. Make sure that the batteries point in the direction of the +/– indicators in the battery bay.



Do not mix old and new batteries.

Do not mix alkaline, standard (carbon-zinc), or rechargeable (Ni-Cd, Ni-MH, etc) batteries.

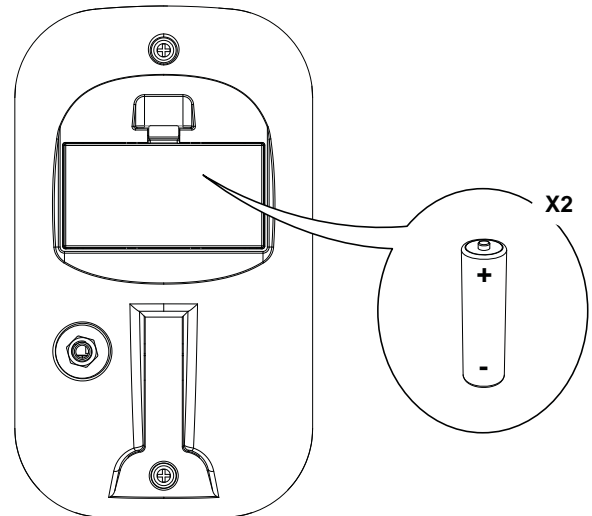

3. Slide the replacement Console into position on the Console Bracket and connect the Data Cable.

**NOTICE:** Do not crimp the cable.

#### 4. Final Inspection

Inspect your machine to ensure that all hardware is tight and components are properly assembled.



Do not use until the machine has been fully assembled and inspected for correct performance in accordance with the Owner's Manual.

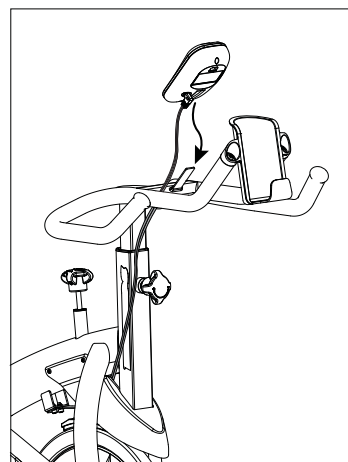

**NOTICE:** This document provides instructions for the replacement of the Handlebar and Handlebar Post on the Schwinn® IC2 Bike.

If you need assistance, please call Schwinn Customer Service at 1-800-605-3369.



This icon means a potentially hazardous situation which, if not avoided, could result in death or serious injury. Read and understand all Warnings on this machine.

Nautilus, Inc., (800) NAUTILUS / (800) 628-8458, www.NautilusInc.com - Customer Service: North America (800) 605-3369, csnl@s@nautilus.com | outside U.S. technics@nautilus.com | © 2013 Nautilus, Inc.

### Important Safety Instructions - Before servicing or using this equipment, obey the following warnings:



This icon means a potentially hazardous situation which, if not avoided, could result in death or serious injury. Read and understand all Warnings on this machine.

- Read and understand the Part Replacement Procedure before working on the machine. Failure to obey the instructions and safety warnings could cause injury to the service technician or bystanders.
- Keep bystanders and children away from the product being serviced at all times.
- Make sure that the repair is done in an appropriate work space away from foot traffic and exposure to bystanders.
- Some components of the equipment can be heavy or awkward. Enlist the service of a second person when you do maintenance steps involving these components. Do not try to do heavy or awkward steps on your own.
- If replacement parts are necessary, use only genuine Nautilus replacement parts and hardware. Failure to use genuine replacement parts can cause a risk to users, keep the machine from operating correctly and void the warranty.
- Be sure that all warning stickers and instructional placards applied to the product stay present and in good condition when doing maintenance or replacing components. If necessary request replacement warning stickers or placards from Nautilus customer service.
- Do not try to change the design or functionality of the machine being serviced as this can adversely affect user safety.
- Do not use the machine until all shrouds, instructions, warning labels and correct functionality have been verified and tested for correct performance.

### Tools Required (not included)

#2 Phillips screwdriver

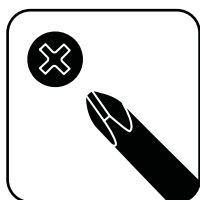

6mm Hex key





Disconnect the data cable from the console before you service this machine.

**Note:** Your machine may not match the image. For reference only.

**1.** Be sure the Data Cable is disconnected from the back of the Console. Carefully remove the Console, and set it safely aside for reassembly.

*NOTICE:* Do not crimp the cable.

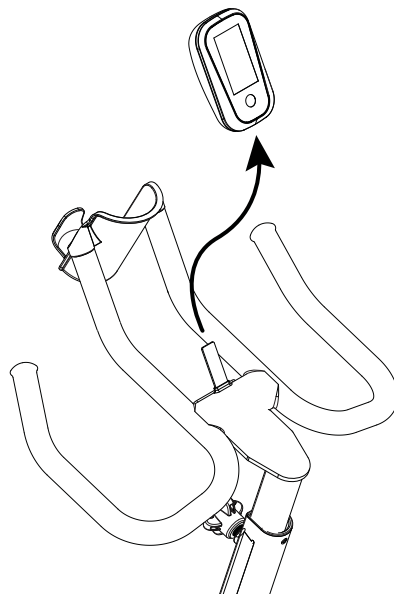

**2.** Loosen and remove the hardware that attaches the Water Bottle Holder, and set it safely aside for reassembly. Remove the Water Bottle Holder, and set it safely aside for reassembly.

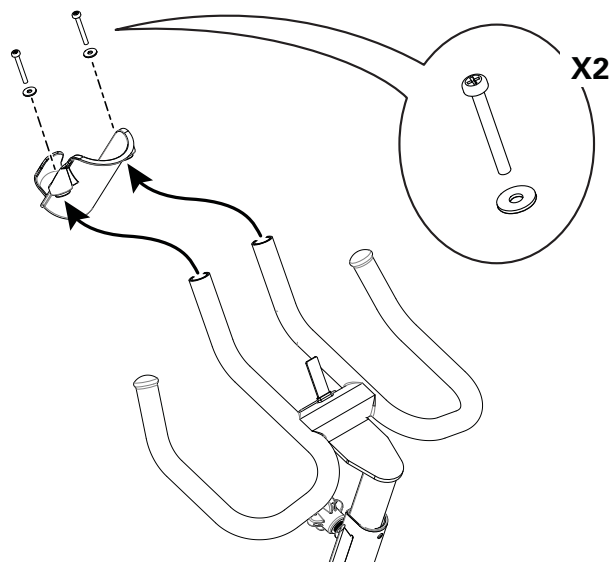

**3.** Loosen and pull the Adjustment Knob (A) that holds the Handlebar Post in position in the Main Frame.

 Hold the Handlebar so that it does not fall.

**4.** Remove the Handlebar assembly from the Main Frame.

*NOTICE:* Do not crimp the cable.

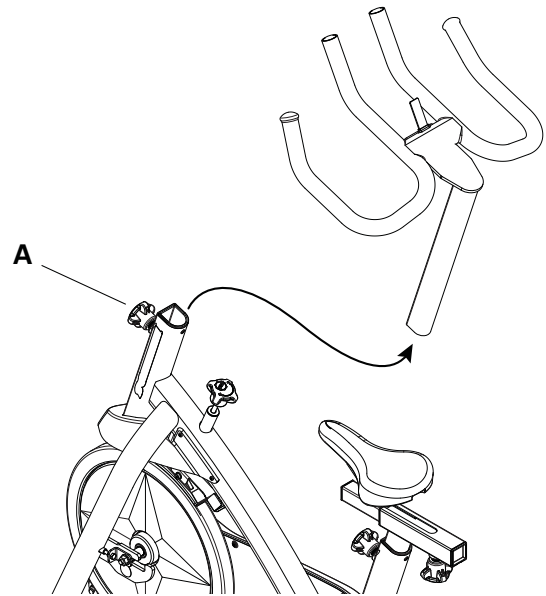

**5.** Loosen and remove the hardware that attaches the Handlebar to the Handlebar Post. Set the hardware safely aside for reassembly.

**6.** Discard the old part.

**7.** Installation is the reverse procedure.

*NOTICE:* Make sure that the Adjustment Knob engages the holes in the Handlebar Post.

## **8. Final Inspection**

Inspect your machine to ensure that all hardware is tight and components are properly assembled.

 Do not use until the machine has been fully assembled and inspected for correct performance in accordance with the Owner's Manual.

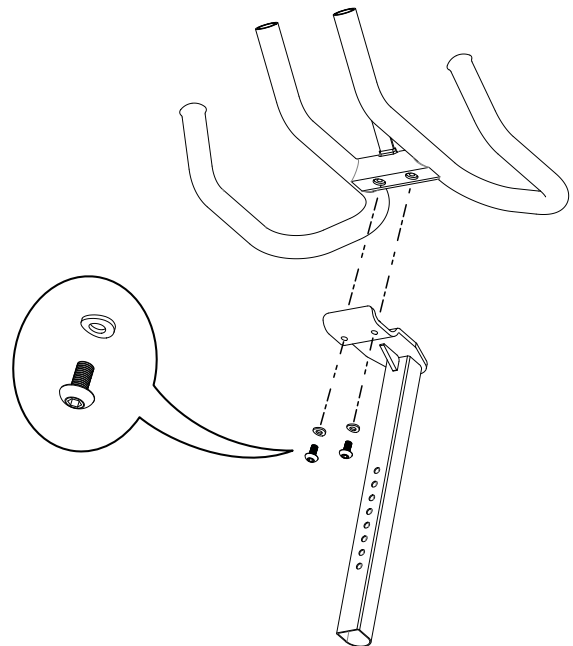

**NOTICE:** This document provides instructions for the replacement of the Brake Cover on the Schwinn® IC2 Bike.

If you need assistance, please call Schwinn Customer Service at 1-800-605-3369.



This icon means a potentially hazardous situation which, if not avoided, could result in death or serious injury. Read and understand all Warnings on this machine.

Nautilus, Inc., (800) NAUTILUS / (800) 628-8458, [www.NautilusInc.com](http://www.NautilusInc.com) - Customer Service: North America (800) 605-3369, [csnls@nautilus.com](mailto:csnls@nautilus.com) | outside U.S. [technics@nautilus.com](mailto:technics@nautilus.com) | © 2013 Nautilus, Inc.

### Important Safety Instructions - Before servicing or using this equipment, obey the following warnings:



This icon means a potentially hazardous situation which, if not avoided, could result in death or serious injury. Read and understand all Warnings on this machine.

- Read and understand the Part Replacement Procedure before working on the machine. Failure to obey the instructions and safety warnings could cause injury to the service technician or bystanders.
- Keep bystanders and children away from the product being serviced at all times.
- Make sure that the repair is done in an appropriate work space away from foot traffic and exposure to bystanders.
- Some components of the equipment can be heavy or awkward. Enlist the service of a second person when you do maintenance steps involving these components. Do not try to do heavy or awkward steps on your own.
- If replacement parts are necessary, use only genuine Nautilus replacement parts and hardware. Failure to use genuine replacement parts can cause a risk to users, keep the machine from operating correctly and void the warranty.
- Be sure that all warning stickers and instructional placards applied to the product stay present and in good condition when doing maintenance or replacing components. If necessary request replacement warning stickers or placards from Nautilus customer service.
- Do not try to change the design or functionality of the machine being serviced as this can adversely affect user safety.
- Do not use the machine until all shrouds, instructions, warning labels and correct functionality have been verified and tested for correct performance.

### Tools Required (not included)

#2 Phillips screwdriver

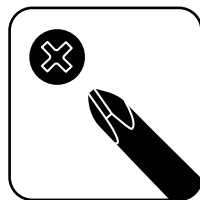



Disconnect the data cable from the console before you service this machine.

**Note:** Your machine may not match the image. For reference only.

1. Loosen and remove the hardware that attaches the Brake Cover to the Main Frame. Set the hardware safely aside for reassembly.

*NOTICE:* Hold the Brake Cover so that it does not fall.

2. Carefully remove the old Brake Cover and discard.

*NOTICE:* Do not crimp the cable.

3. Installation is the reverse procedure.

*NOTICE:* Do not crimp the cable.

#### 4. Final Inspection

Inspect your machine to ensure that all hardware is tight and components are properly assembled.



Do not use until the machine has been fully assembled and inspected for correct performance in accordance with the Owner's Manual.

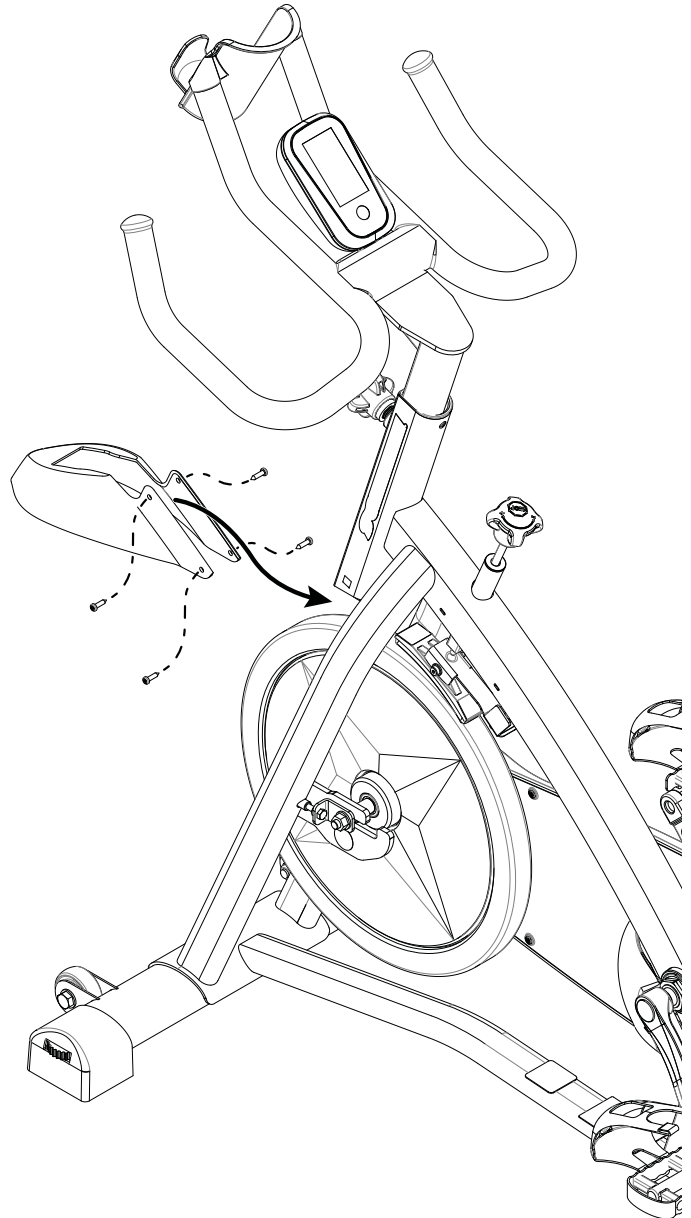



**NOTICE:** This document provides instructions for the replacement of the Brake Assembly and the Resistance Knob Assembly on the Schwinn® IC2 Bike.

**If you need assistance, please call Schwinn Customer Service at 1-800-605-3369.**



This icon means a potentially hazardous situation which, if not avoided, could result in death or serious injury. Read and understand all Warnings on this machine.

Nautilus, Inc., (800) NAUTILUS / (800) 628-8458, www.NautilusInc.com - Customer Service: North America (800) 605-3369, csnls@nautilus.com | outside U.S. technics@nautilus.com | Printed in China | © 2013 Nautilus, Inc.

**Important Safety Instructions - Before servicing or using this equipment, obey the following warnings:**



This icon means a potentially hazardous situation which, if not avoided, could result in death or serious injury. Read and understand all Warnings on this machine.

- Read and understand the Part Replacement Procedure before working on the machine. Failure to obey the instructions and safety warnings could cause injury to the service technician or bystanders.
- Keep bystanders and children away from the product being serviced at all times.
- Make sure that the repair is done in an appropriate work space away from foot traffic and exposure to bystanders.
- Some components of the equipment can be heavy or awkward. Enlist the service of a second person when you do maintenance steps involving these components. Do not try to do heavy or awkward steps on your own.
- If replacement parts are necessary, use only genuine Nautilus replacement parts and hardware. Failure to use genuine replacement parts can cause a risk to users, keep the machine from operating correctly and void the warranty.
- Be sure that all warning stickers and instructional placards applied to the product stay present and in good condition when doing maintenance or replacing components. If necessary request replacement warning stickers or placards from Nautilus customer service.
- Do not try to change the design or functionality of the machine being serviced as this can adversely affect user safety.
- Do not use the machine until all shrouds, instructions, warning labels and correct functionality have been verified and tested for correct performance.

**Tools Required (not included)**

#2 Phillips screwdriver

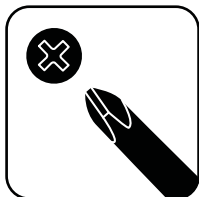

13 mm Wrench



3 mm Hex key



Small flathead screwdriver





Disconnect the data cable from the console before you service this machine.

**Note:** Your machine may not match the image. For reference only.



Keep the flywheel stable during this procedure. Do not turn the crank arms. Flywheel movement can pull fingers in and cause injury.

1. Using a #2 Phillips screwdriver, loosen and remove the hardware that attaches the Brake Cover to the Main Frame. Set the hardware safely aside for reassembly.

**NOTICE:** Hold the Brake Cover so that it does not fall.

2. Carefully remove the Brake Cover and set it safely aside for reassembly.

**NOTICE:** Do not crimp the cable.

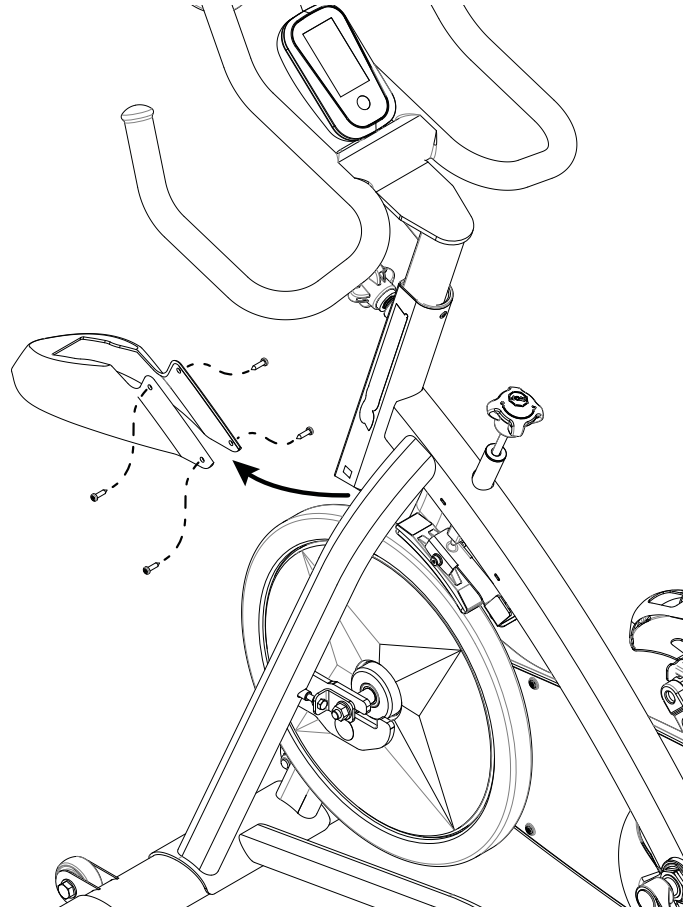

3. Loosen the Resistance Knob (A) to the minimum resistance setting.

4. Using a 3mm hex key, remove the hardware (B1) that attaches the Brake Assembly (B) to the Frame Mount (C). Set the hardware safely aside for reassembly.

**Note:** The nuts may turn along with the screws when you try to loosen the hardware (B1). To hold the nut stable, wedge a small flathead screwdriver diagonally between the nut and the inside of the Frame Mount bracket (C).

5. Remove the old Brake Assembly (B) and set it safely aside.

If you are not replacing the Resistance Knob assembly— go to step 11. Installation of the new Brake Assembly is the reverse procedure.

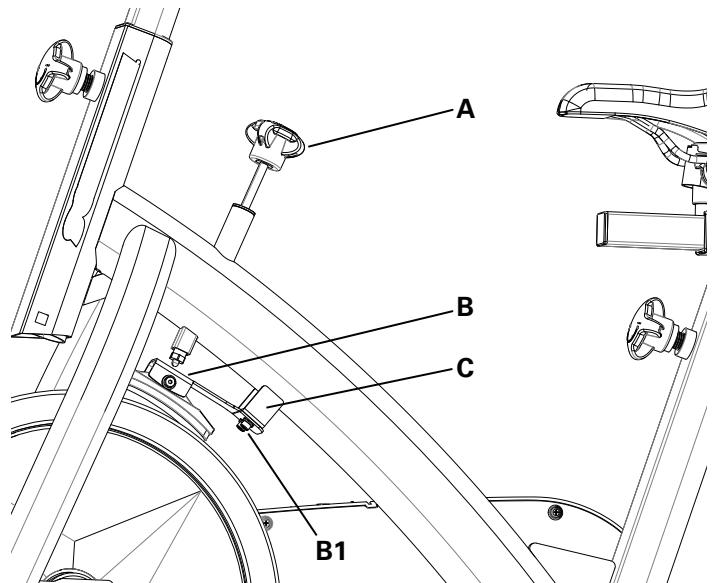

6. Remove the hex nut (D) at the end of the Resistance Knob rod (A1).

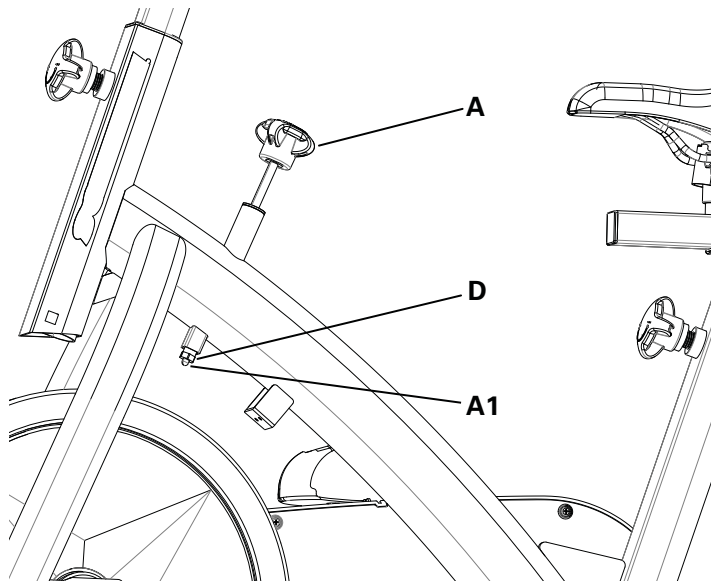

7. Loosen the Resistance Knob (A) to release the square nut (E) and spring (F) from the square mount (G) on the Frame.

8. Remove the old Resistance Knob assembly (A) and bushing (H) from the mount tube (I) on top of the Frame. Discard the old parts.

9. Installation is the reverse procedure. Carefully turn the new Resistance Knob (A) clockwise to install it through the threaded mount washer (J) inside the mount tube (I).

**Note:** Hold the square nut (E) and spring (F) so that the spring touches the washer (J) in the square mount (G) until the rod is threaded through the square nut.

10. Install the new hex nut (D) on the end of the Resistance Knob rod (A1).

11. Install the new Brake Assembly (B).

12. Adjust the Resistance Knob (A) as necessary.

### 13. Final Inspection

Inspect your machine to ensure that all hardware is tight and components are properly assembled.



Do not use until the machine has been fully assembled and inspected for correct performance in accordance with the Owner's Manual.

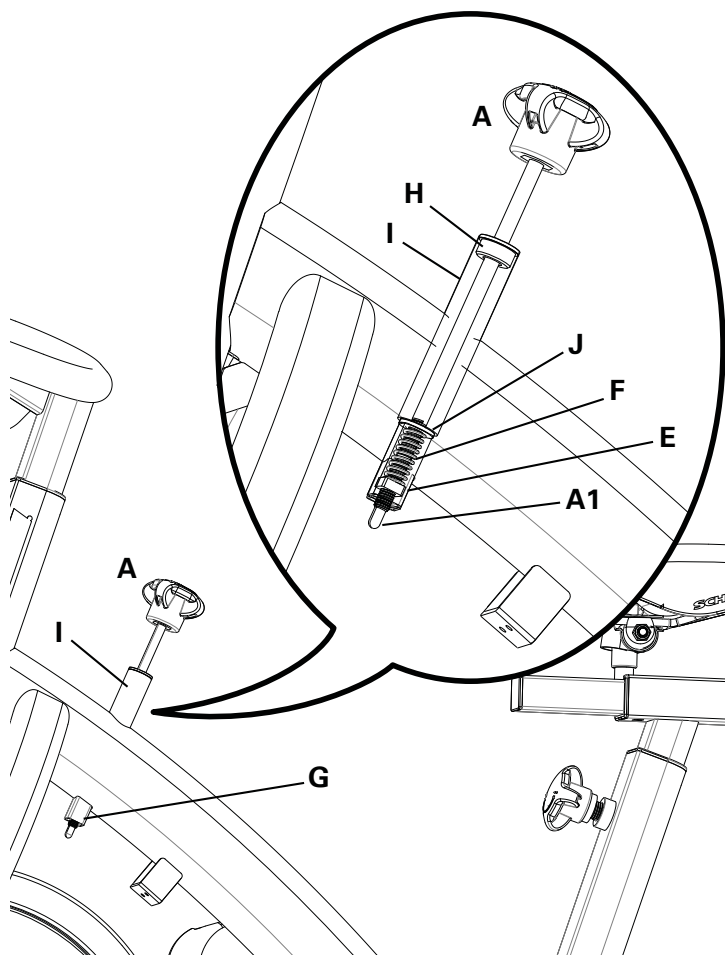

**NOTICE:** This document provides instructions for the replacement of the Left Crank Arm on the Schwinn® IC2 Bike.

If you need assistance, please call Schwinn Customer Service at 1-800-605-3369.



This icon means a potentially hazardous situation which, if not avoided, could result in death or serious injury. Read and understand all Warnings on this machine.

Nautilus, Inc., (800) NAUTILUS / (800) 628-8458, www.NautilusInc.com - Customer Service: North America (800) 605-3369, csnlis@nautilus.com | outside U.S. technics@nautilus.com | © 2013 Nautilus, Inc.

### Important Safety Instructions - Before servicing or using this equipment, obey the following warnings:



This icon means a potentially hazardous situation which, if not avoided, could result in death or serious injury. Read and understand all Warnings on this machine.

- Read and understand the Part Replacement Procedure before working on the machine. Failure to obey the instructions and safety warnings could cause injury to the service technician or bystanders.
- Keep bystanders and children away from the product being serviced at all times.
- Make sure that the repair is done in an appropriate work space away from foot traffic and exposure to bystanders.
- Some components of the equipment can be heavy or awkward. Enlist the service of a second person when you do maintenance steps involving these components. Do not try to do heavy or awkward steps on your own.
- If replacement parts are necessary, use only genuine Nautilus replacement parts and hardware. Failure to use genuine replacement parts can cause a risk to users, keep the machine from operating correctly and void the warranty.
- Be sure that all warning stickers and instructional placards applied to the product stay present and in good condition when doing maintenance or replacing components. If necessary request replacement warning stickers or placards from Nautilus customer service.
- Do not try to change the design or functionality of the machine being serviced as this can adversely affect user safety.
- Do not use the machine until all shrouds, instructions, warning labels and correct functionality have been verified and tested for correct performance.

### Tools Required (not included)

Pedal wrench



Crank Puller

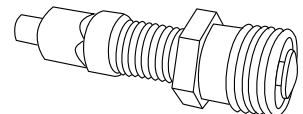

Flathead screwdriver



16mm Wrench  
or adjustable wrench



13 mm Socket and Wrench





Disconnect the data cable from the console before you service this machine.

**Note:** Your machine may not match the image. For reference only.

1. Loosen and remove the Left Pedal. Set it safely aside for reassembly.

**Note: The Left Pedal is reverse-threaded.**

Orientation is based from a seated position on the bike. The Left Pedal has an "L".

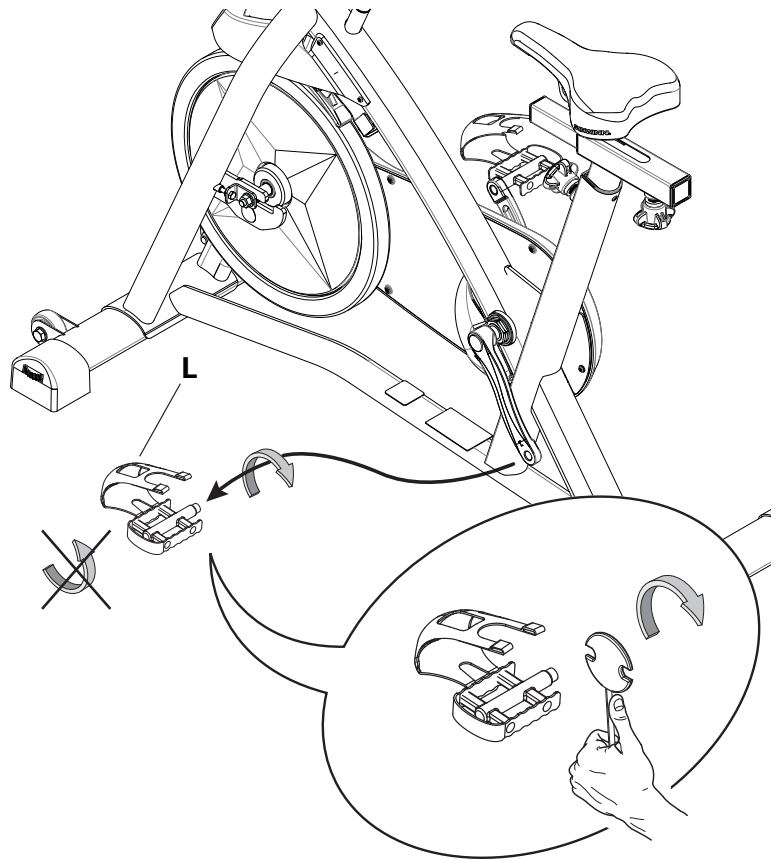

2. Using a flathead screwdriver, remove the threaded Cap (B) from the Crank Arm (A).

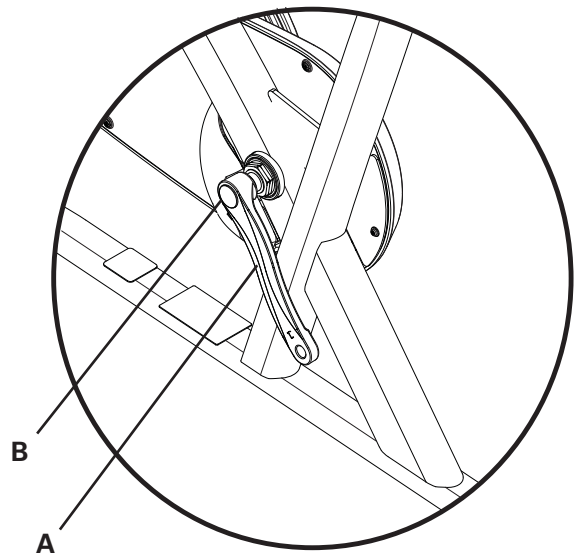

3. Using a wrench and socket, remove the Hex Head Bolt (C) under the threaded Cap (B).

4. Thread the Crank Puller into the Crank Arm (A). When the Crank Puller is in the correct position, only 1-2 threads on the outer portion (CP2) of the Crank Puller should show.

**Note:** Be sure the end of the Bolt (CP1) of the Crank Puller is flush with the Nut (CP2) as shown, before use.

5. Using a wrench, turn the inner portion (CP3) of the Crank Puller clockwise. The Crank Arm (A) will slide off as it is tightened. Discard the old parts.

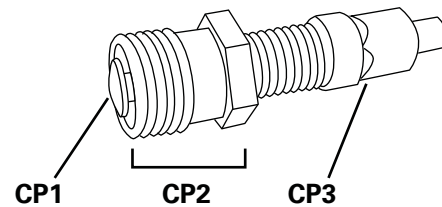
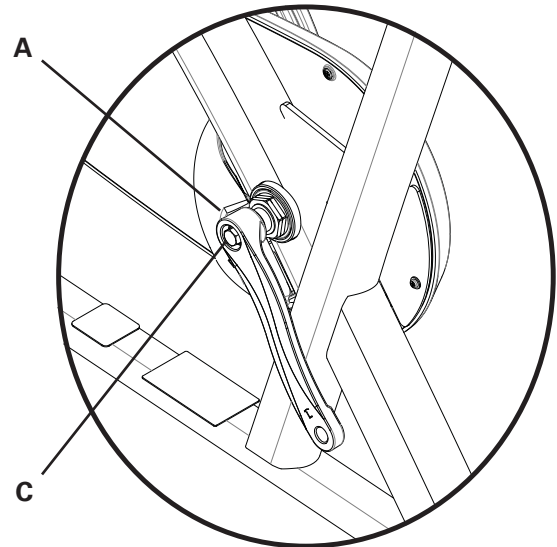

6. Installation is the reverse procedure.

## 7. Final Inspection

Inspect your machine to ensure that all hardware is tight and components are properly assembled.



Do not use until the machine has been fully assembled and inspected for correct performance in accordance with the Owner's Manual.

**NOTICE:** This document provides instructions for the replacement of the Speed Sensor on the Schwinn® IC2 Bike.

If you need assistance, please call Schwinn Customer Service at 1-800-605-3369.



This icon means a potentially hazardous situation which, if not avoided, could result in death or serious injury. Read and understand all Warnings on this machine.

Nautilus, Inc., (800) NAUTILUS / (800) 628-8458, [www.NautilusInc.com](http://www.NautilusInc.com) - Customer Service: North America (800) 605-3369, [csnls@nautilus.com](mailto:csnls@nautilus.com) | outside U.S. [technics@nautilus.com](mailto:technics@nautilus.com) | © 2013 Nautilus, Inc.

### Important Safety Instructions - Before servicing or using this equipment, obey the following warnings:



This icon means a potentially hazardous situation which, if not avoided, could result in death or serious injury. Read and understand all Warnings on this machine.

- Read and understand the Part Replacement Procedure before working on the machine. Failure to obey the instructions and safety warnings could cause injury to the service technician or bystanders.
- Keep bystanders and children away from the product being serviced at all times.
- Make sure that the repair is done in an appropriate work space away from foot traffic and exposure to bystanders.
- Some components of the equipment can be heavy or awkward. Enlist the service of a second person when you do maintenance steps involving these components. Do not try to do heavy or awkward steps on your own.
- If replacement parts are necessary, use only genuine Nautilus replacement parts and hardware. Failure to use genuine replacement parts can cause a risk to users, keep the machine from operating correctly and void the warranty.
- Be sure that all warning stickers and instructional placards applied to the product stay present and in good condition when doing maintenance or replacing components. If necessary request replacement warning stickers or placards from Nautilus customer service.
- Do not try to change the design or functionality of the machine being serviced as this can adversely affect user safety.
- Do not use the machine until all shrouds, instructions, warning labels and correct functionality have been verified and tested for correct performance.

### Tools Required (not included)

#2 Phillips screwdriver



6mm Hex key





Disconnect the data cable from the console before you service this machine.

**Note:** Your machine may not match the image. For reference only.

1. Carefully remove the Chain Guard Door, and set it safely aside for reassembly.

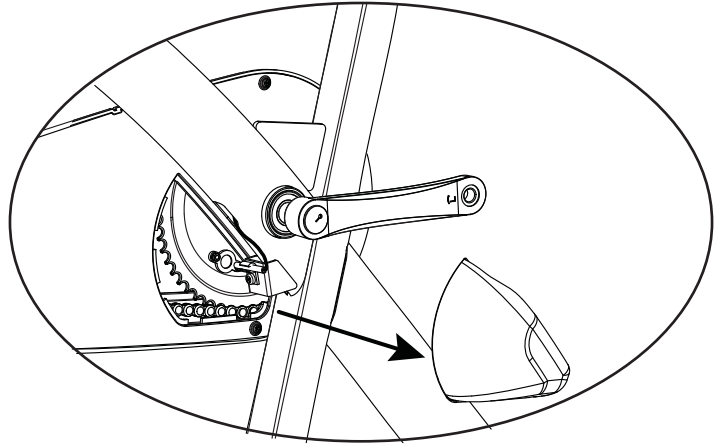

2. Disconnect the Speed Sensor cable (A) from the data cable (B) in the Frame.

**NOTICE:** Do not crimp the cable.

3. Remove the hardware (C) that attaches the Speed Sensor (D) to the Main Frame. Remove the old Speed Sensor and discard it.

4. Installation is the reverse procedure.

**NOTICE:** Do not crimp any cables.

**Note:** Before closing the Chain Guard Door, verify that the Speed Sensor (D) and Speed Sensor Magnet (E) on the Sprocket Drive do not touch.

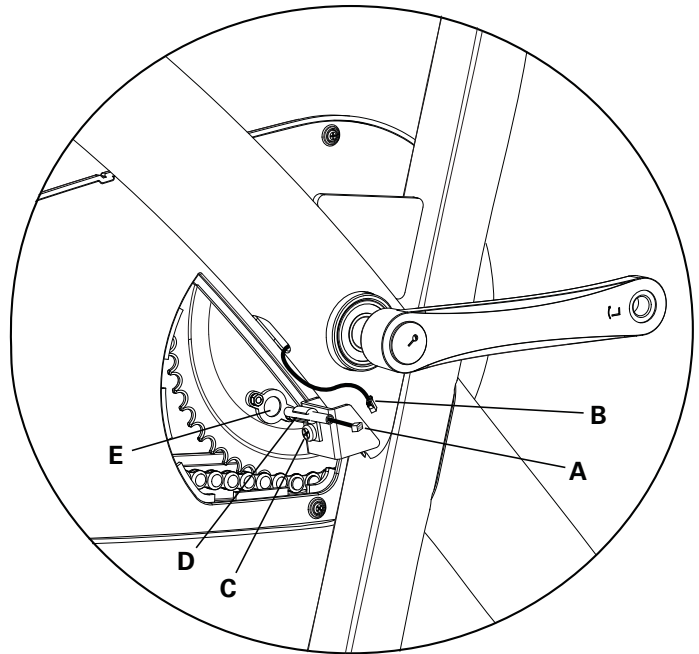

## 5. Final Inspection

Inspect your machine to ensure that all hardware is tight and components are properly assembled.



Do not use until the machine has been fully assembled and inspected for correct performance in accordance with the Owner's Manual.



**NOTICE:** This document provides instructions for the adjustment of the Drive Chain Tension on the Schwinn® IC2 Bike.

If you need assistance, please call Schwinn Customer Service at 1-800-605-3369.



This icon means a potentially hazardous situation which, if not avoided, could result in death or serious injury. Read and understand all Warnings on this machine.

Nautilus, Inc., (800) NAUTILUS / (800) 628-8458, [www.NautilusInc.com](http://www.NautilusInc.com) - Customer Service: North America (800) 605-3369, [csnls@nautilus.com](mailto:csnls@nautilus.com) | outside U.S. [technics@nautilus.com](mailto:technics@nautilus.com) | © 2013 Nautilus, Inc.

### Important Safety Instructions - Before servicing or using this equipment, obey the following warnings:



This icon means a potentially hazardous situation which, if not avoided, could result in death or serious injury. Read and understand all Warnings on this machine.

- Read and understand the Part Replacement Procedure before working on the machine. Failure to obey the instructions and safety warnings could cause injury to the service technician or bystanders.
- Keep bystanders and children away from the product being serviced at all times.
- Make sure that the repair is done in an appropriate work space away from foot traffic and exposure to bystanders.
- Some components of the equipment can be heavy or awkward. Enlist the service of a second person when you do maintenance steps involving these components. Do not try to do heavy or awkward steps on your own.
- If replacement parts are necessary, use only genuine Nautilus replacement parts and hardware. Failure to use genuine replacement parts can cause a risk to users, keep the machine from operating correctly and void the warranty.
- Be sure that all warning stickers and instructional placards applied to the product stay present and in good condition when doing maintenance or replacing components. If necessary request replacement warning stickers or placards from Nautilus customer service.
- Do not try to change the design or functionality of the machine being serviced as this can adversely affect user safety.
- Do not use the machine until all shrouds, instructions, warning labels and correct functionality have been verified and tested for correct performance.

### Tools Required (not included)

Pedal wrench



#2 Phillips screwdriver



Flathead screwdriver





Disconnect the data cable from the console before you service this machine.

**Note:** Your machine may not match the image. For reference only.

1. Loosen and remove the Pedals. Set them safely aside for reassembly.

**Note: The Left Pedal is reverse-threaded.**

Orientation is based from a seated position on the bike. The Left Pedal has an "L", the Right Pedal an "R".

2. Carefully remove the Chain Guard Door (1). Discard the old Chain Guard Door.

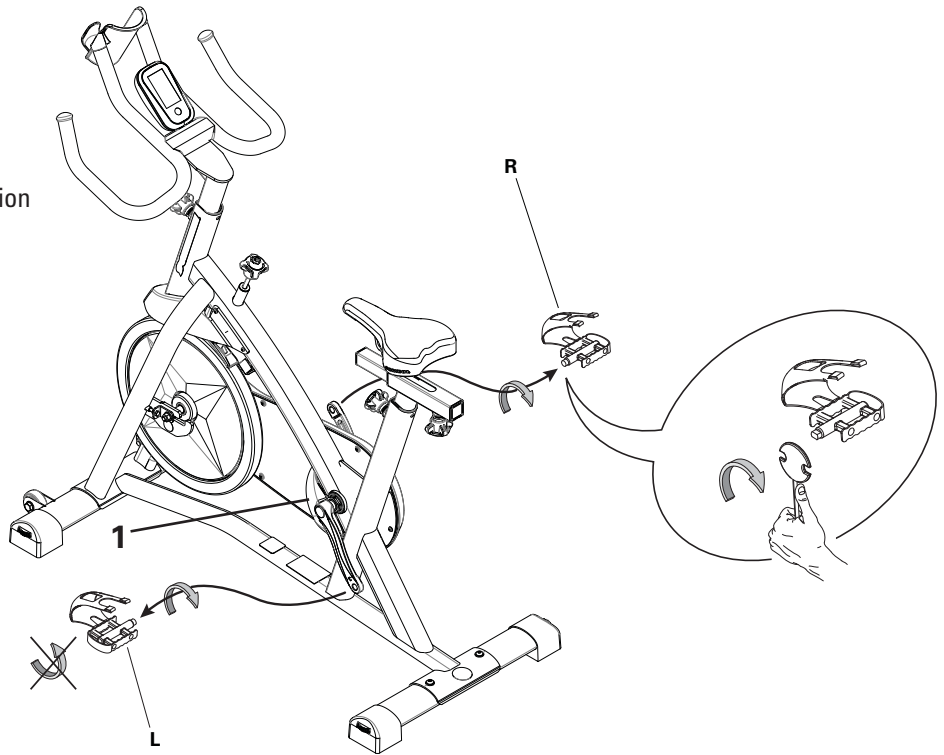

3. Carefully remove the Chain Guard Center from the Chain Guard Cover. Discard the old Chain Guard Center.

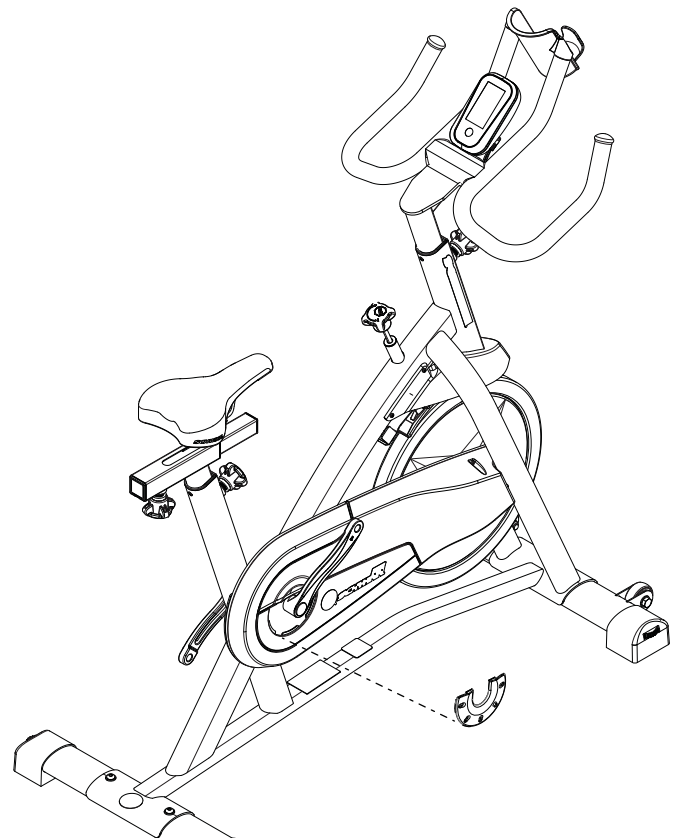

4. Loosen and remove the hardware that attaches the Chain Guard Cover to the Chain Guard Inside. Carefully remove the Chain Guard Cover and discard it.

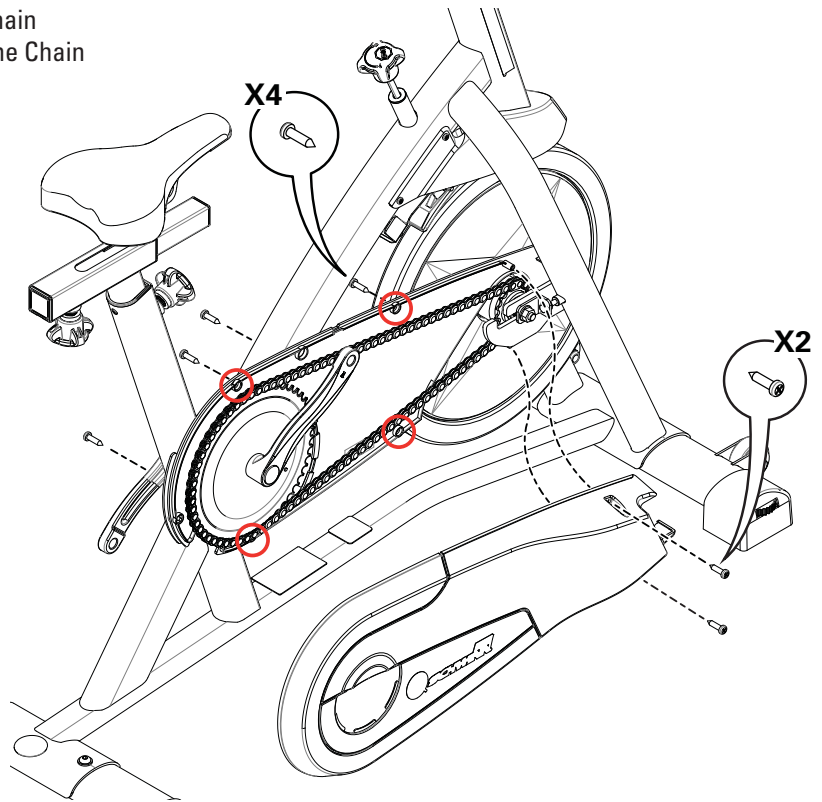

5. Disconnect the Speed Sensor cable (A) from the data cable (B) in the Frame.

*NOTICE:* Do not crimp the cable.

6. Remove the hardware (C) that attaches the Speed Sensor (D) to the Main Frame. Remove the Speed Sensor. Set the Speed Sensor and hardware safely aside for reassembly.

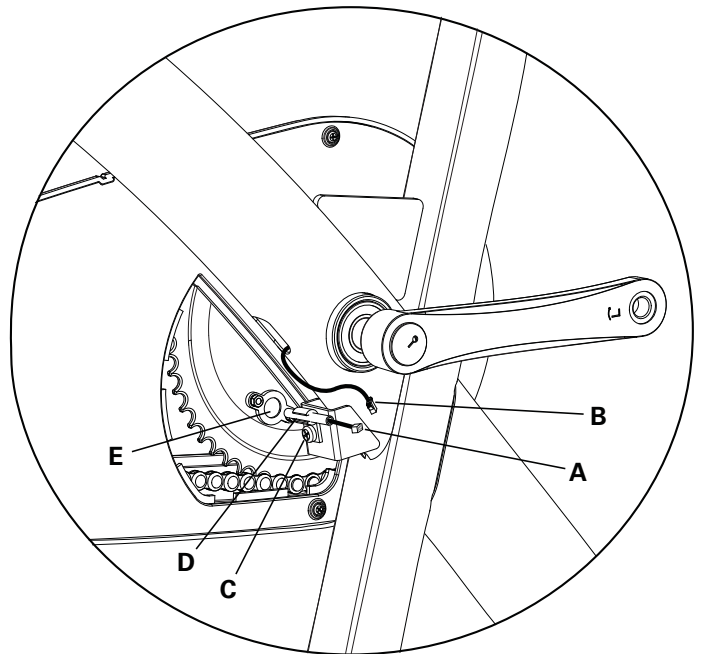

7. Loosen and remove the hardware that attaches the Chain Guard Inside to the Main Frame. Set the hardware safely aside.

8. Carefully lift and slide the Chain Guard Inside forward to disengage from the axles, then move it toward the rear of the bike. Remove the Chain Guard Inside and discard it.

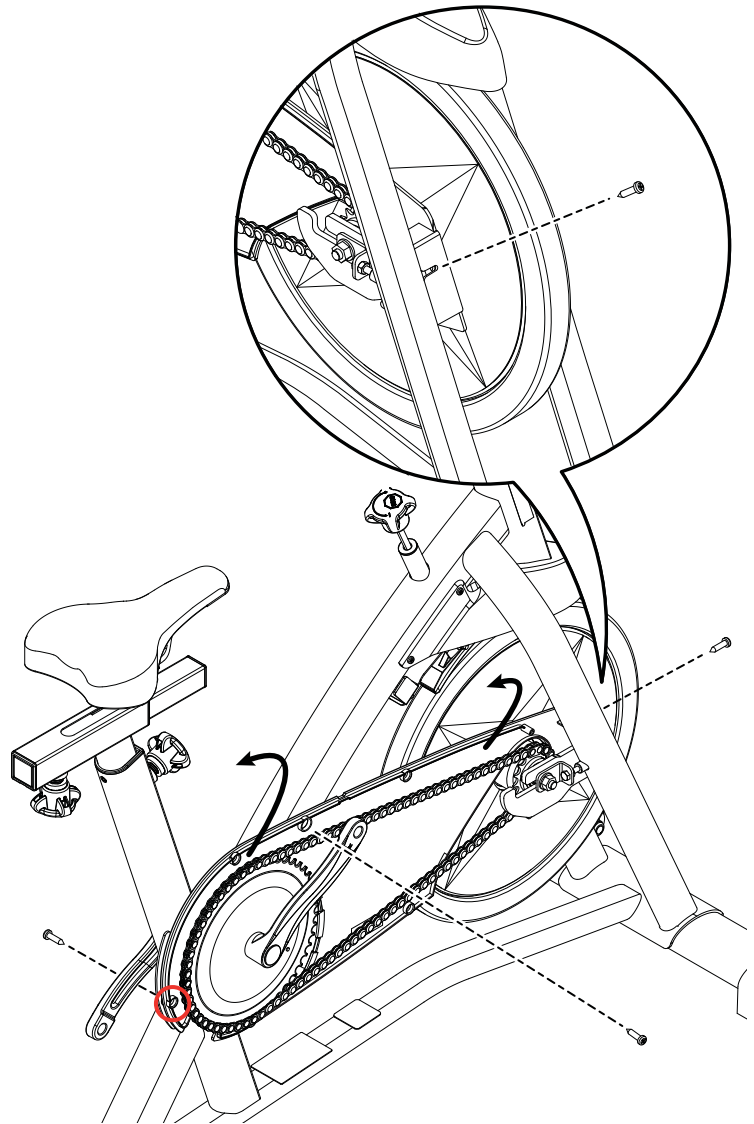

9. Installation is the reverse procedure.

**NOTICE:** Do not crimp any cables. Make sure the Flywheel does not touch the Chain Guard Inside.

**Note:** Before closing the Chain Guard Door, verify that the Speed Sensor (D) and Speed Sensor Magnet (E) on the Sprocket Drive do not touch.

## 10. Final Inspection

Inspect your machine to ensure that all hardware is tight and components are properly assembled.



Do not use until the machine has been fully assembled and inspected for correct performance in accordance with the Owner's Manual.

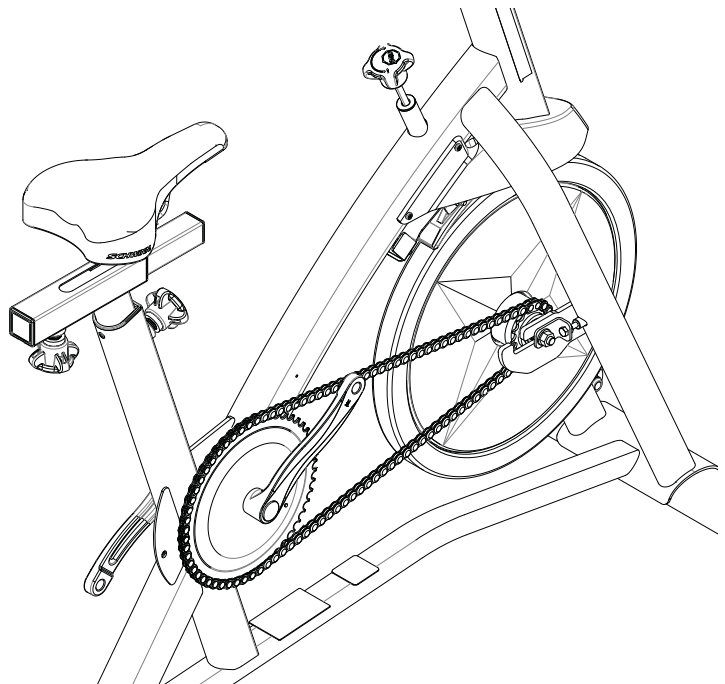

**NOTICE:** This document provides instructions for the replacement of the Flywheel Retainer Clips on the Schwinn® IC2 Bike.

If you need assistance, please call Schwinn Customer Service at 1-800-605-3369.



This icon means a potentially hazardous situation which, if not avoided, could result in death or serious injury. Read and understand all Warnings on this machine.

Nautilus, Inc., (800) NAUTILUS / (800) 628-8458, www.NautilusInc.com - Customer Service: North America (800) 605-3369, csnl@s@nautilus.com | outside U.S. technics@nautilus.com | © 2013 Nautilus, Inc.

### Important Safety Instructions - Before servicing or using this equipment, obey the following warnings:



This icon means a potentially hazardous situation which, if not avoided, could result in death or serious injury. Read and understand all Warnings on this machine.

- Read and understand the Part Replacement Procedure before working on the machine. Failure to obey the instructions and safety warnings could cause injury to the service technician or bystanders.
- Keep bystanders and children away from the product being serviced at all times.
- Make sure that the repair is done in an appropriate work space away from foot traffic and exposure to bystanders.
- Some components of the equipment can be heavy or awkward. Enlist the service of a second person when you do maintenance steps involving these components. Do not try to do heavy or awkward steps on your own.
- If replacement parts are necessary, use only genuine Nautilus replacement parts and hardware. Failure to use genuine replacement parts can cause a risk to users, keep the machine from operating correctly and void the warranty.
- Be sure that all warning stickers and instructional placards applied to the product stay present and in good condition when doing maintenance or replacing components. If necessary request replacement warning stickers or placards from Nautilus customer service.
- Do not try to change the design or functionality of the machine being serviced as this can adversely affect user safety.
- Do not use the machine until all shrouds, instructions, warning labels and correct functionality have been verified and tested for correct performance.

### Tools Required (not included)

Pedal wrench



15 mm Wrench  
10 mm Wrench



#2 Phillips screwdriver

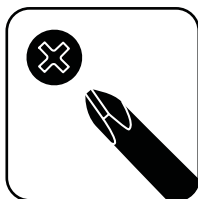

15 mm Socket and  
Wrench



Flathead screwdriver



Tape or marking pen



**NOTICE:** At the end of this procedure, make sure that the Drive Chain tension is correct. Refer to the “Adjust the Chain Tension” procedure.



Disconnect the data cable from the console before you service this machine.

**Note:** Your machine may not match the image. For reference only.

1. Loosen and remove the right Pedal. Set it safely aside for reassembly.

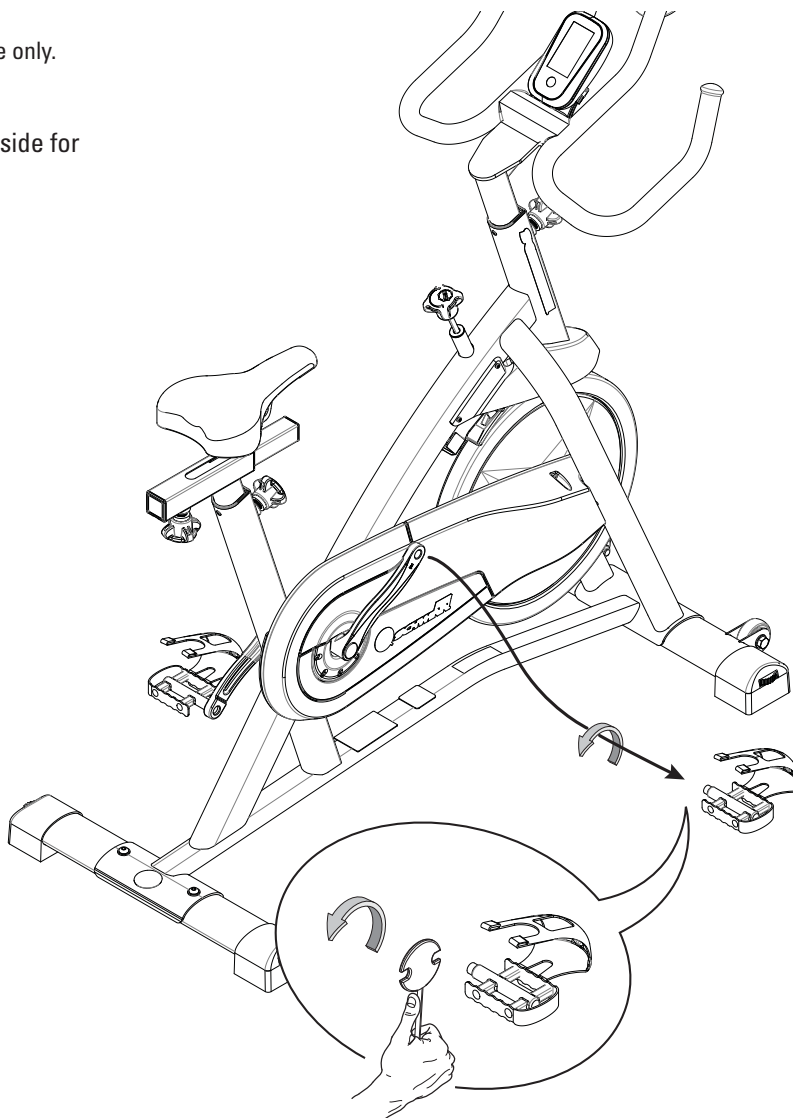

2. Carefully remove the Chain Guard Center from the Chain Guard Cover, and set it safely aside for reassembly.

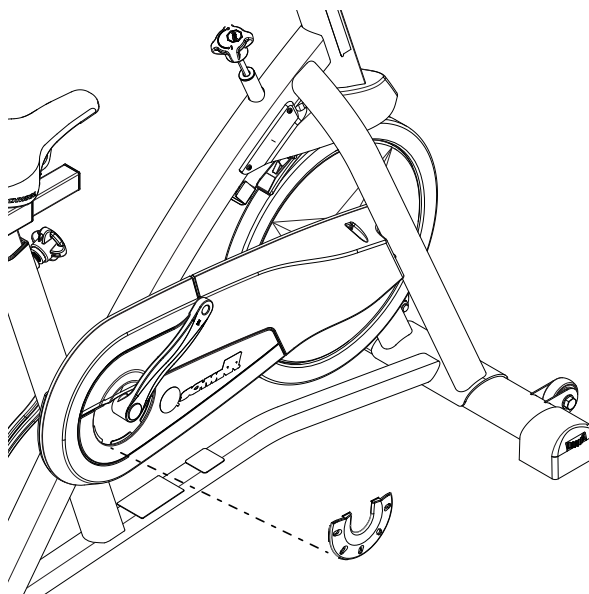

**3.** Remove the hardware that attaches the Chain Guard Cover to the Chain Guard Inside, and set it safely aside for reassembly. Carefully remove the Chain Guard Cover and set it safely aside for reassembly.

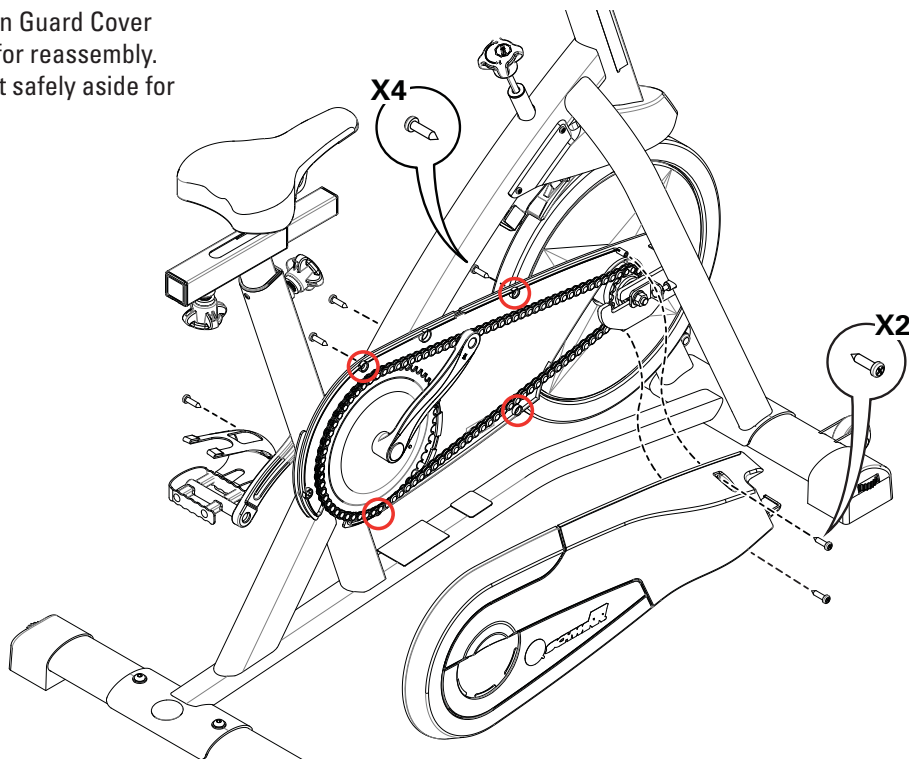

**4.** Mark the position of the Flywheel Retainer Clips (A) on the flywheel brackets (B) on the Frame. Record the number of threads showing on the Hex Head Bolt (C) that attaches each Flywheel Retainer Clip to the Frame.

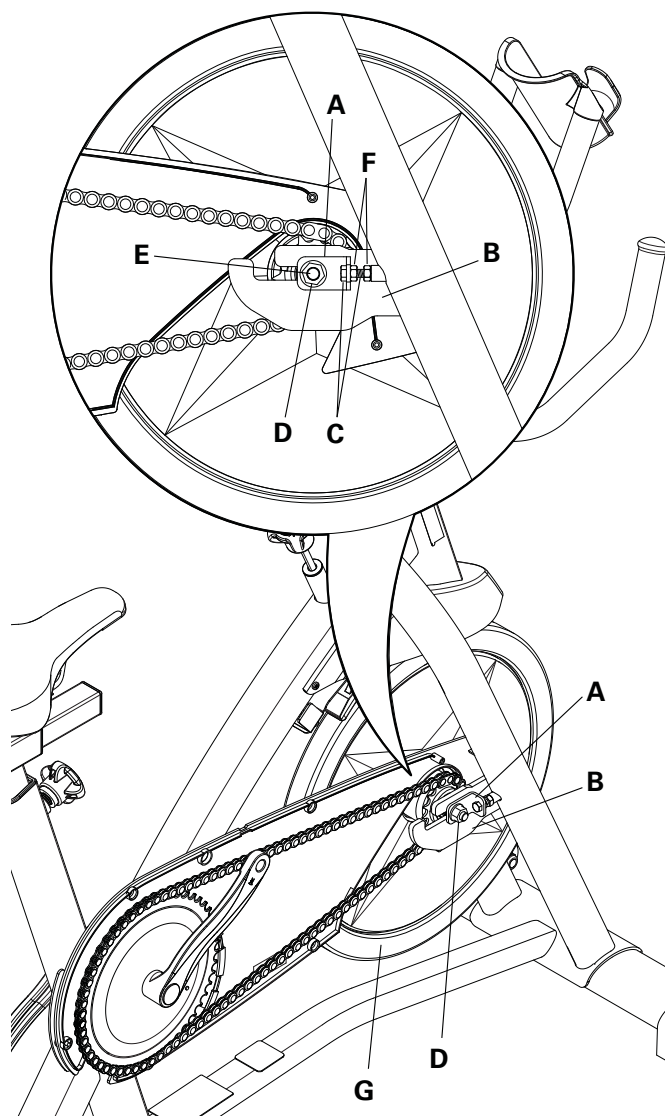



**5.** To loosen the Flywheel hardware, use a 15 mm crescent wrench to hold the Axle Nut (D) on one side steady and loosen the Axle Nut on the opposite side with a 15 mm socket and wrench. Remove the Axle Nuts from the Flywheel axle (E). Set the hardware safely aside for reassembly.

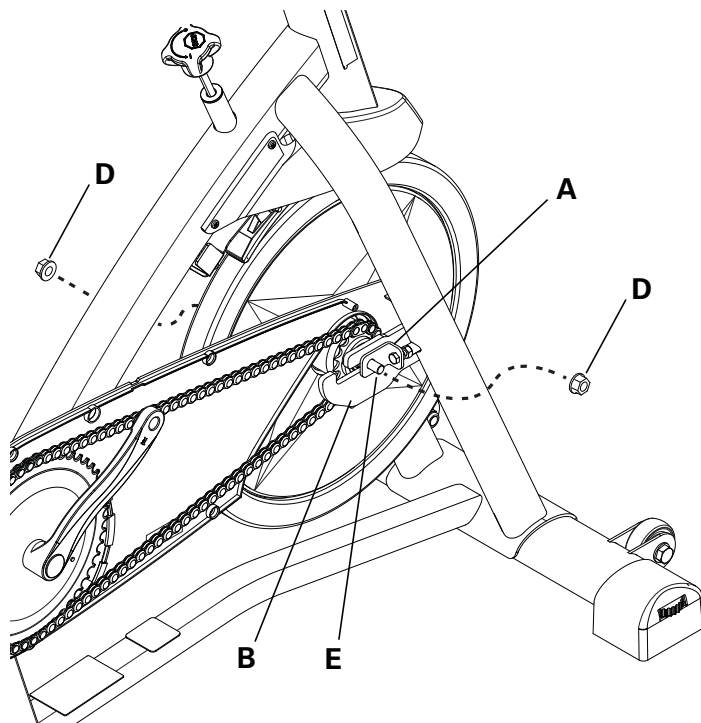

**6.** Loosen the Hex Head Bolt (C) that attaches each Flywheel Retainer Clip (A) to the Frame. Remove the Hex Head Bolts, Flywheel Retainer Clips and Nuts (F) from the Frame, and set aside to discard.

**7.** Installation is the reverse procedure.

**NOTICE:** Do not crimp any cables. Install the new Flywheel Retainer Clips (A) at the position that you recorded in step 4. Make sure the Flywheel (G) can turn easily.

**8.** Make sure that the Drive Chain tension is correct. Refer to the "Adjust the Chain Tension" procedure.

## 9. Final Inspection

Inspect your machine to ensure that all hardware is tight and components are properly assembled.



Do not use until the machine has been fully assembled and inspected for correct performance in accordance with the Owner's Manual.

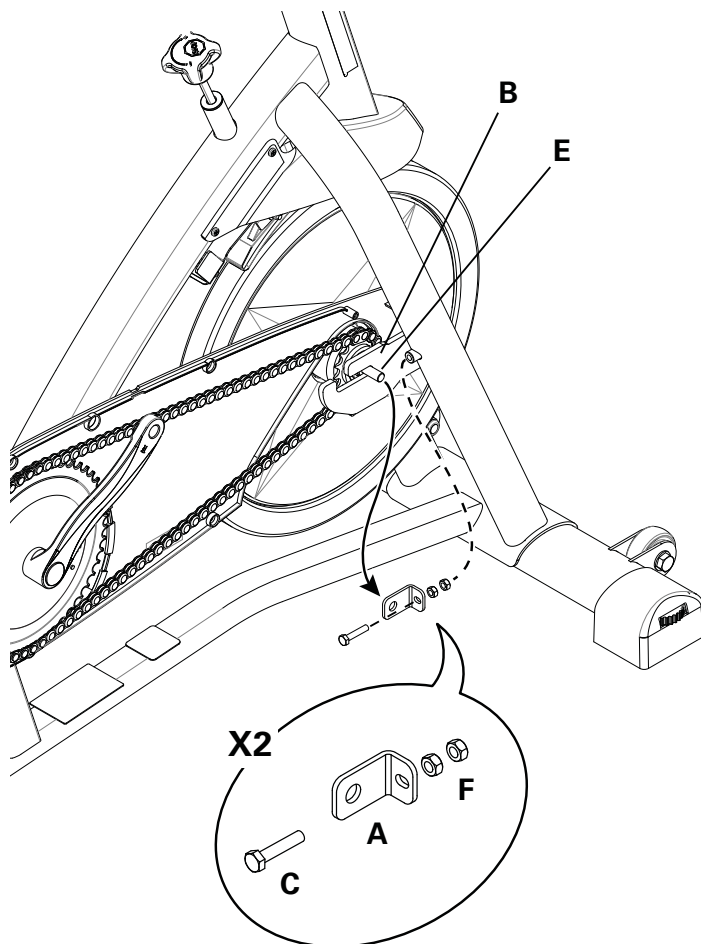



**NOTICE:** This document provides instructions for the replacement of the Drive Chain on the Schwinn® IC2 Bike.

If you need assistance, please call Schwinn Customer Service at 1-800-605-3369.



This icon means a potentially hazardous situation which, if not avoided, could result in death or serious injury. Read and understand all Warnings on this machine.

Nautilus, Inc., (800) NAUTILUS / (800) 628-8458, www.NautilusInc.com - Customer Service: North America (800) 605-3369, csnl@s@nautilus.com | outside U.S. technics@nautilus.com | © 2013 Nautilus, Inc.

### Important Safety Instructions - Before servicing or using this equipment, obey the following warnings:



This icon means a potentially hazardous situation which, if not avoided, could result in death or serious injury. Read and understand all Warnings on this machine.

- Read and understand the Part Replacement Procedure before working on the machine. Failure to obey the instructions and safety warnings could cause injury to the service technician or bystanders.
- Keep bystanders and children away from the product being serviced at all times.
- Make sure that the repair is done in an appropriate work space away from foot traffic and exposure to bystanders.
- Some components of the equipment can be heavy or awkward. Enlist the service of a second person when you do maintenance steps involving these components. Do not try to do heavy or awkward steps on your own.
- If replacement parts are necessary, use only genuine Nautilus replacement parts and hardware. Failure to use genuine replacement parts can cause a risk to users, keep the machine from operating correctly and void the warranty.
- Be sure that all warning stickers and instructional placards applied to the product stay present and in good condition when doing maintenance or replacing components. If necessary request replacement warning stickers or placards from Nautilus customer service.
- Do not try to change the design or functionality of the machine being serviced as this can adversely affect user safety.
- Do not use the machine until all shrouds, instructions, warning labels and correct functionality have been verified and tested for correct performance.

### Tools Required (not included)

Pedal wrench



15 mm Wrench  
10 mm Wrench

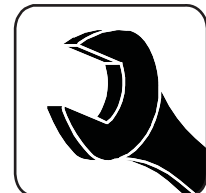

#2 Phillips screwdriver

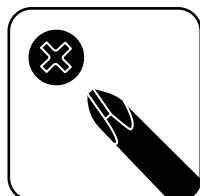

15 mm Socket and  
Wrench



Flathead screwdriver



Tape or marking pen



**NOTICE:** At the end of this procedure, make sure that the Drive Chain tension is correct. Refer to the “Adjust the Chain Tension” procedure.



Disconnect the data cable from the console before you service this machine.

**Note:** Your machine may not match the image. For reference only.

1. Loosen and remove the Pedals. Set them safely aside for reassembly.

**Note: The Left Pedal is reverse-threaded.**

Orientation is based from a seated position on the bike. The Left Pedal has an “L”, the Right Pedal an “R”.

2. Carefully remove the Chain Guard Door (1), and set it safely aside for reassembly.

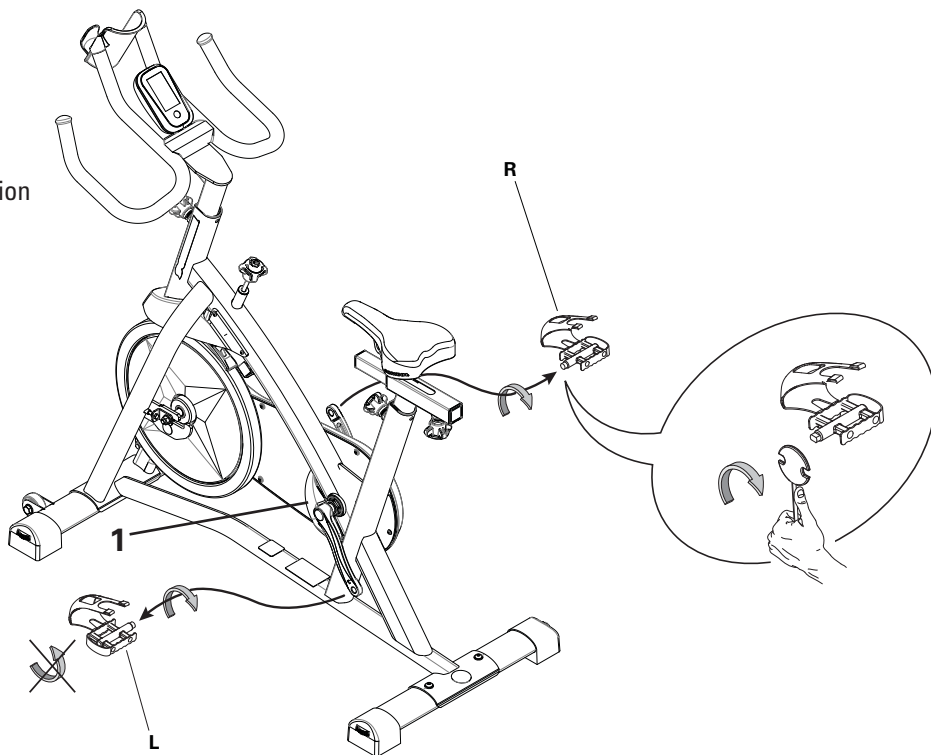

3. Carefully remove the Chain Guard Center from the Chain Guard Cover, and set it safely aside for reassembly.

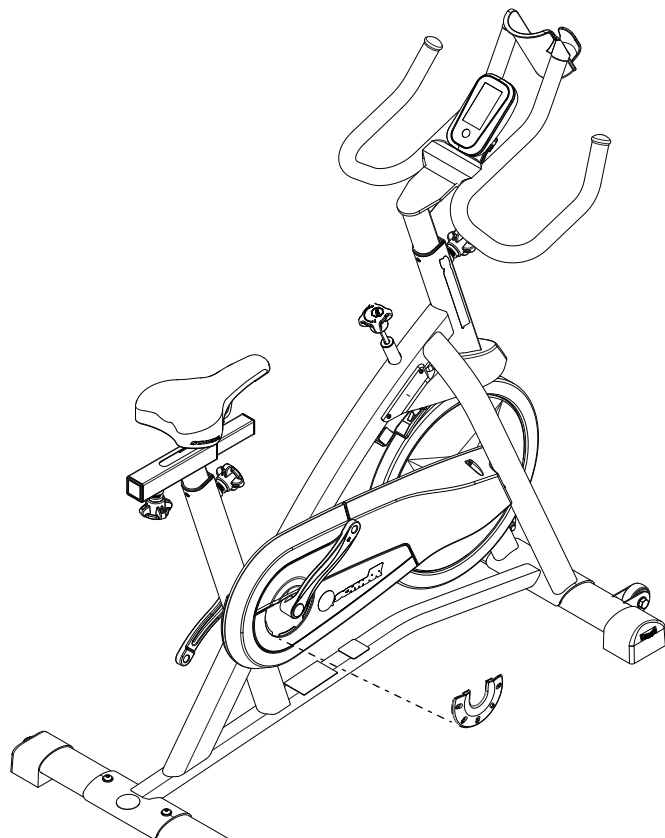

4. Loosen and remove the hardware that attaches the Chain Guard Cover to the Chain Guard Inside. Carefully remove the Chain Guard Cover and set it safely aside for reassembly.

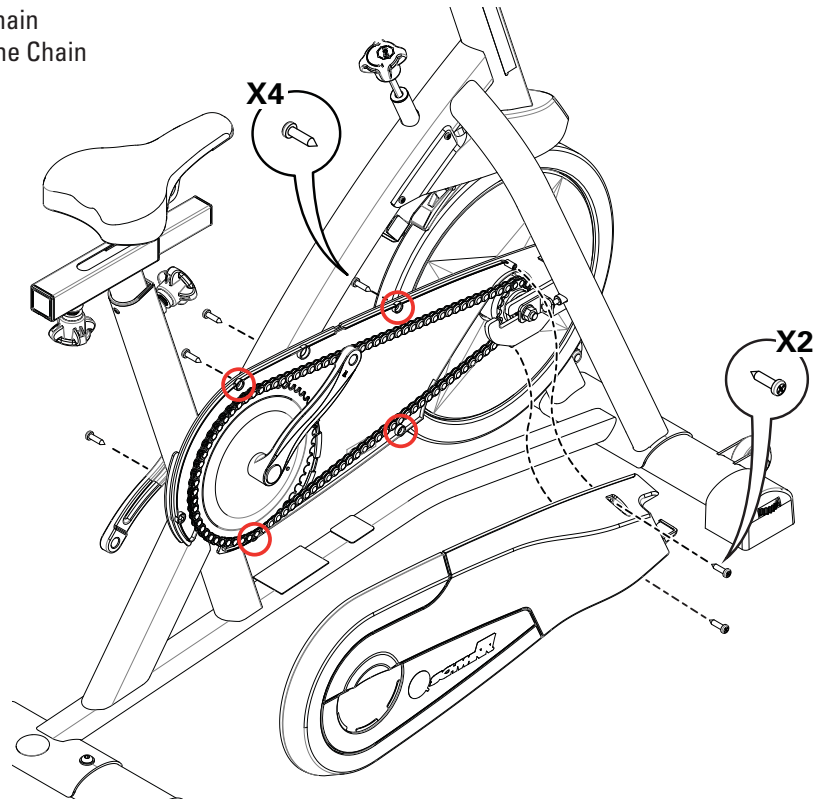

5. Disconnect the Speed Sensor cable (S1) from the data cable (S2) in the Frame.

*NOTICE:* Do not crimp the cable.

6. Remove the hardware (S3) that attaches the Speed Sensor (S4) to the Main Frame. Remove the Speed Sensor. Set the Speed Sensor and hardware safely aside for reassembly.

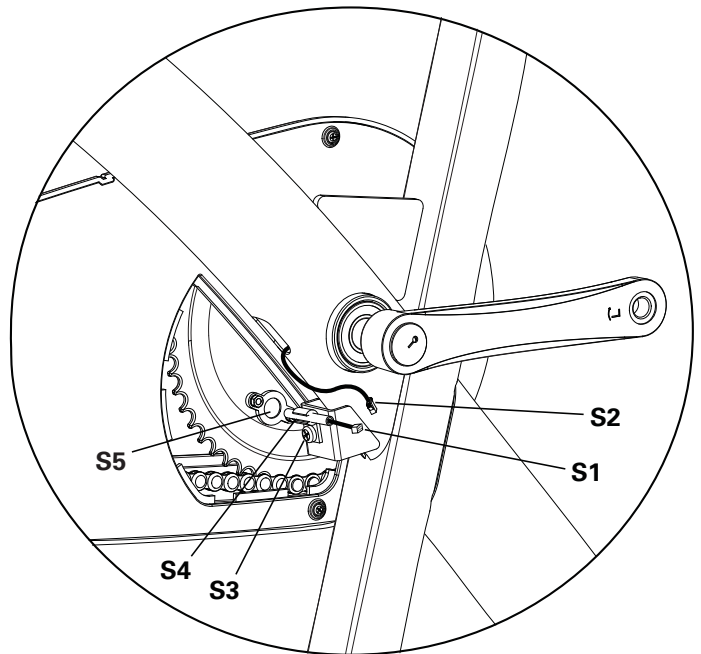

**7.** Loosen and remove the hardware that attaches the Chain Guard Inside to the Main Frame. Set the hardware safely aside.

**8.** Carefully lift and slide the Chain Guard Inside forward to disengage from the axles, then move it toward the rear of the bike. Remove the Chain Guard Inside and set it safely aside for reassembly.

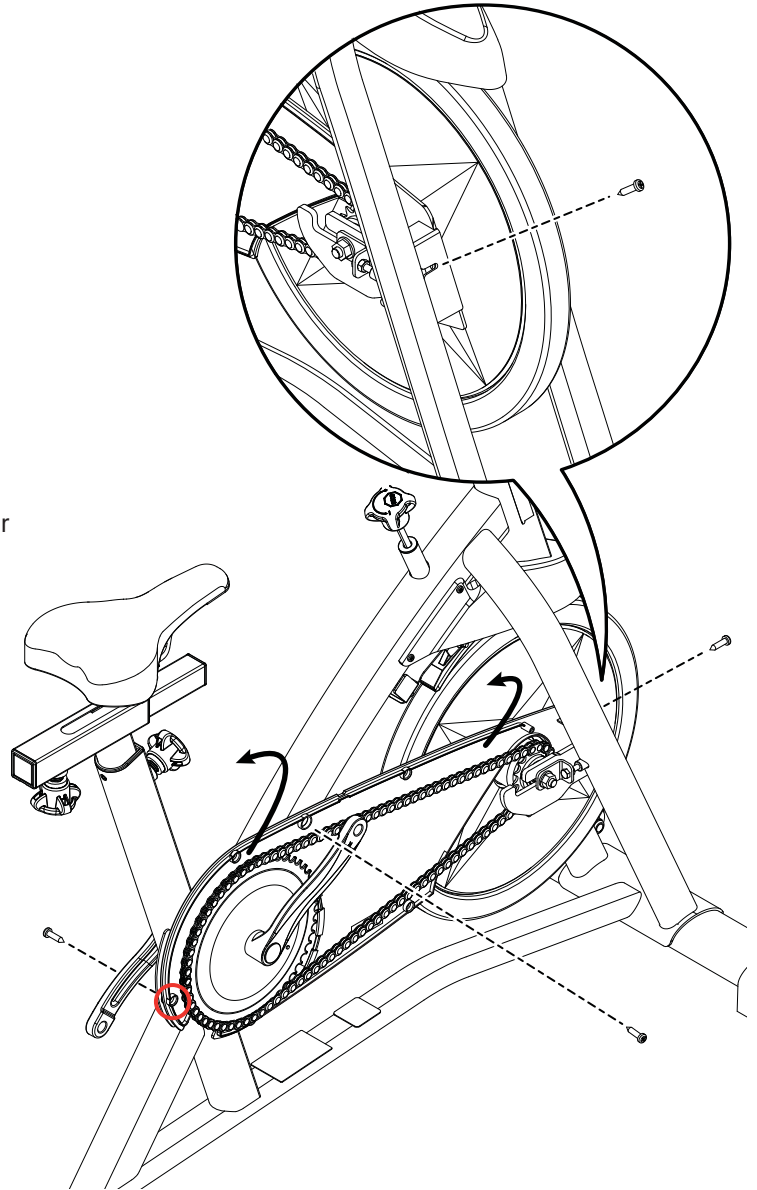

**9.** Mark the position of the Flywheel Retainer Clips (A) on the flywheel brackets (B) on the Frame. Record the number of threads showing on the Hex Head Bolt (C) that attaches each Flywheel Retainer Clip to the Frame.

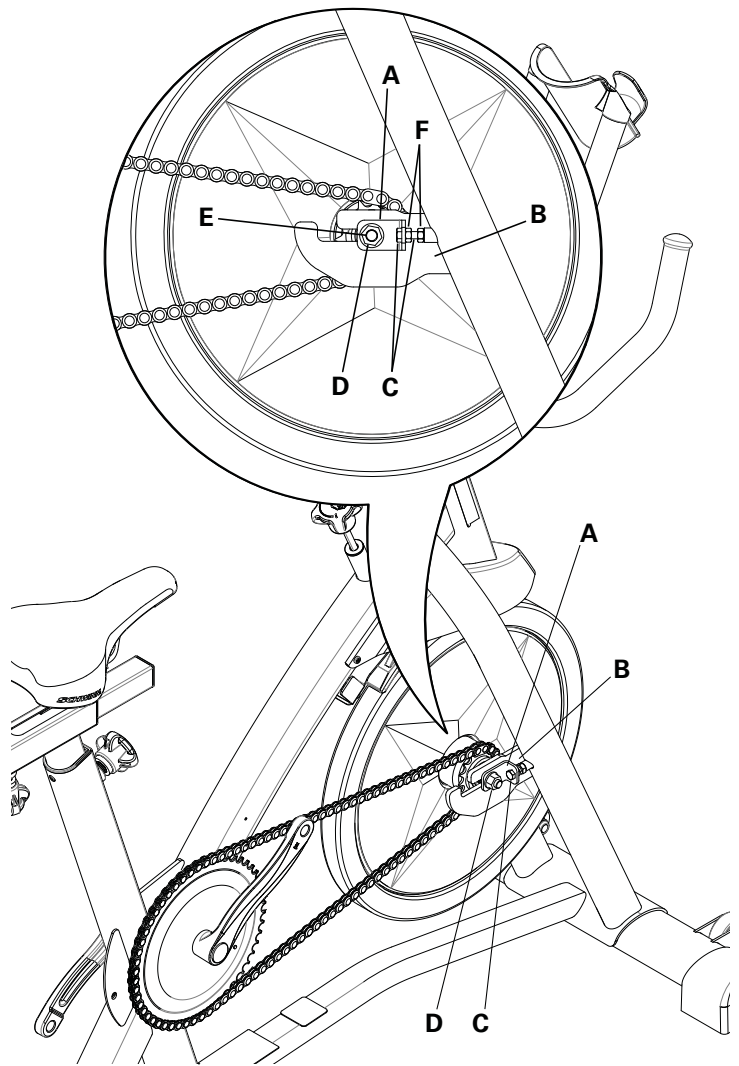

**10.** To loosen the Flywheel hardware, use a 15 mm crescent wrench to hold the Axle Nut (D) on one side steady and loosen the Axle Nut on the opposite side with a 15 mm socket and wrench. Remove the Axle Nut from the Flywheel axle (E). Set the hardware safely aside for reassembly.

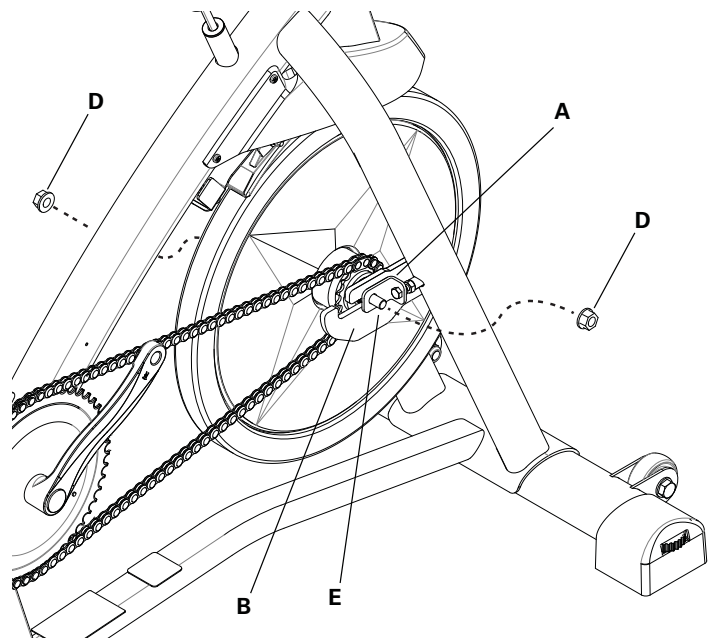

**11.** Loosen the Hex Head Bolt (C) that attaches each Flywheel Retainer Clip (A) to the Frame. Remove the Hex Head Bolts, Flywheel Retainer Clips and Nuts (F) from the Frame. Keep the hardware safely aside for reassembly.

Loosen the Resistance Knob (R) to the minimum resistance setting.

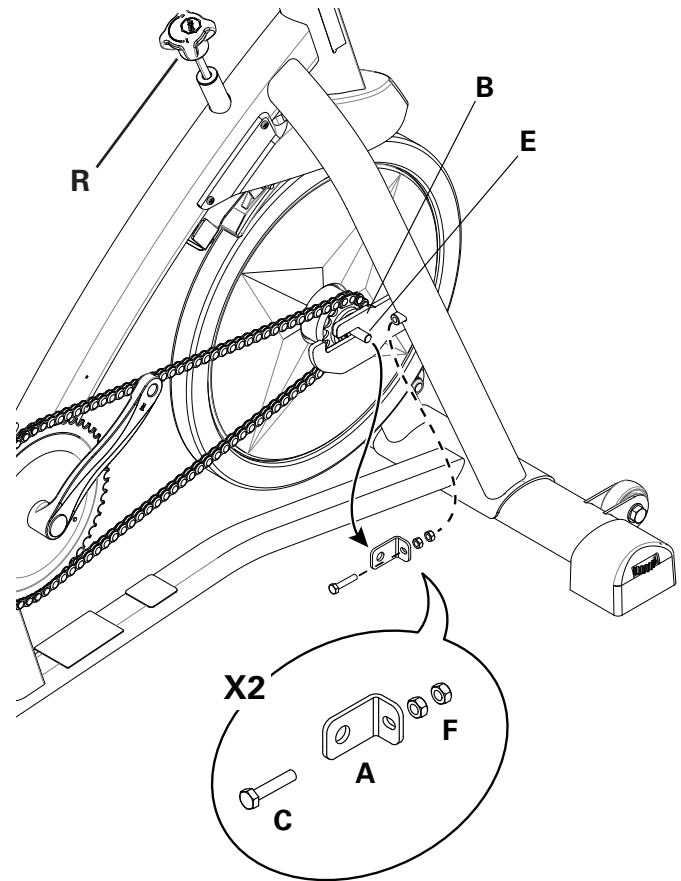

**12.** Carefully move the Flywheel (G) to the opening in the flywheel brackets (B).

*NOTICE:* This step may require two people. It may be helpful to remove the Brake Assembly (H) and Brake Cover (L).

**13.** Carefully tilt the Flywheel (G) to the left to lift the right end of the axle (E) from the flywheel bracket (B). Lift the Drive Chain (I) off the Flywheel sprockets (J) to the outside, and move the Drive Chain clear of the right end of the axle and the bracket.



Be sure to keep fingers clear of all pinch hazards as you turn the Sprocket Drive (K) and Flywheel (G).

**14.** Lift the Drive Chain (I) off the Sprocket Drive (K) to the outside. Set the old Drive Chain safely aside to discard.

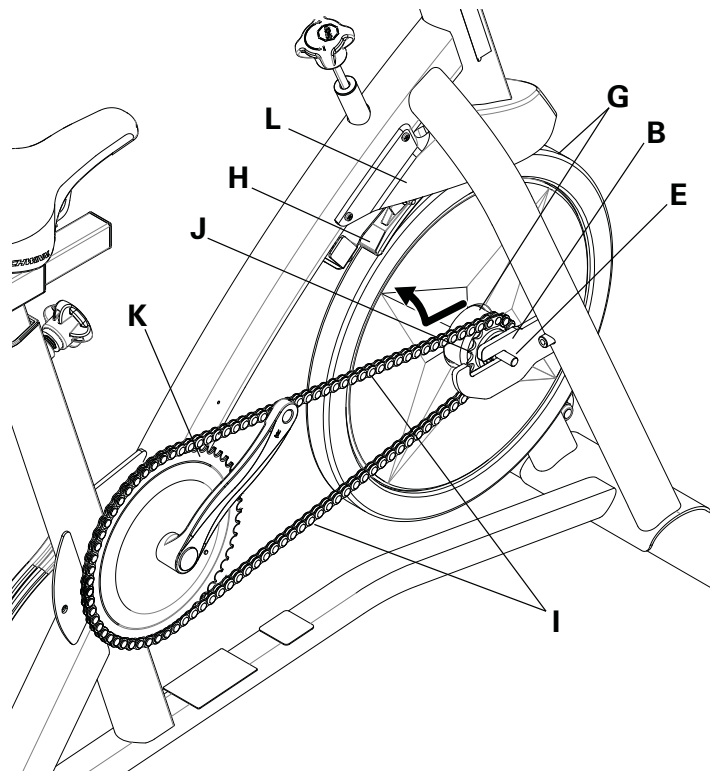

**15.** Installation is the reverse procedure.

*NOTICE:* Install the Flywheel Retainer Clips (A) at the position that you recorded in step 9. Make sure the Flywheel (G) can turn easily.

*NOTICE:* Do not crimp any cables.

**Note:** Before closing the Chain Guard Door (1), verify that the Speed Sensor (S4) and Speed Sensor Magnet (S5) on the Sprocket Drive (K) do not touch.

**16.** Make sure that the Drive Chain tension is correct. Refer to the “Adjust the Chain Tension” procedure.

## **17. Final Inspection**

Inspect your machine to ensure that all hardware is tight and components are properly assembled.



Do not use until the machine has been fully assembled and inspected for correct performance in accordance with the Owner's Manual.

**NOTICE:** This document provides instructions for the replacement of the Flywheel Assembly on the Schwinn® IC2 Bike.

If you need assistance, please call Schwinn Customer Service at 1-800-605-3369.



This icon means a potentially hazardous situation which, if not avoided, could result in death or serious injury. Read and understand all Warnings on this machine.

Nautilus, Inc., (800) NAUTILUS / (800) 628-8458, www.NautilusInc.com - Customer Service: North America (800) 605-3369, csnl@s@nautilus.com | outside U.S. technics@nautilus.com | © 2013 Nautilus, Inc.

### Important Safety Instructions - Before servicing or using this equipment, obey the following warnings:



This icon means a potentially hazardous situation which, if not avoided, could result in death or serious injury. Read and understand all Warnings on this machine.

- Read and understand the Part Replacement Procedure before working on the machine. Failure to obey the instructions and safety warnings could cause injury to the service technician or bystanders.
- Keep bystanders and children away from the product being serviced at all times.
- Make sure that the repair is done in an appropriate work space away from foot traffic and exposure to bystanders.
- Some components of the equipment can be heavy or awkward. Enlist the service of a second person when you do maintenance steps involving these components. Do not try to do heavy or awkward steps on your own.
- If replacement parts are necessary, use only genuine Nautilus replacement parts and hardware. Failure to use genuine replacement parts can cause a risk to users, keep the machine from operating correctly and void the warranty.
- Be sure that all warning stickers and instructional placards applied to the product stay present and in good condition when doing maintenance or replacing components. If necessary request replacement warning stickers or placards from Nautilus customer service.
- Do not try to change the design or functionality of the machine being serviced as this can adversely affect user safety.
- Do not use the machine until all shrouds, instructions, warning labels and correct functionality have been verified and tested for correct performance.

### Tools Required (not included)

Pedal wrench



15 mm Wrench  
10 mm Wrench



#2 Phillips screwdriver

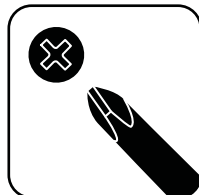

15 mm Socket and  
Wrench



Flathead screwdriver  
Small flathead screwdriver



3mm hex key

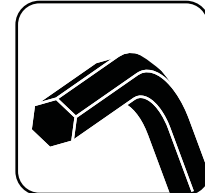

Tape or marking pen





**NOTICE:** At the end of this procedure, make sure that the Drive Chain tension is correct. Refer to the “Adjust the Chain Tension” procedure.



Disconnect the data cable from the console before you service this machine.

**Note:** Your machine may not match the image. For reference only.

1. Loosen and remove the Pedals. Set them safely aside for reassembly.

**Note: The Left Pedal is reverse-threaded.**

Orientation is based from a seated position on the bike. The Left Pedal has an “L”, the Right Pedal an “R”.

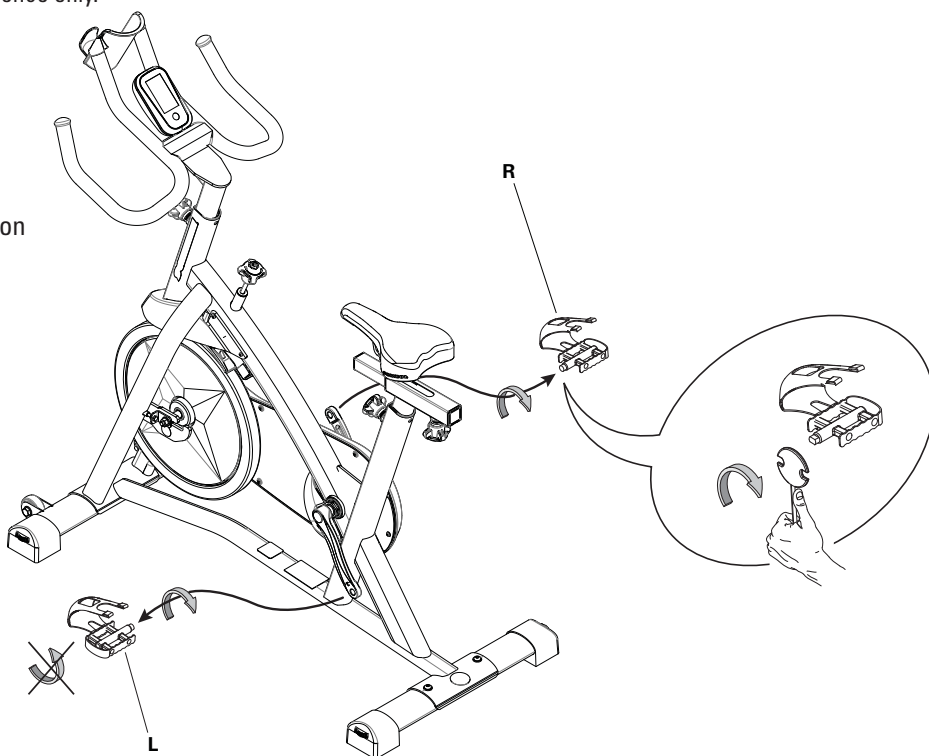

2. Using a #2 Phillips screwdriver, loosen and remove the hardware that attaches the Brake Cover to the Main Frame. Set the hardware safely aside for reassembly.

**NOTICE:** Hold the Brake Cover so that it does not fall.

3. Carefully remove the Brake Cover and set it safely aside for reassembly.

**NOTICE:** Do not crimp the cable.

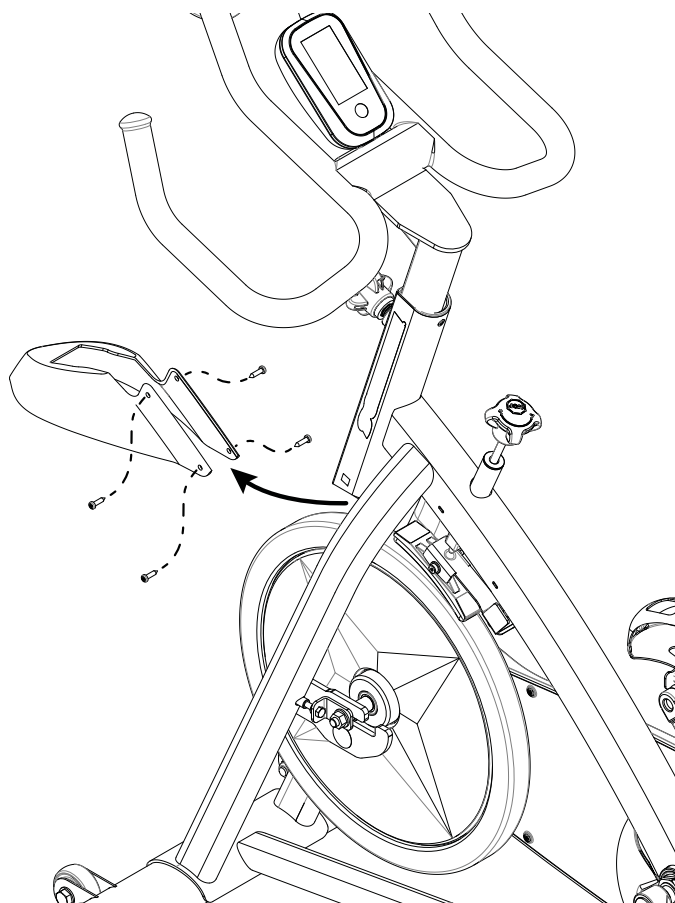

4. Loosen the Resistance Knob (R) to the minimum resistance setting.

5. Using a 3mm hex key, remove the hardware (1a) that attaches the Brake Assembly (1) to the Frame Mount (2). Set the hardware safely aside for reassembly.

**Note:** The nuts may turn along with the screws when you try to loosen the hardware (1a). To hold the nut stable, wedge a small flathead screwdriver diagonally between the nut and the inside of the Frame Mount bracket (2).

6. Remove the Brake Assembly (1) and set it safely aside.

7. Carefully remove the Chain Guard Door (3), and set it safely aside for reassembly.

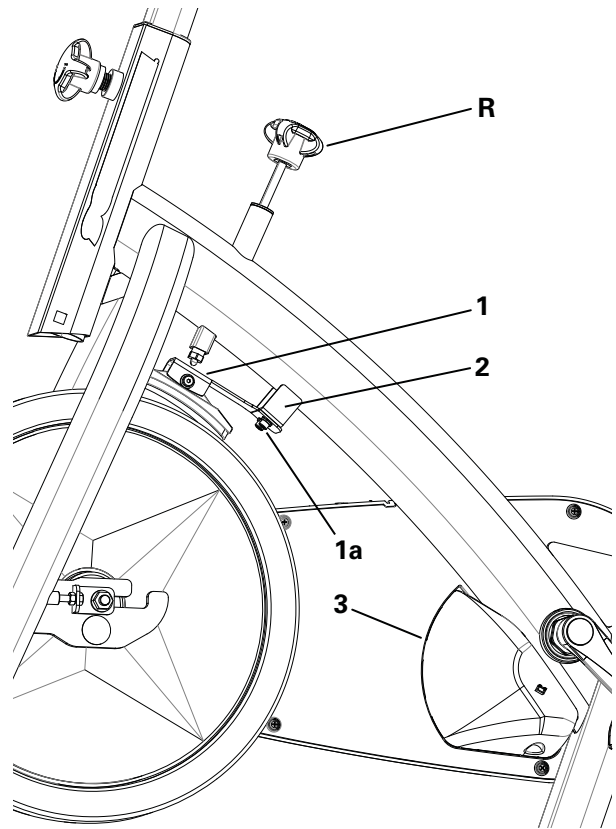

8. Carefully remove the Chain Guard Center from the Chain Guard Cover, and set it safely aside for reassembly.

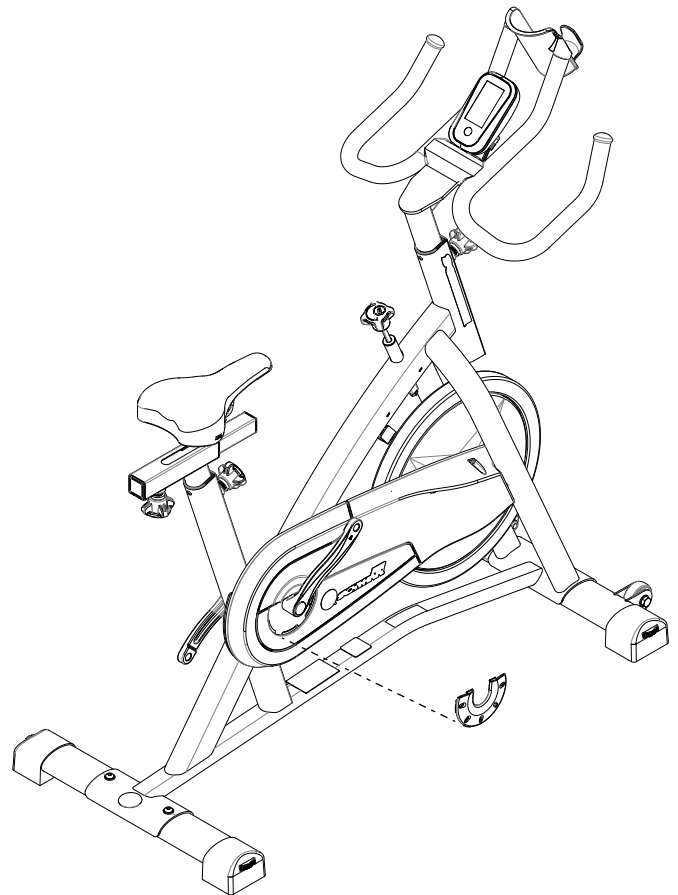

- 9.** Loosen and remove the hardware that attaches the Chain Guard Cover to the Chain Guard Inside. Carefully remove the Chain Guard Cover and set it safely aside for reassembly.

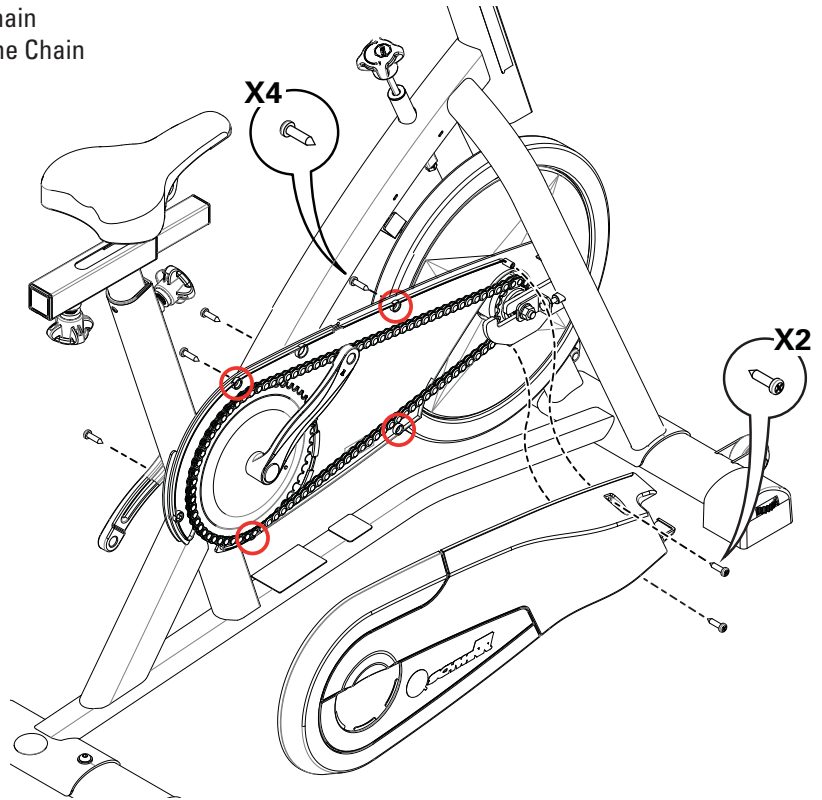

- 10.** Disconnect the Speed Sensor cable (S1) from the data cable (S2) in the Frame.

*NOTICE:* Do not crimp the cable.

- 11.** Remove the hardware (S3) that attaches the Speed Sensor (S4) to the Main Frame. Remove the Speed Sensor. Set the Speed Sensor and hardware safely aside for reassembly.

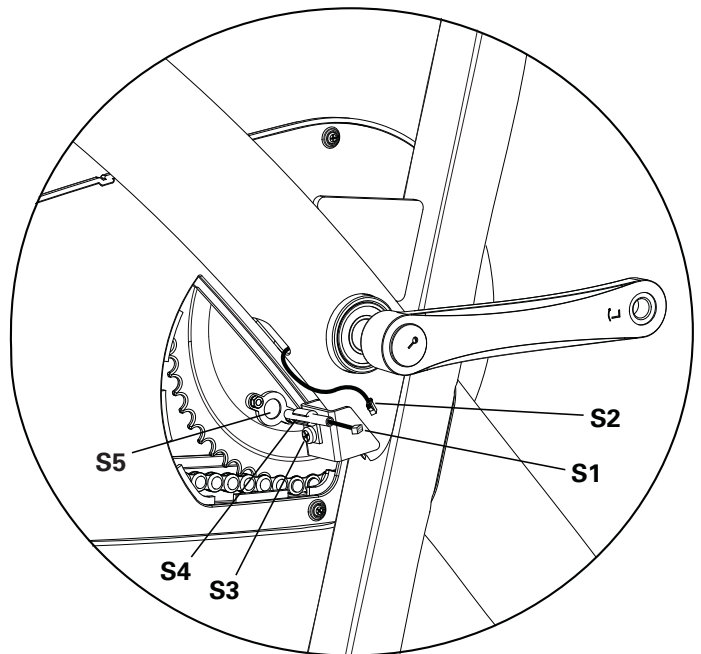

**12.** Loosen and remove the hardware that attaches the Chain Guard Inside to the Main Frame. Set the hardware safely aside.

**13.** Carefully lift and slide the Chain Guard Inside forward to disengage from the axles, then move it toward the rear of the bike. Remove the Chain Guard Inside and set it safely aside for reassembly.

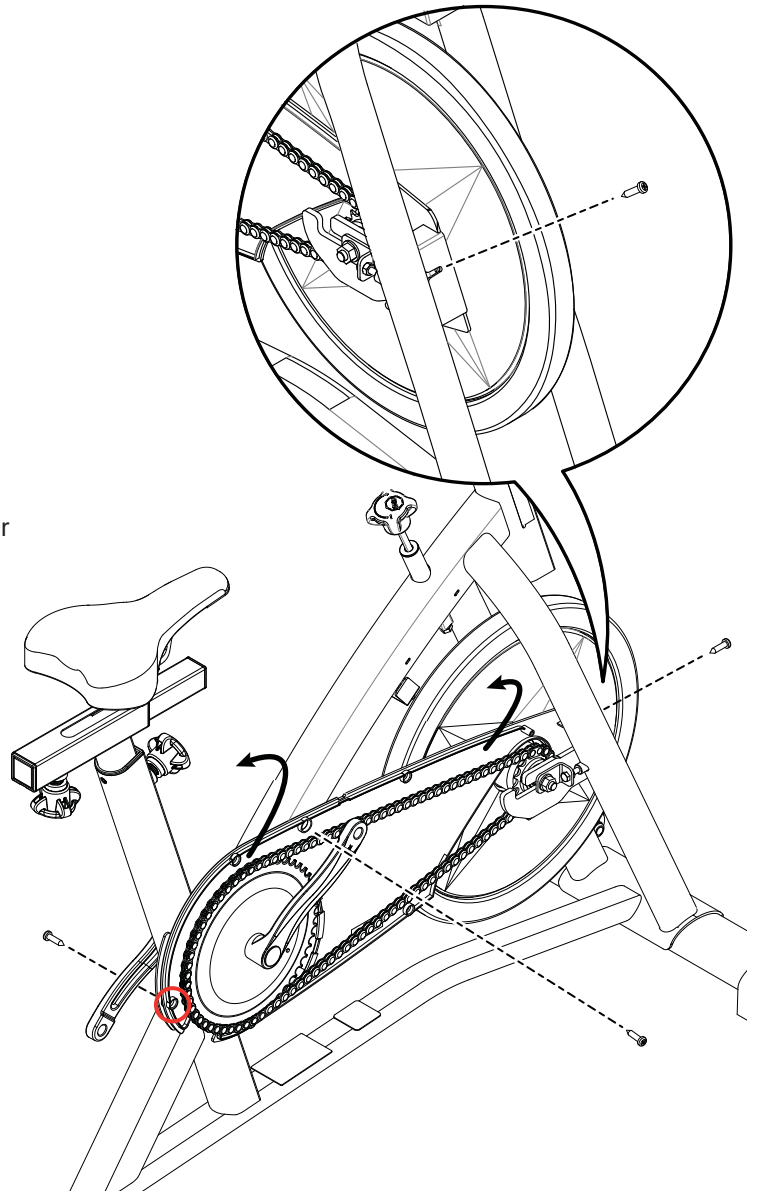

**14.** Mark the position of the Flywheel Retainer Clips (A) on the flywheel brackets (B) on the Frame. Record the number of threads showing on the Hex Head Bolt (C) that attaches each Flywheel Retainer Clip to the Frame.

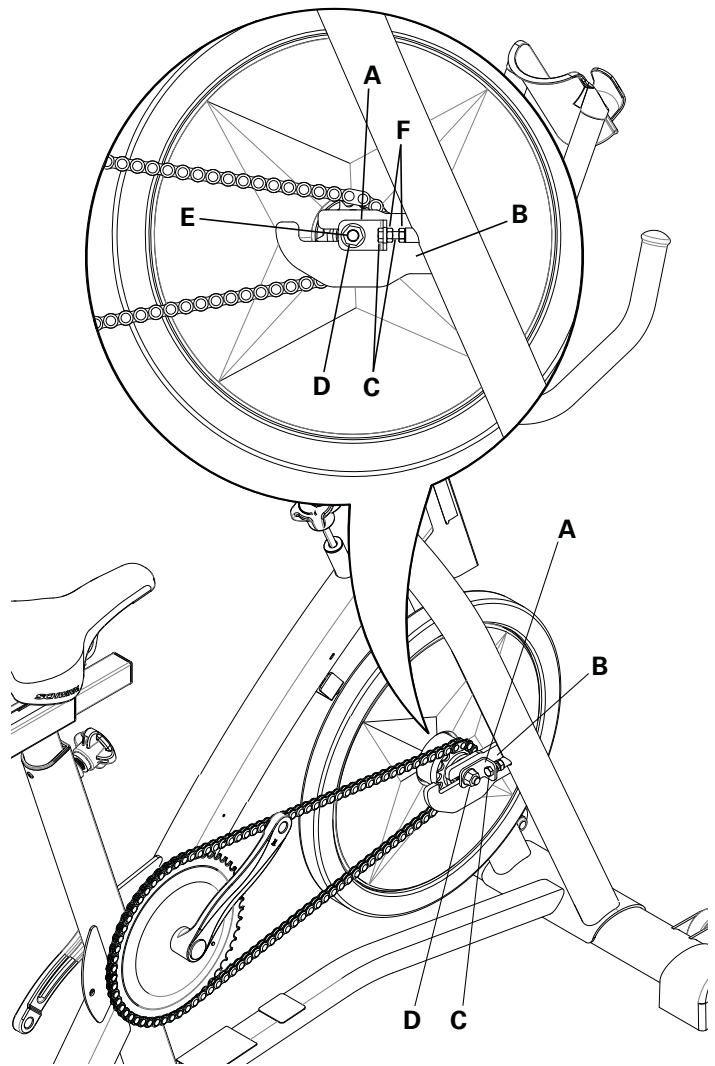

**15.** To loosen the Flywheel hardware, use a 15 mm crescent wrench to hold the Axle Nut (D) on one side steady and loosen the Axle Nut on the opposite side with a 15 mm socket and wrench. Remove the Axle Nuts from the Flywheel axle (E). Set the hardware safely aside for reassembly.

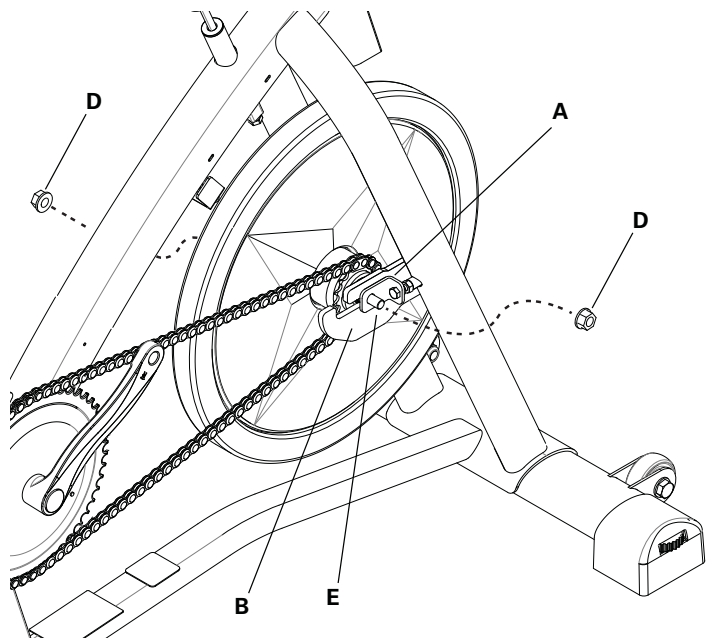

**16.** Loosen the Hex Head Bolt (C) that attaches each Flywheel Retainer Clip (A) to the Frame. Remove the Hex Head Bolts, Flywheel Retainer Clips and Nuts (F) from the Frame. Keep the hardware safely aside for reassembly.

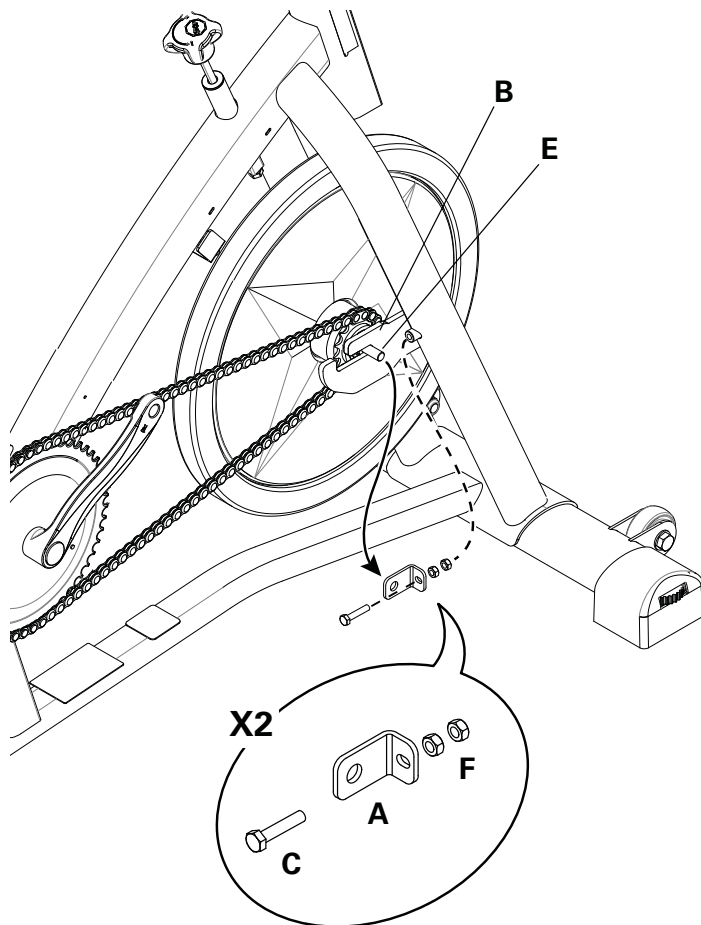

**17.** Carefully move the Flywheel (G) to the opening in the flywheel brackets (B). Carefully lift it from the brackets and lift the Drive Chain (H) off the Flywheel sprockets (J) to the outside.

*NOTICE:* This step may require two people.

**18.** Remove the old Flywheel assembly (G) and set it safely aside to discard.



Be sure to keep fingers clear of all pinch hazards as you turn the Sprocket Drive (K) and Flywheel (G).

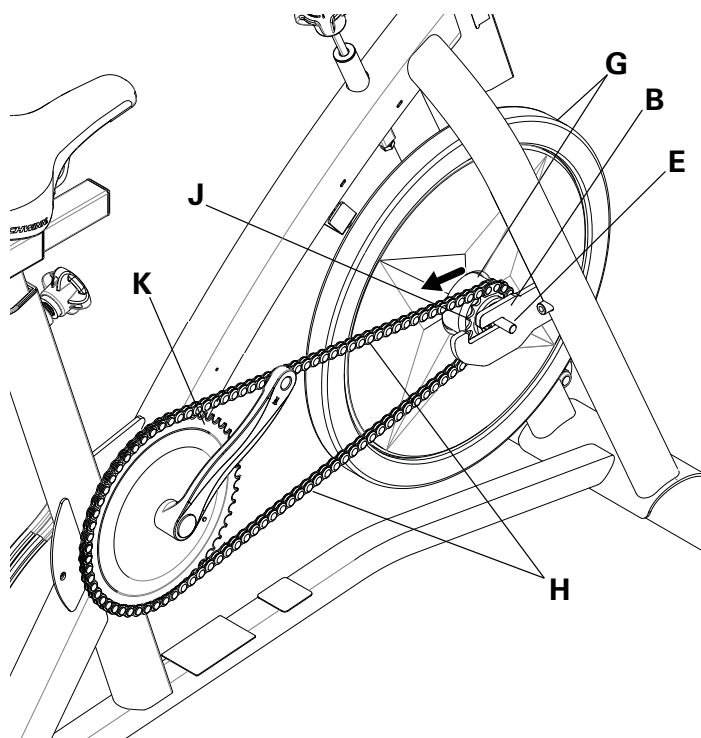

**19.** Installation is the reverse procedure.

*NOTICE:* Install the Flywheel Retainer Clips (A) at the position that you recorded in step 14. Make sure the Flywheel (G) can turn easily.

*NOTICE:* Do not crimp any cables.

**Note:** Before closing the Chain Guard Door (3), verify that the Speed Sensor (S4) and Speed Sensor Magnet (S5) on the Sprocket Drive (K) do not touch.

**20.** Make sure that the Drive Chain tension is correct. Refer to the “Adjust the Chain Tension” procedure.

## **21. Final Inspection**

Inspect your machine to ensure that all hardware is tight and components are properly assembled.



Do not use until the machine has been fully assembled and inspected for correct performance in accordance with the Owner's Manual.

**NOTICE:** This document provides instructions for the replacement of the Right Crank Arm/Sprocket Drive Assembly on the Schwinn® IC2 Bike.

If you need assistance, please call Schwinn Customer Service at 1-800-605-3369.



This icon means a potentially hazardous situation which, if not avoided, could result in death or serious injury. Read and understand all Warnings on this machine.

Nautilus, Inc., (800) NAUTILUS / (800) 628-8458, www.NautilusInc.com - Customer Service: North America (800) 605-3369, csnl@s@nautilus.com | outside U.S. technics@nautilus.com | © 2013 Nautilus, Inc.

### Important Safety Instructions - Before servicing or using this equipment, obey the following warnings:



This icon means a potentially hazardous situation which, if not avoided, could result in death or serious injury. Read and understand all Warnings on this machine.

- Read and understand the Part Replacement Procedure before working on the machine. Failure to obey the instructions and safety warnings could cause injury to the service technician or bystanders.
- Keep bystanders and children away from the product being serviced at all times.
- Make sure that the repair is done in an appropriate work space away from foot traffic and exposure to bystanders.
- Some components of the equipment can be heavy or awkward. Enlist the service of a second person when you do maintenance steps involving these components. Do not try to do heavy or awkward steps on your own.
- If replacement parts are necessary, use only genuine Nautilus replacement parts and hardware. Failure to use genuine replacement parts can cause a risk to users, keep the machine from operating correctly and void the warranty.
- Be sure that all warning stickers and instructional placards applied to the product stay present and in good condition when doing maintenance or replacing components. If necessary request replacement warning stickers or placards from Nautilus customer service.
- Do not try to change the design or functionality of the machine being serviced as this can adversely affect user safety.
- Do not use the machine until all shrouds, instructions, warning labels and correct functionality have been verified and tested for correct performance.

### Tools Required (not included)

Pedal wrench



15 mm Wrench  
10 mm Wrench



#2 Phillips screwdriver



15 mm Socket and  
Wrench



Flathead screwdriver



Tape or marking pen

Crank puller

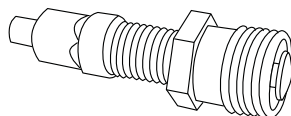



**NOTICE:** At the end of this procedure, make sure that the Drive Chain tension is correct. Refer to the “Adjust the Chain Tension” procedure.



Disconnect the data cable from the console before you service this machine.

**Note:** Your machine may not match the image. For reference only.

1. Loosen and remove the Pedals. Set them safely aside for reassembly.

**Note: The Left Pedal is reverse-threaded.**

Orientation is based from a seated position on the bike. The Left Pedal has an “L”, the Right Pedal an “R”.

2. Carefully remove the Chain Guard Door (1), and set it safely aside for reassembly.

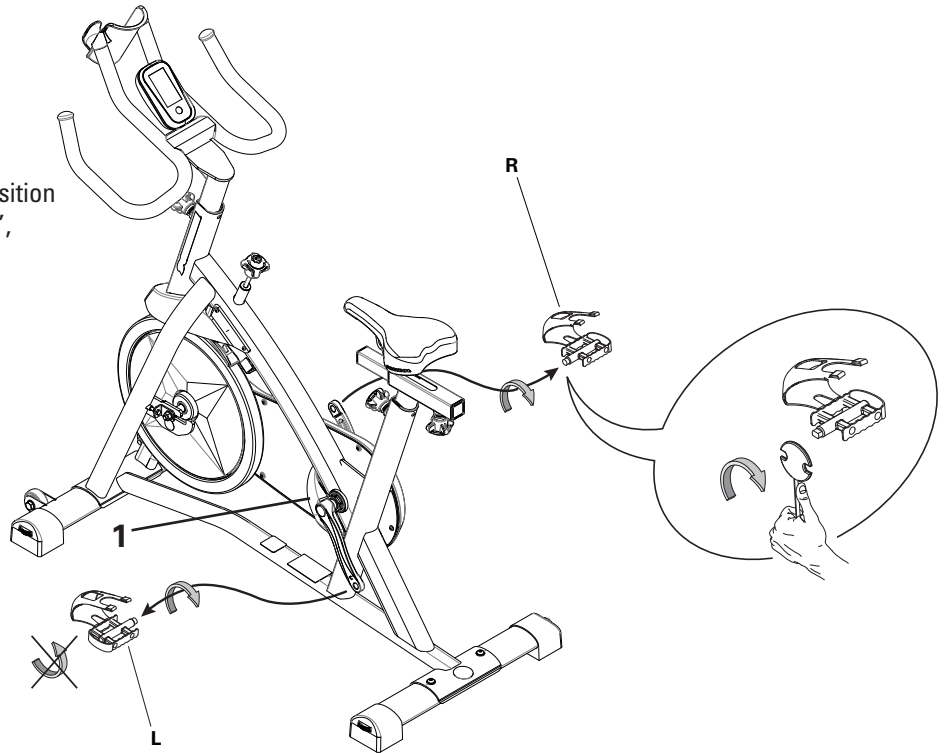

3. Carefully remove the Chain Guard Center from the Chain Guard Cover, and set it safely aside for reassembly.

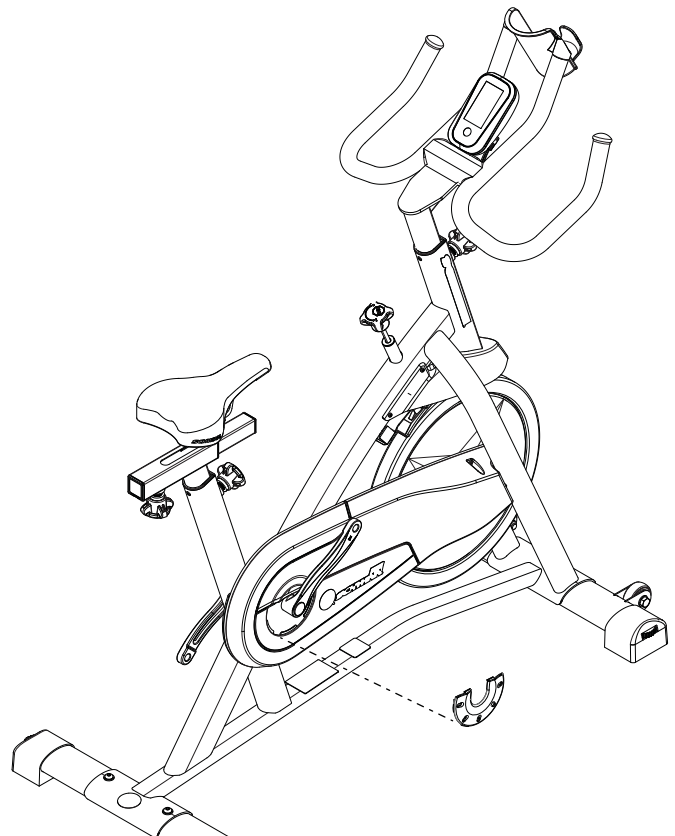

4. Loosen and remove the hardware that attaches the Chain Guard Cover to the Chain Guard Inside. Carefully remove the Chain Guard Cover and set it safely aside for reassembly.

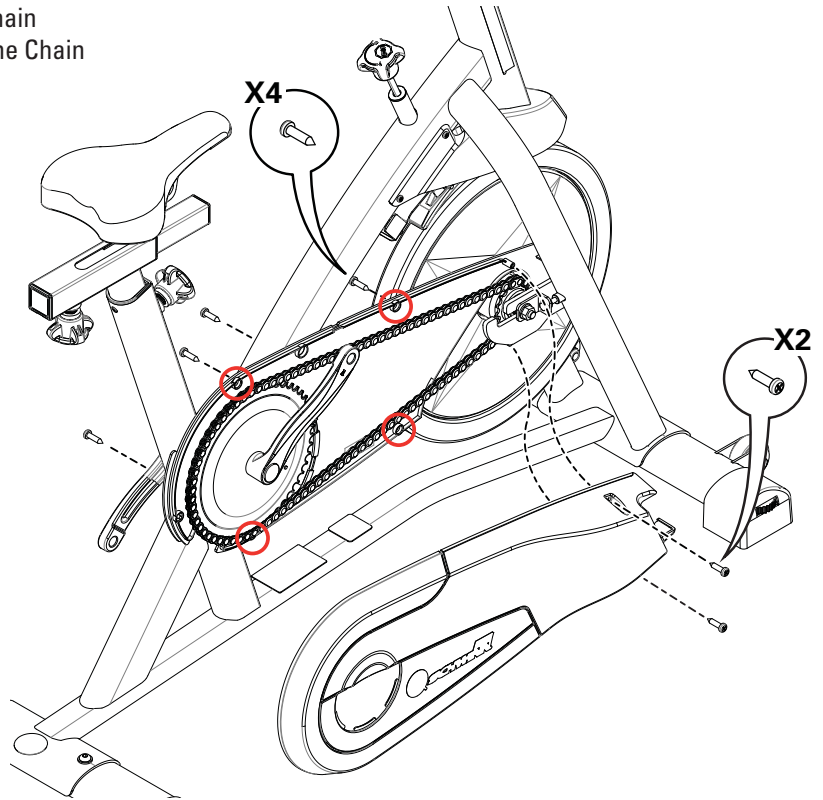

5. Disconnect the Speed Sensor cable (S1) from the data cable (S2) in the Frame.

*NOTICE:* Do not crimp the cable.

6. Remove the hardware (S3) that attaches the Speed Sensor (S4) to the Main Frame. Remove the Speed Sensor. Set the Speed Sensor and hardware safely aside for reassembly.

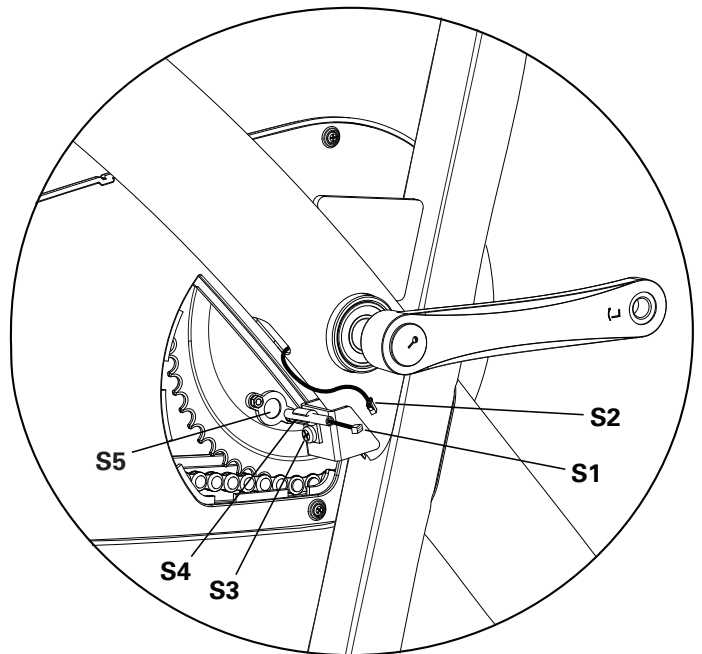

**7.** Loosen and remove the hardware that attaches the Chain Guard Inside to the Main Frame. Set the hardware safely aside.

**8.** Carefully lift and slide the Chain Guard Inside forward to disengage from the axles, then move it toward the rear of the bike. Remove the Chain Guard Inside and set it safely aside for reassembly.

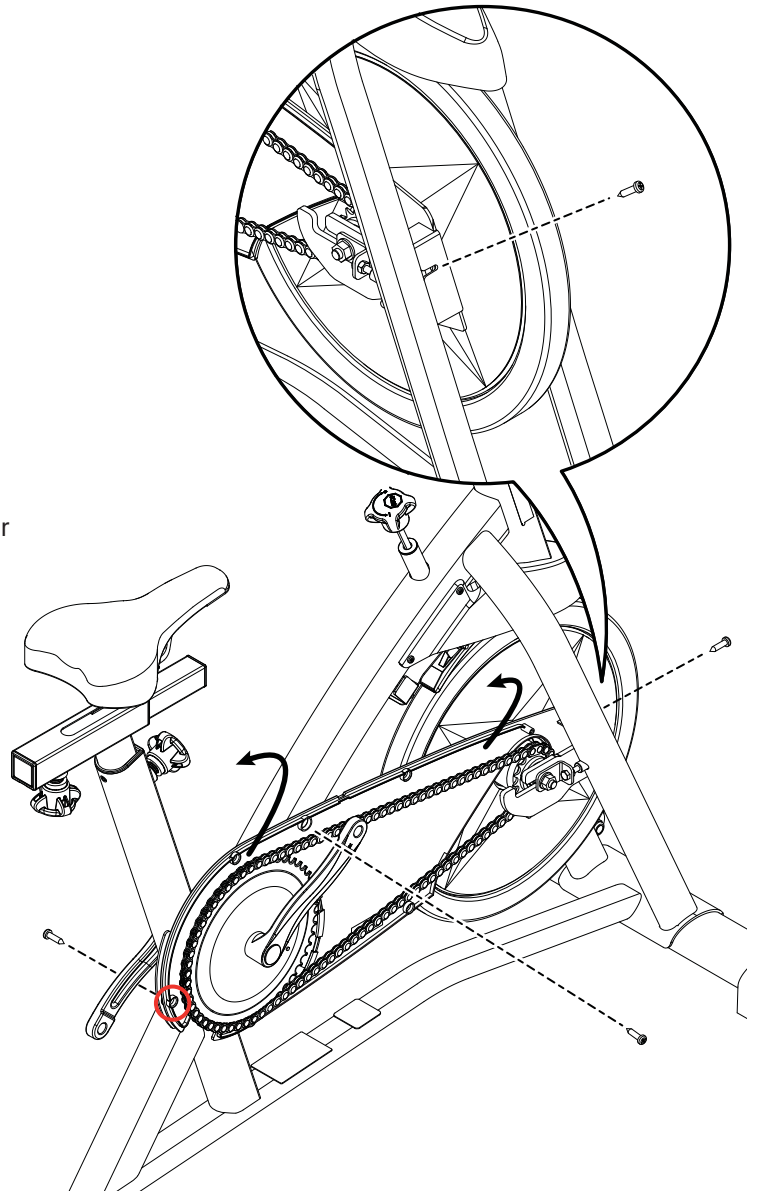

**9.** Mark the position of the Flywheel Retainer Clips (A) on the flywheel brackets (B) on the Frame. Record the number of threads showing on the Hex Head Bolt (C) that attaches each Flywheel Retainer Clip to the Frame.

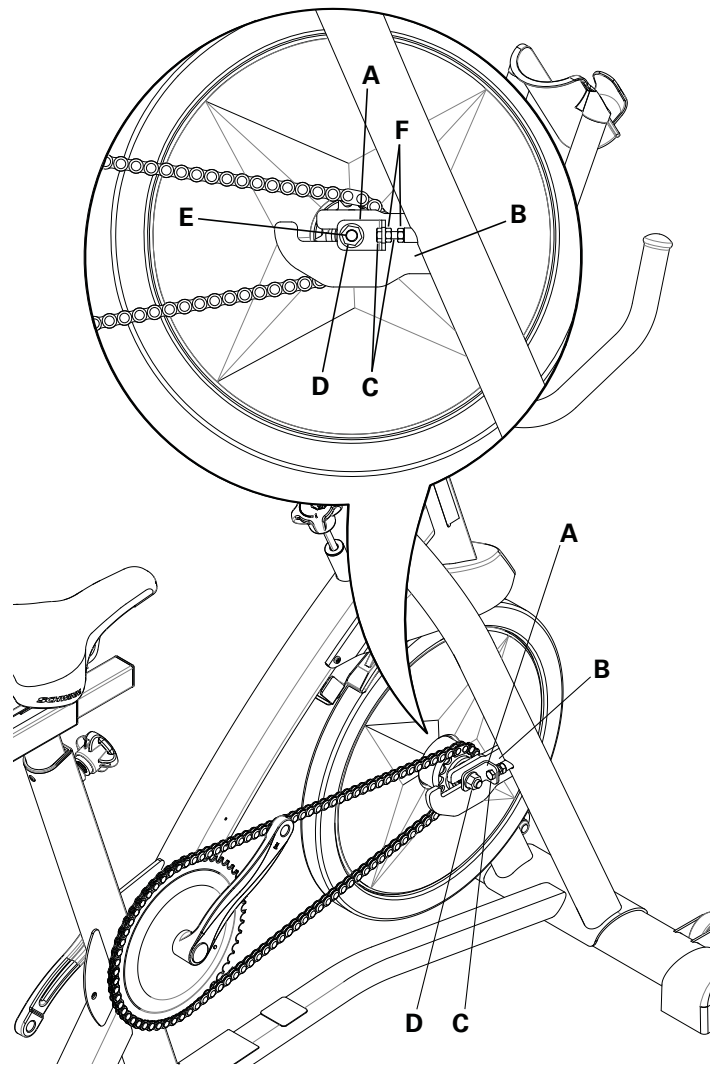

**10.** To loosen the Flywheel hardware, use a 15 mm crescent wrench to hold the Axle Nut (D) on one side steady and loosen the Axle Nut on the opposite side with a 15 mm socket and wrench. Remove the Axle Nut from the Flywheel axle (E). Set the hardware safely aside for reassembly.

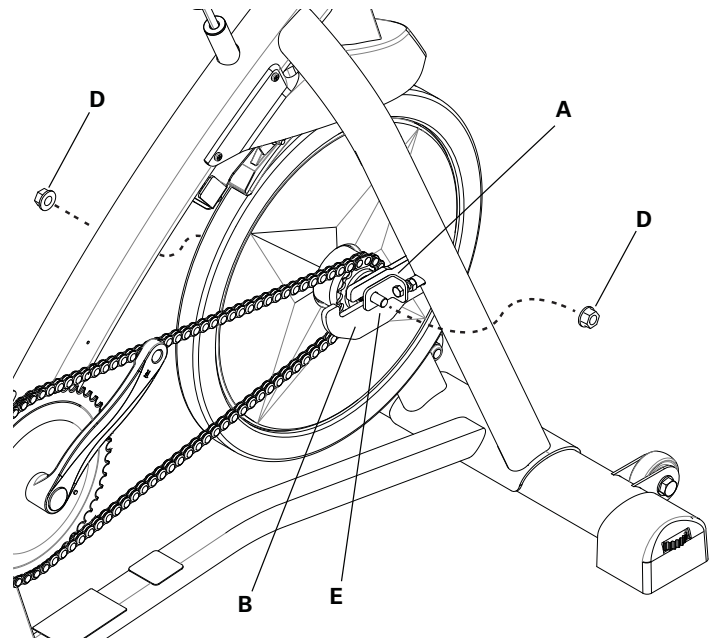

**11.** Loosen the Hex Head Bolt (C) that attaches each Flywheel Retainer Clip (A) to the Frame. Remove the Hex Head Bolts, Flywheel Retainer Clips and Nuts (F) from the Frame. Keep the hardware safely aside for reassembly.

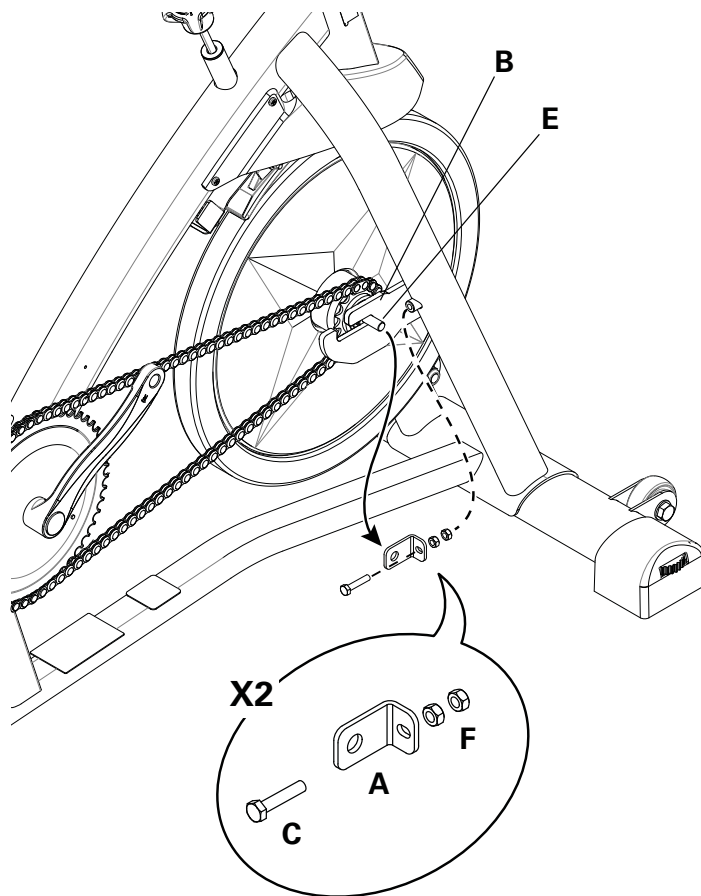

**12.** Carefully move the Flywheel (G) to the opening in the flywheel brackets (B). Carefully lift the Drive Chain (I) off the Flywheel sprockets (J) to the outside.

*NOTICE:* This step may require two people. It may be helpful to remove the Brake Assembly (H) and Brake Cover (L).

**13.** Lift the Drive Chain (I) off the Sprocket Drive (K) to the outside.



Be sure to keep fingers clear of all pinch hazards as you turn the Sprocket Drive and Flywheel.

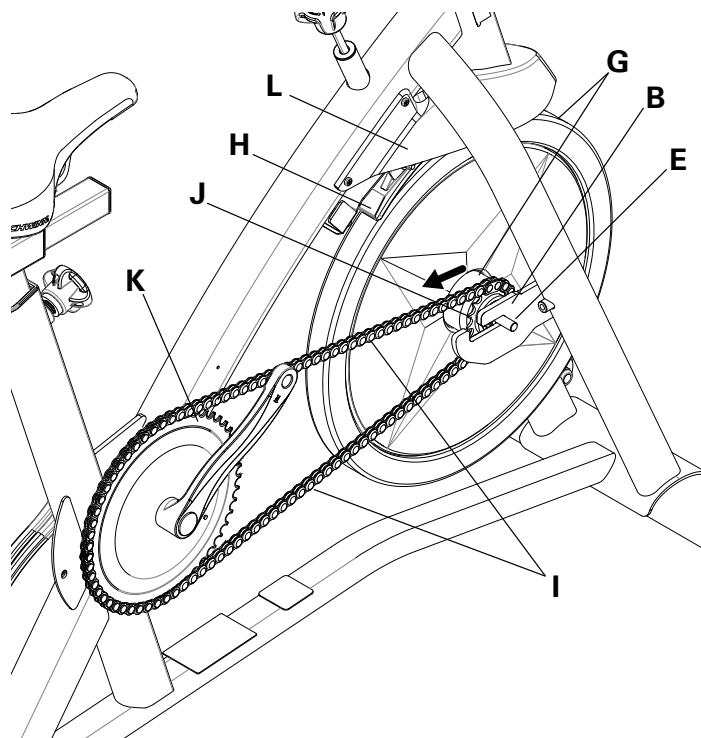

**14.** Using a flathead screwdriver, remove the threaded Cap (L) from the Sprocket Drive/Crank Arm assembly (K).

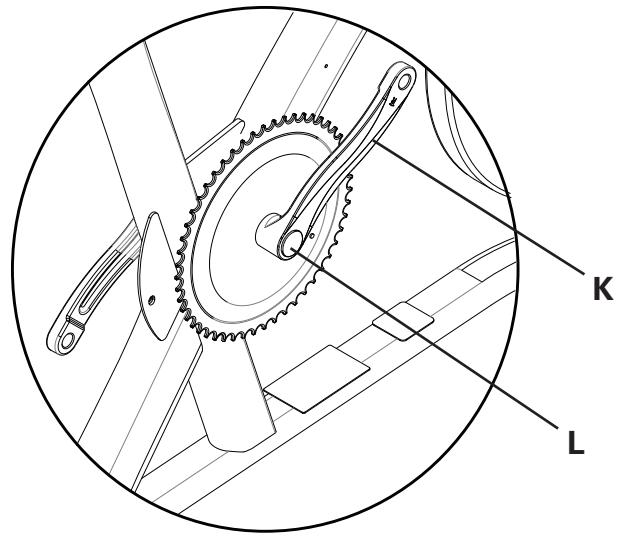

**15.** Using a wrench and socket, remove the Hex Head Bolt (M) under the threaded Cap (L).

**16.** Thread the Crank Puller into the Crank Arm (K). When the Crank Puller is in the correct position, only 1-2 threads on the outer portion (CP2) of the Crank Puller should show.

**Note:** Be sure the end of the Bolt (CP1) of the Crank Puller is flush with the Nut (CP2) as shown, before use.

**17.** Using a wrench, turn the inner portion (CP3) of the Crank Puller clockwise. The Sprocket Drive/Crank Arm assembly (K) will slide off as it is tightened. Discard the old parts.

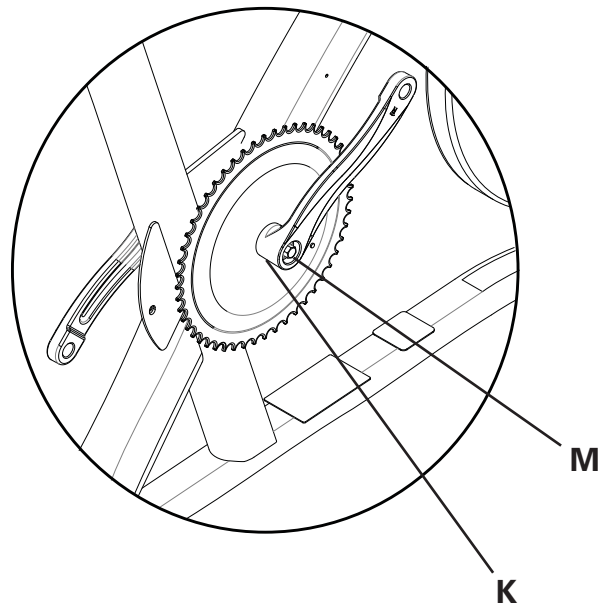

**18.** Installation is the reverse procedure.

**NOTICE:** Install the Flywheel Retainer Clips (A) at the position that you recorded in step 3. Make sure the Flywheel (G) can turn easily.

**NOTICE:** Do not crimp any cables.

**Note:** Before closing the Chain Guard Door, verify that the Speed Sensor (S4) and Speed Sensor Magnet (S5) on the Sprocket Drive (K) do not touch.

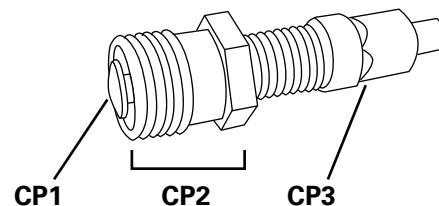

**19.** Make sure that the Drive Chain tension is correct. Refer to the "Adjust the Chain Tension" procedure.

## 20. Final Inspection

Inspect your machine to ensure that all hardware is tight and components are properly assembled.



Do not use until the machine has been fully assembled and inspected for correct performance in accordance with the Owner's Manual.